

DAY 2- NOVICE STATEMENT

Hello, my name is _____. You are located in the fresh air base at the entrance of the 1 left section. The section consists of three entries developed into virgin territory. The entries are numbered 1, 2 and 3 (Left to Right)

A six man crew entered the section to begin work on the section at 5:00 am. Shortly after 7:00 am, the mine foreman attempted to enter the section, but encountered smoke and had to retreat. All attempts to contact the section have been unsuccessful.

The mine is ventilated by an exhaust fan installed on the surface. The fan is on and is attended. The fan cannot be stopped, reversed or stalled. The section is ventilated by using the No. 3 entry as an intake and the No. 1 entry as a return.

Mine maps and written instructions will be provided when you are ready to work.

WRITTEN STATEMENT

Account for the missing miners

Explore the entire mines

Rescue all survivors

DAY TWO – FIELD LAYOUT

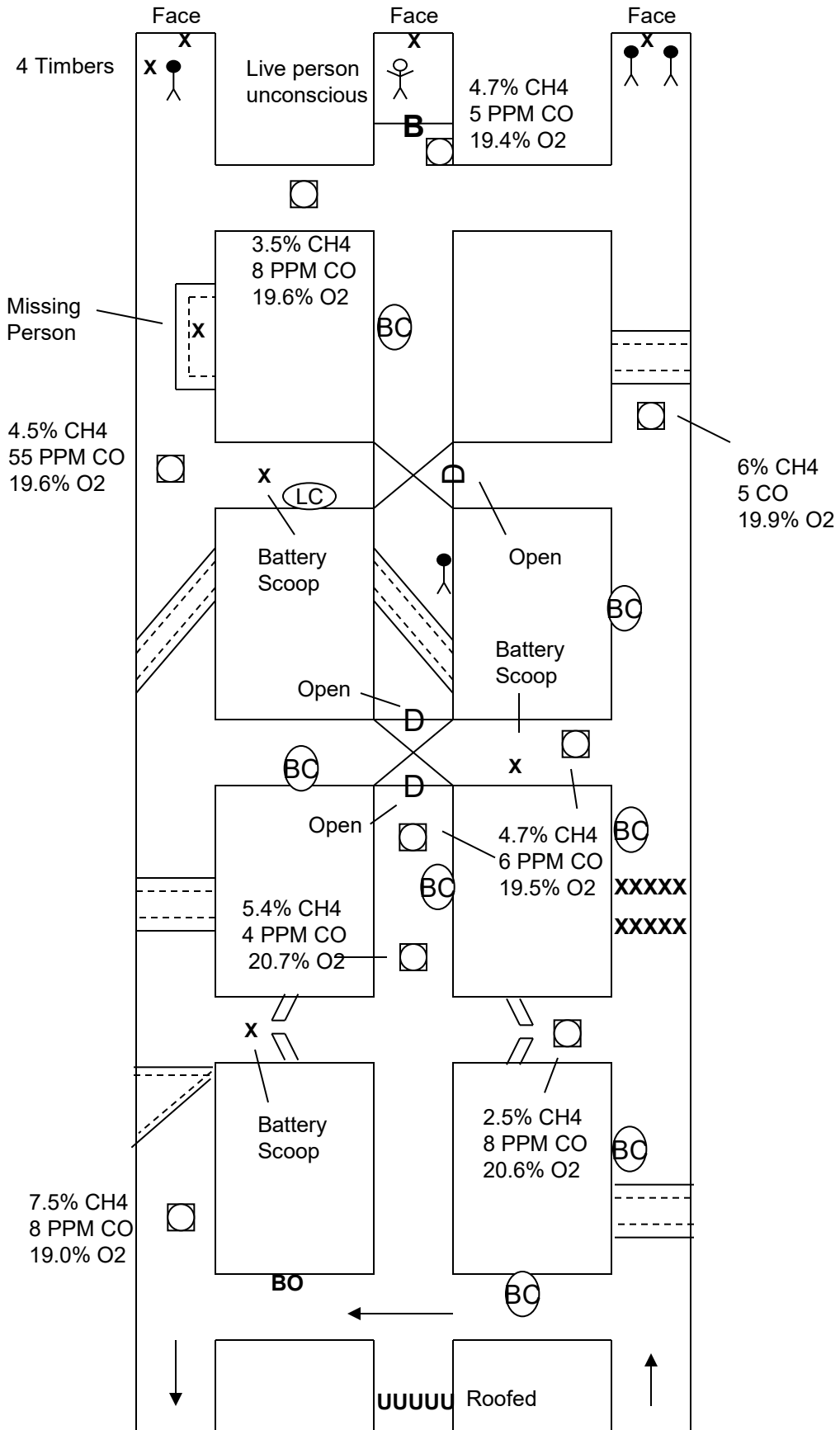

TEAM STOPS

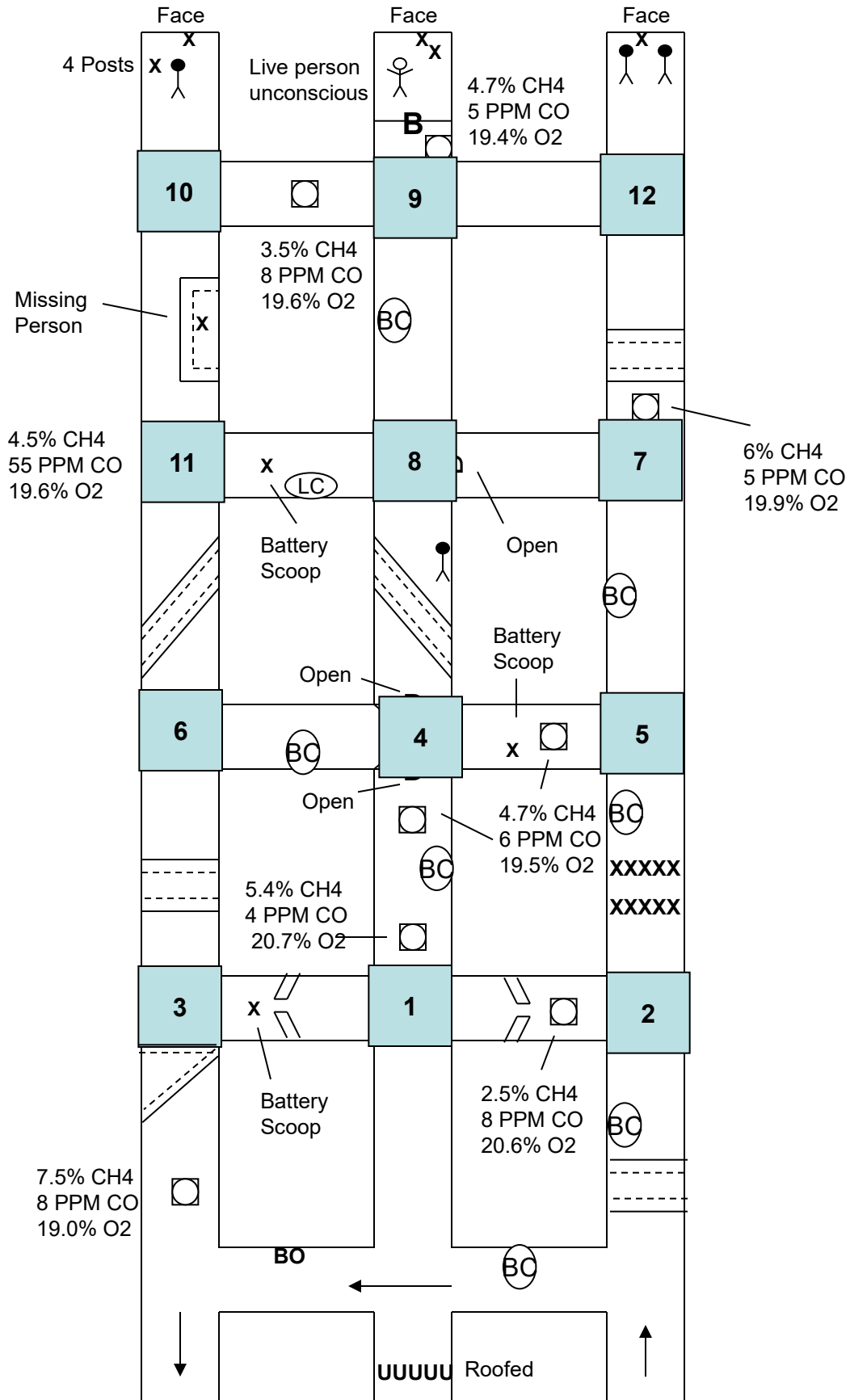

1ST VENTILATION

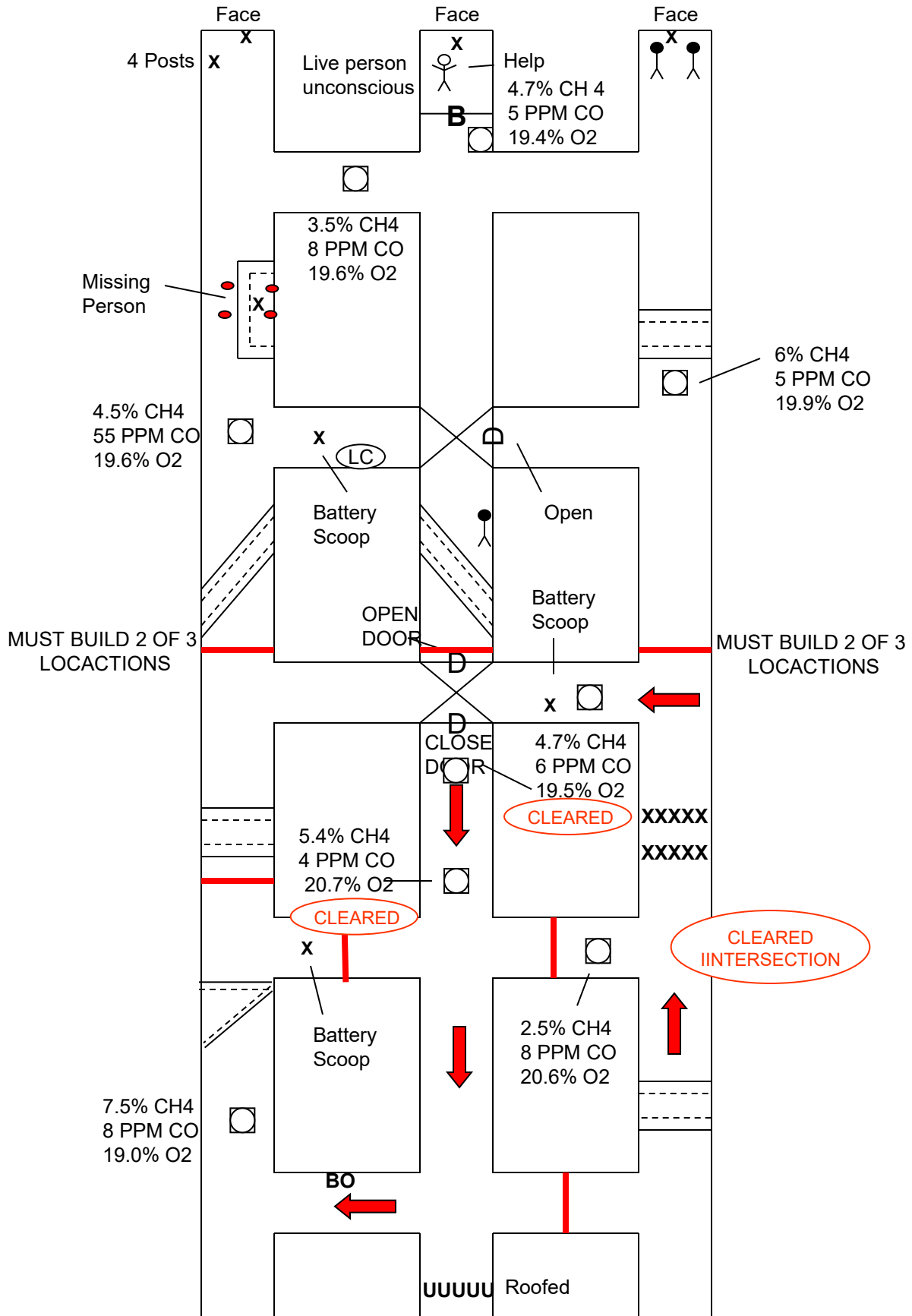

2ND VENTILATION

