

Statement 6.8.2021

- You are located in the FAB
- 3 miners are missing
- The exhaust fan is off
- When the fan is on, the air will come up no.3 entry and the out no. 1 entry
- BO is in crosscut between no. 2 and no. 3 entry in the FAB

Written Instructions:

- Explore the entire mine
- Carry only 2 brattice cloths while traveling
- Exhaust fan is off and cannot be reversed
- Fan can be turned on and off by command center, but never stalled during operation
- Bring all survivors to the FAB

6.8.21 dk

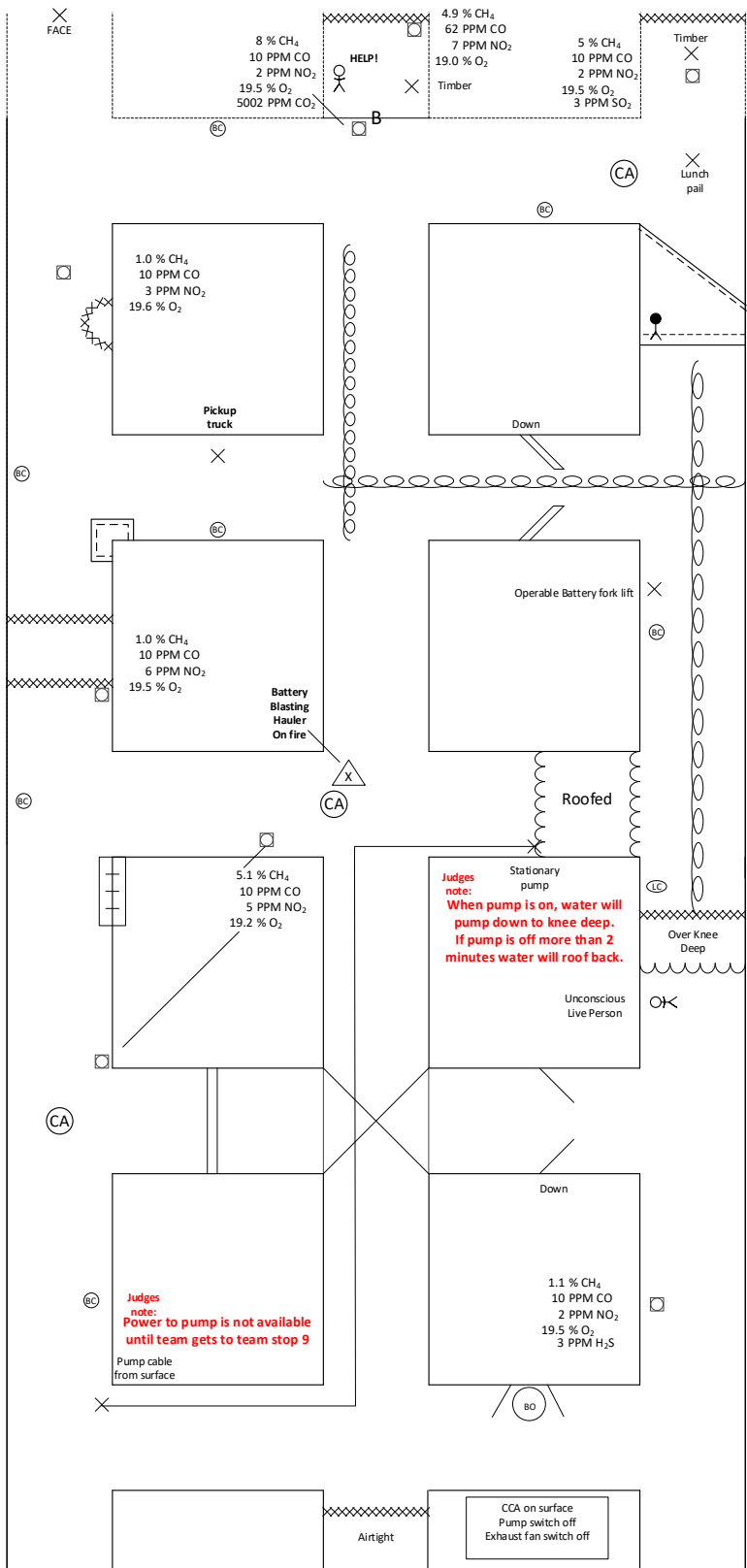

6.8.21 dk

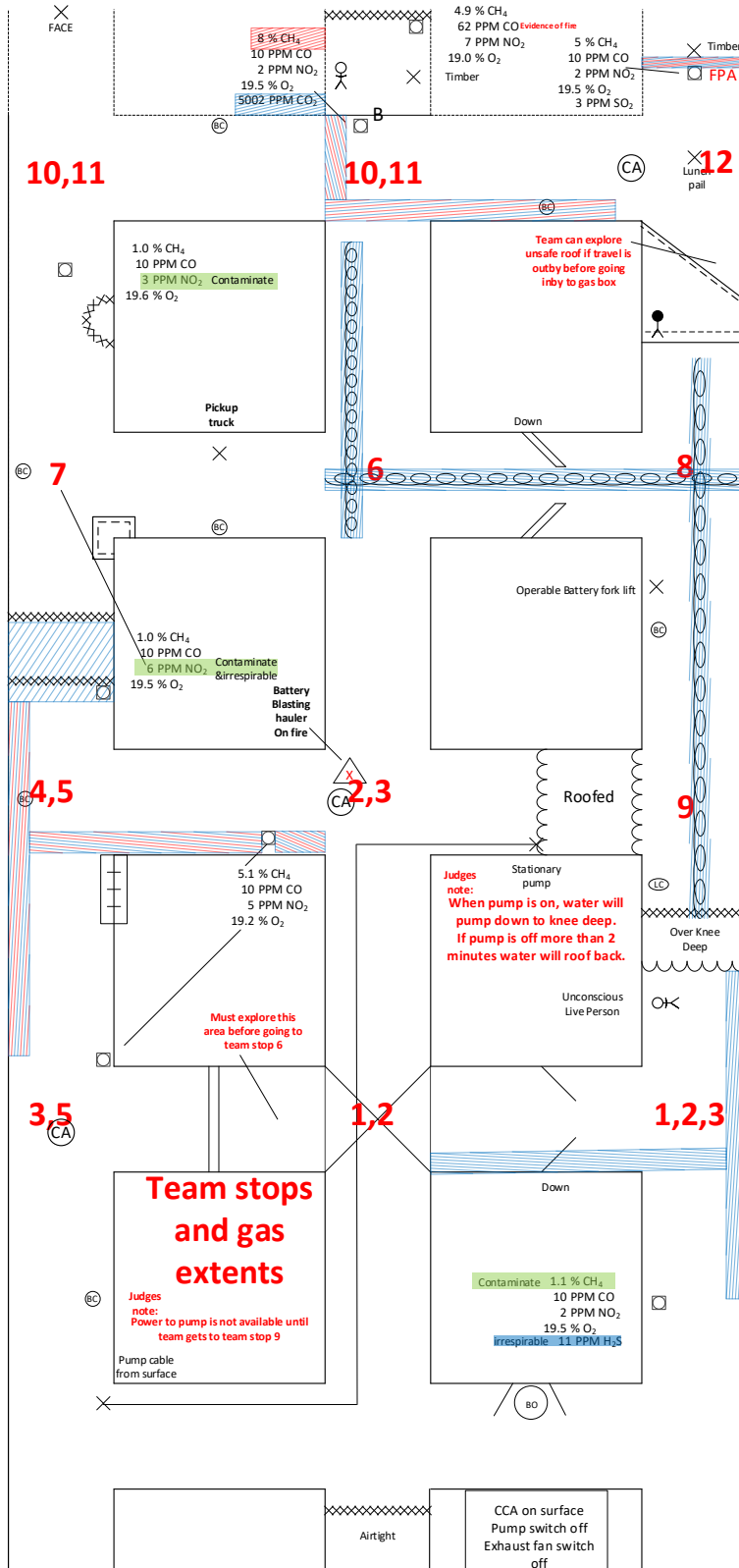

6.8.21 dk

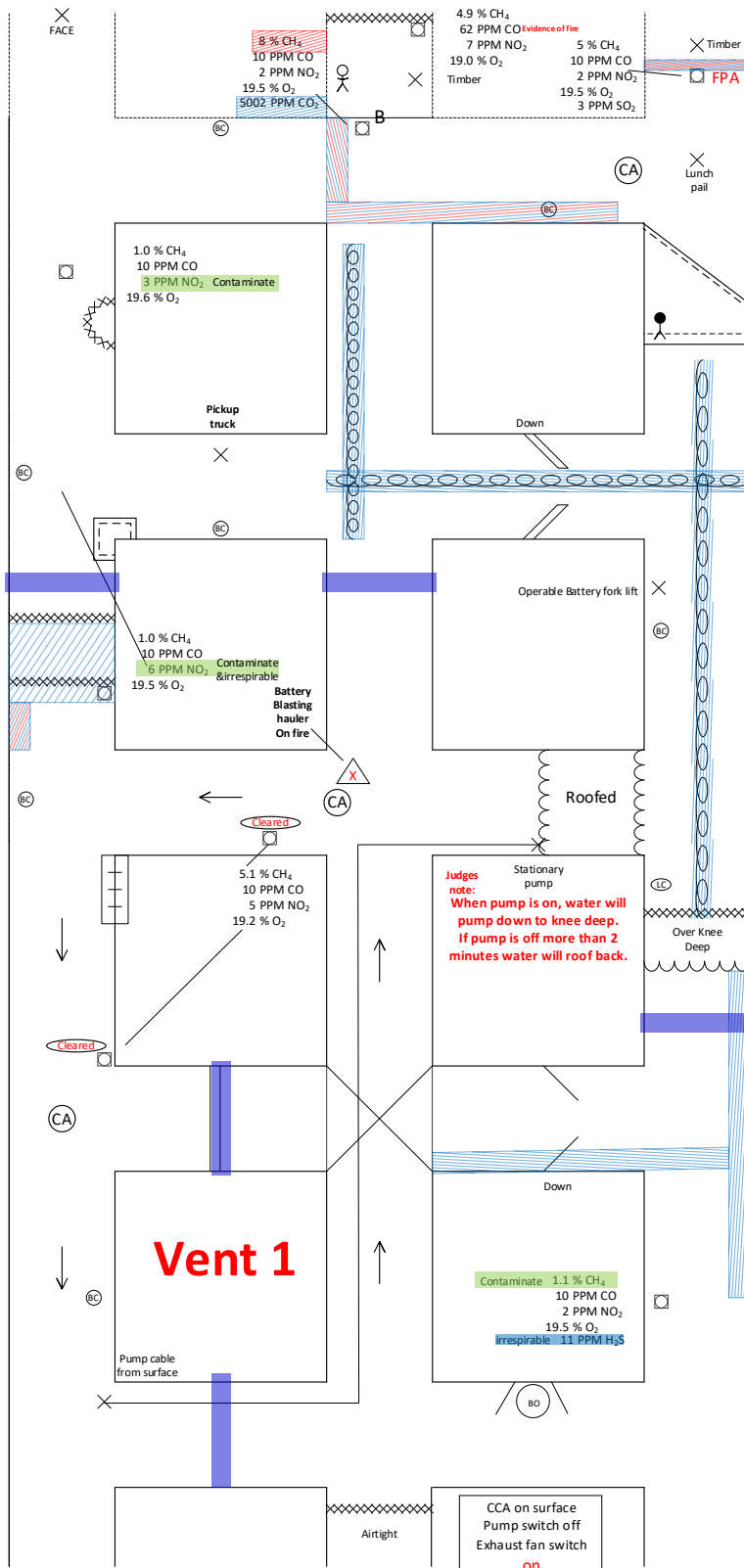

6.8.21 dk

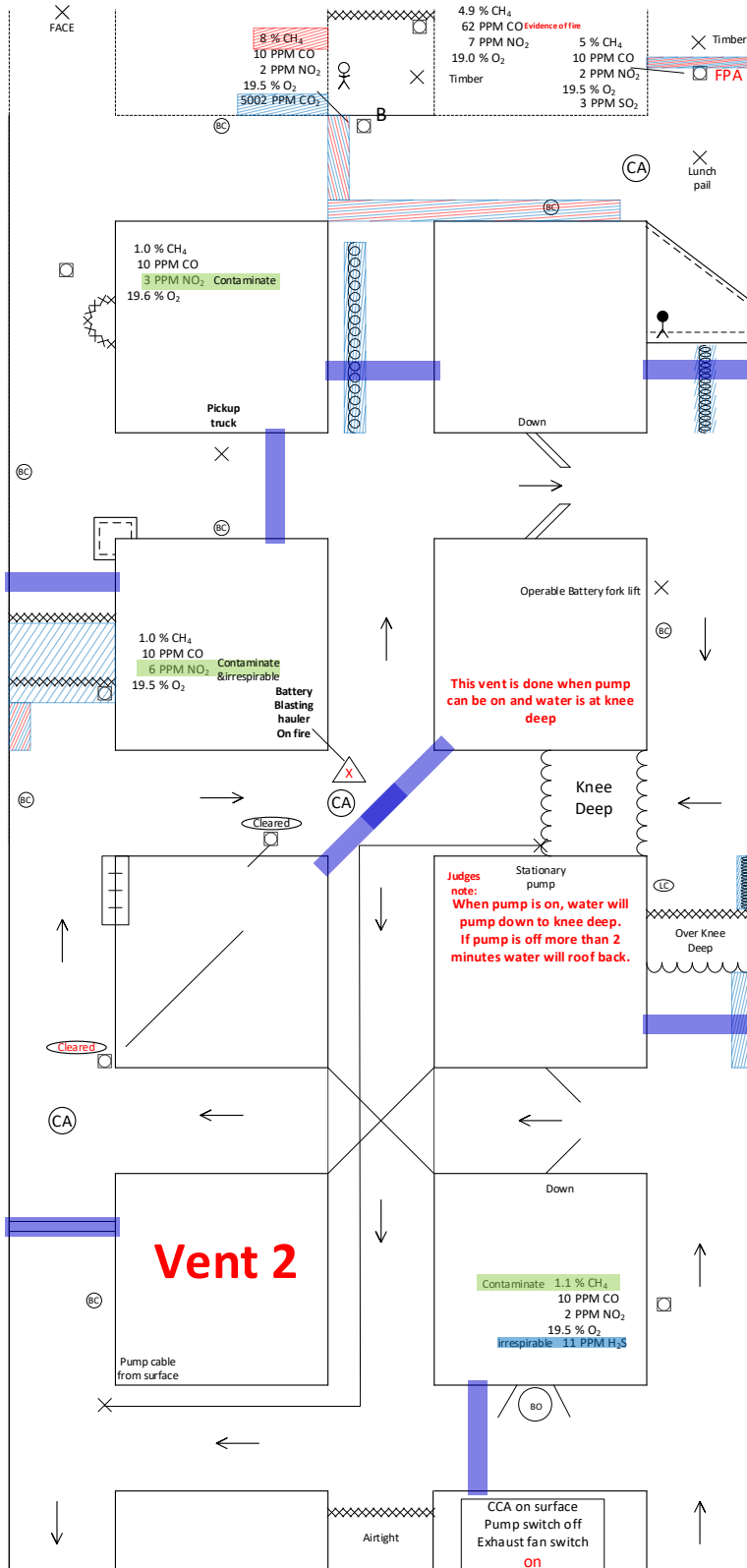

Problem Keys

- Power to pump is not available until team stop 9
- Team must build at least one airlock when pumping the water roofed, even if they have explored on both sides of water roofed
- Team must vent barricade in no.2 entry before going to team stop 12
- Have all builds in place before turning off pump and turning on fan for vent 3 (water will roof in 2 minutes after pump is off)
- Team must not pass gas placard in no.3 entry in by last open crosscut (evidence of fire behind barricade in no. 2 entry ...FPA beside explosive mix gas placard)