

# 2015 B Skills

Mine Rescue Problem

# Mine Rescue Statement 2015 B

- Welcome to The New View # 2 mine. This mine has a history of bad top and water, and the mine is a gassy mine. This morning about 3:00 am, an examiner encountered smoke inby the # 3 entry in our main west panel. He notified management and retreated to the surface. All workers have been evacuated and accounted for except for 4 people. We have had no contact with these people since the smoke was encountered. We have a split shaft with an exhaust fan. There is a man hoist on the intake side of the shaft. The fan is off and guarded at the present time. The fan may be started when needed, but once started the fan cannot be shut off, reversed or stalled. The fresh air base is located on the surface, and the map is up to date. All agencies have been notified and a backup mine rescue team is on the property. The shaft is being monitored.
  - This is all the information I have for you at this time.

# Mine Rescue Problem

- 2015 B Skills Problem

Make the mine in its entirety, where safe to do so. The team will enter and exit the mine by using the man hoist, and there will be a 5 second count going up or down. Account for all missing person, and bring all live persons to the surface.

There will a 60 minute time limit

2015 SIC Skills Map

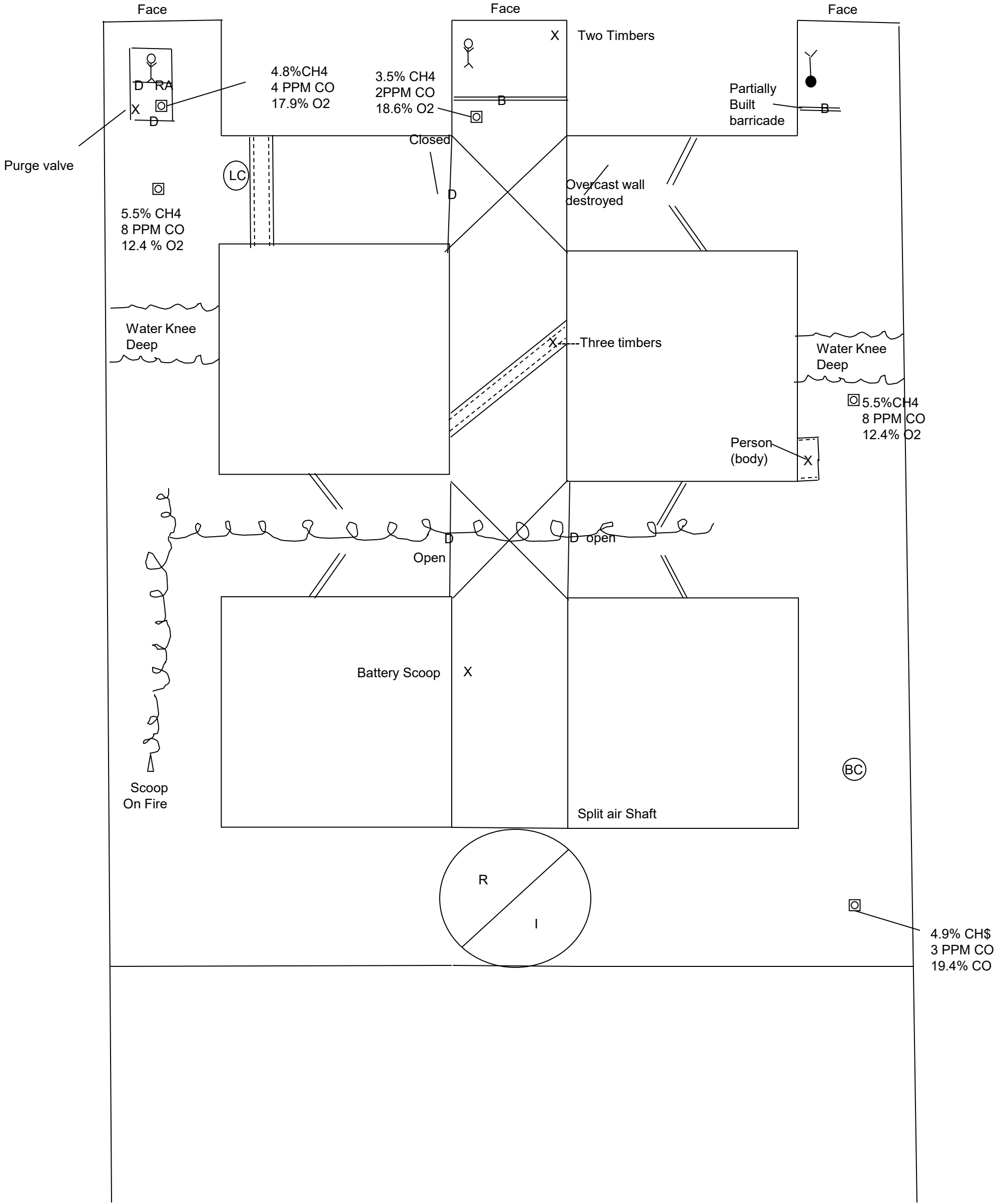

2015 B SIC Skills  
Handout Map

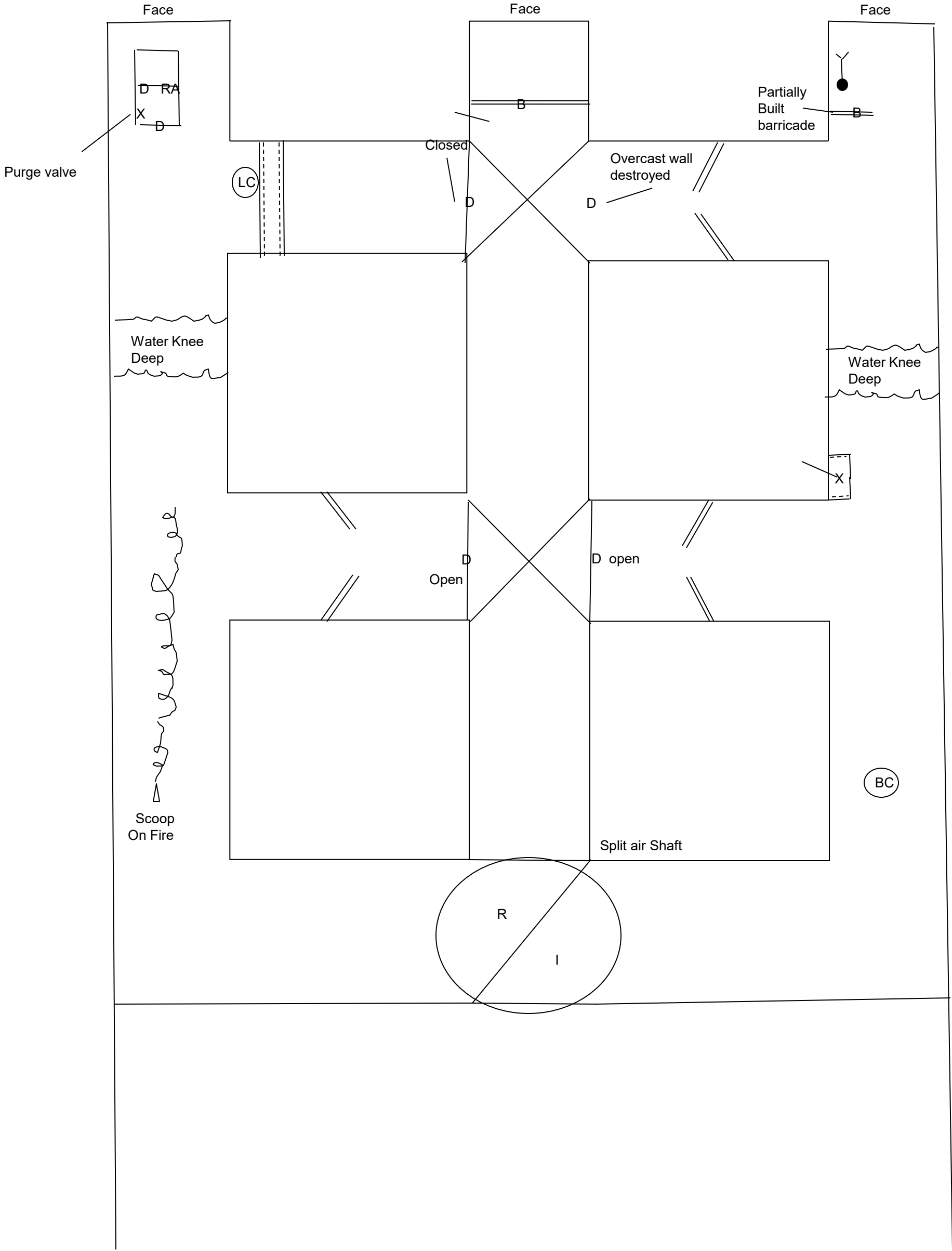

2015 SIC Skills Map

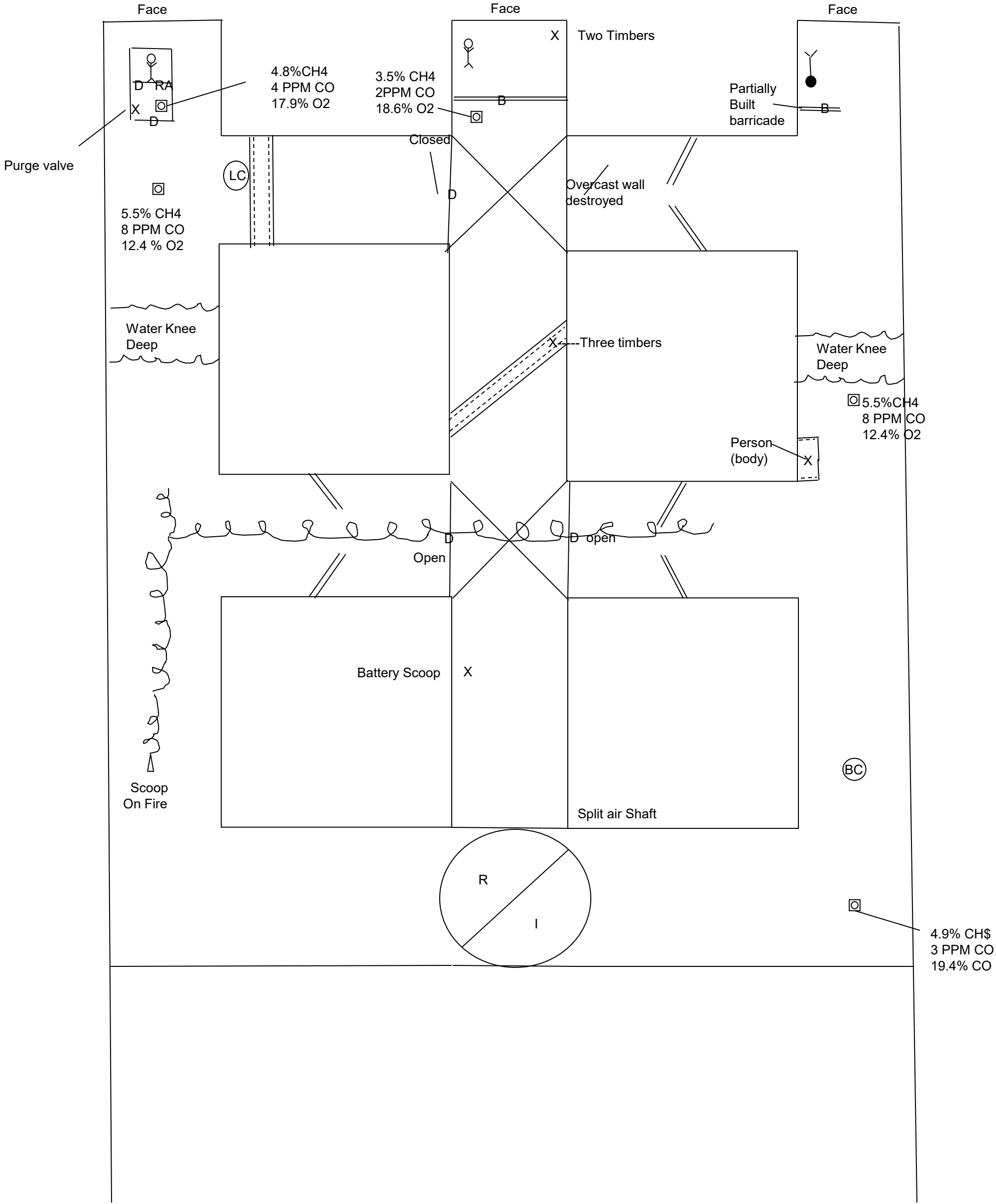

2015 SIC Skills  
Team stop Map

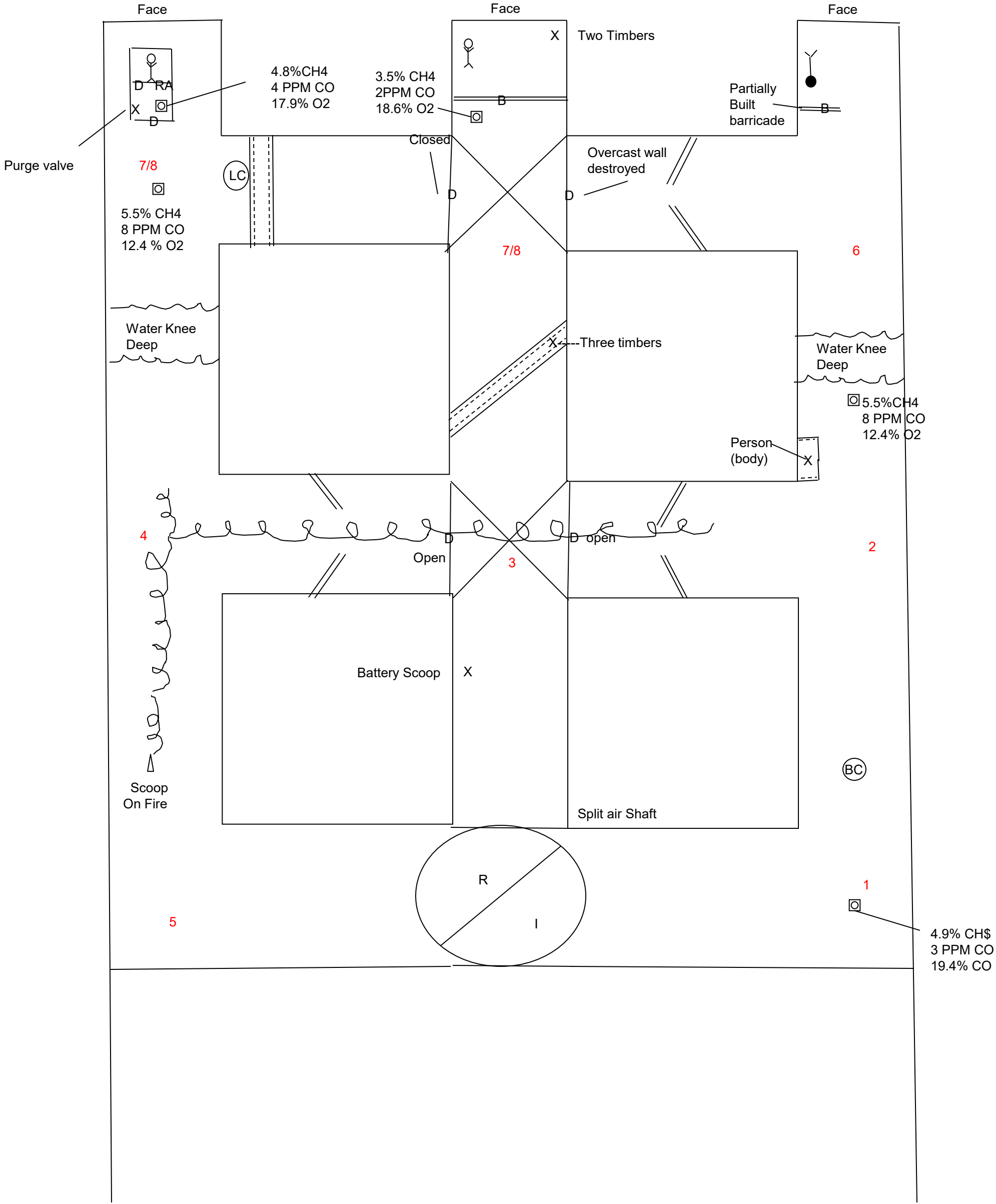



2015 SIC Second Ventilation

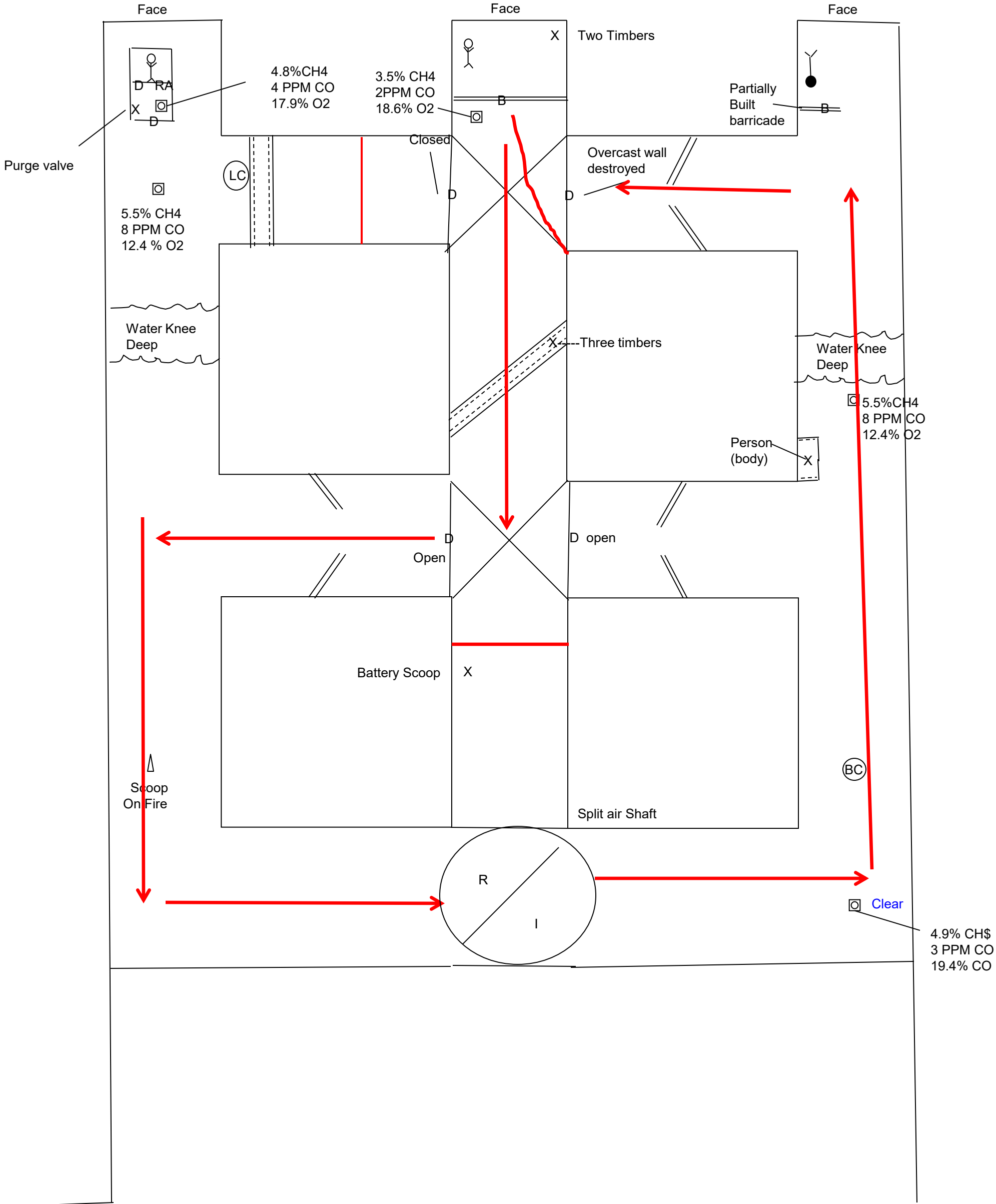

# Patient Statement Barricade in #2

Help get me out

# Patient Statement

RA

Help get me out

2015 B SIC Skills  
Team Map

Face

Face

Face

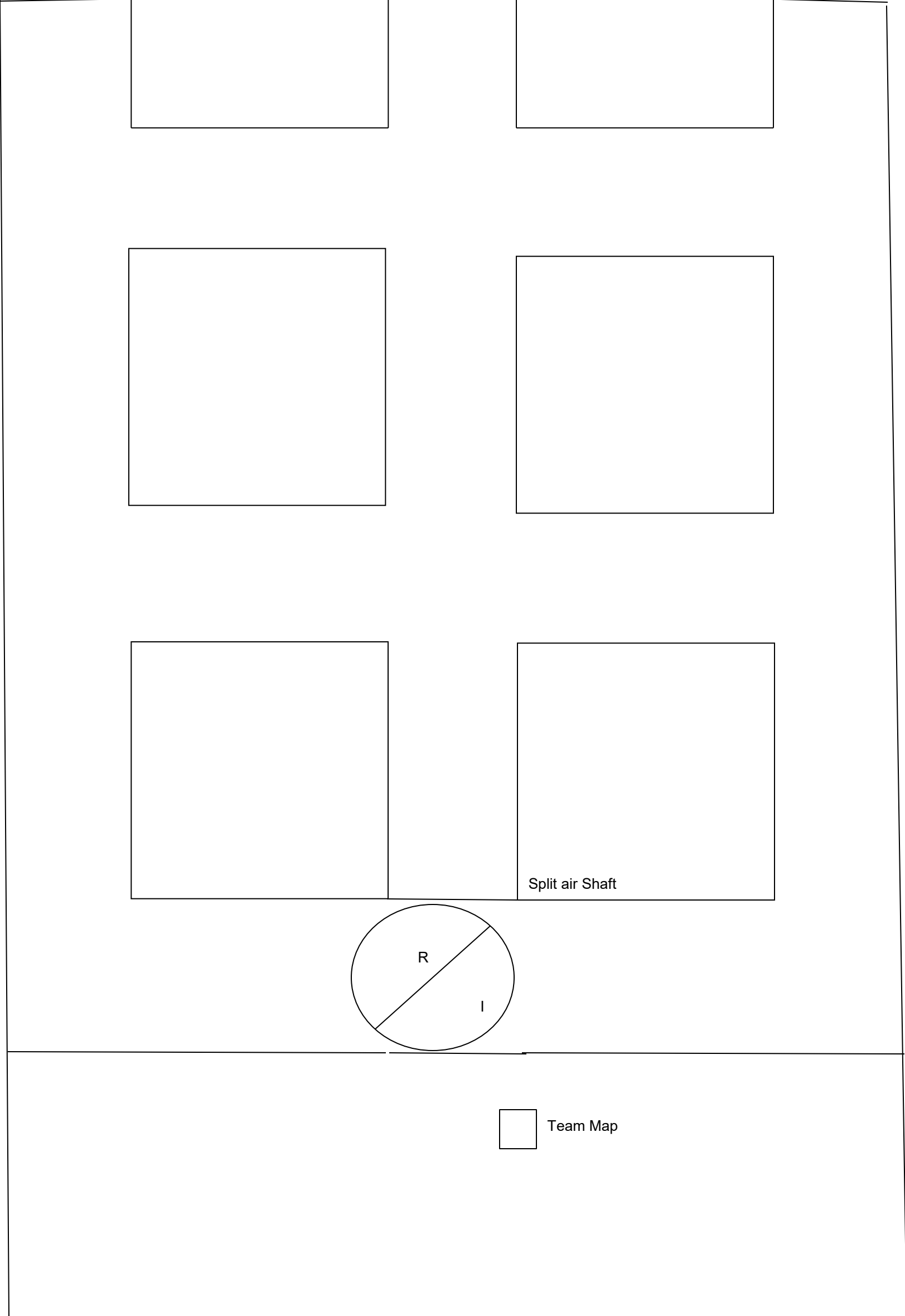

2015 B SIC Skills  
Briefing Officer Map

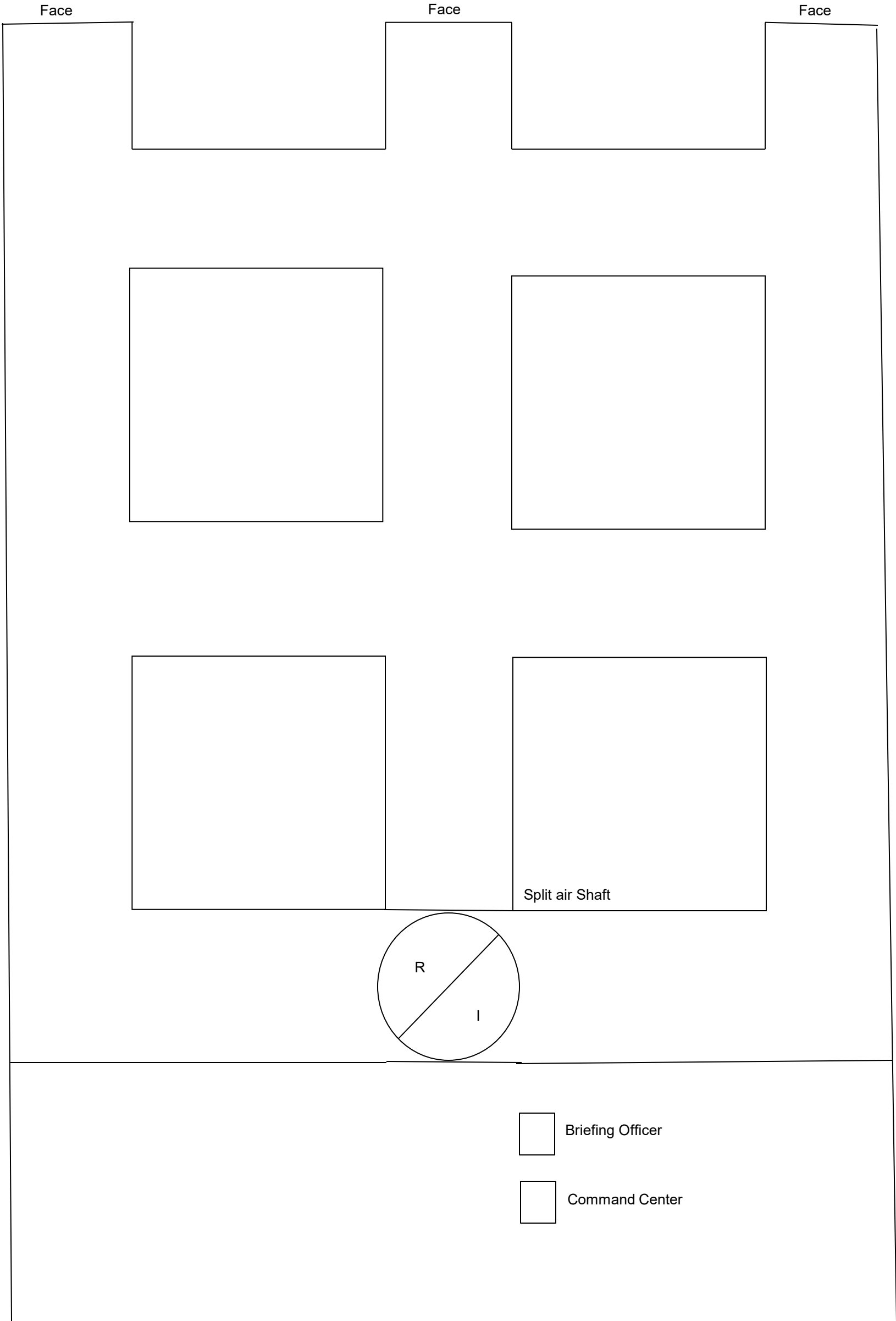

2015 B SIC Skills  
Judges Map

Face

Face

Face

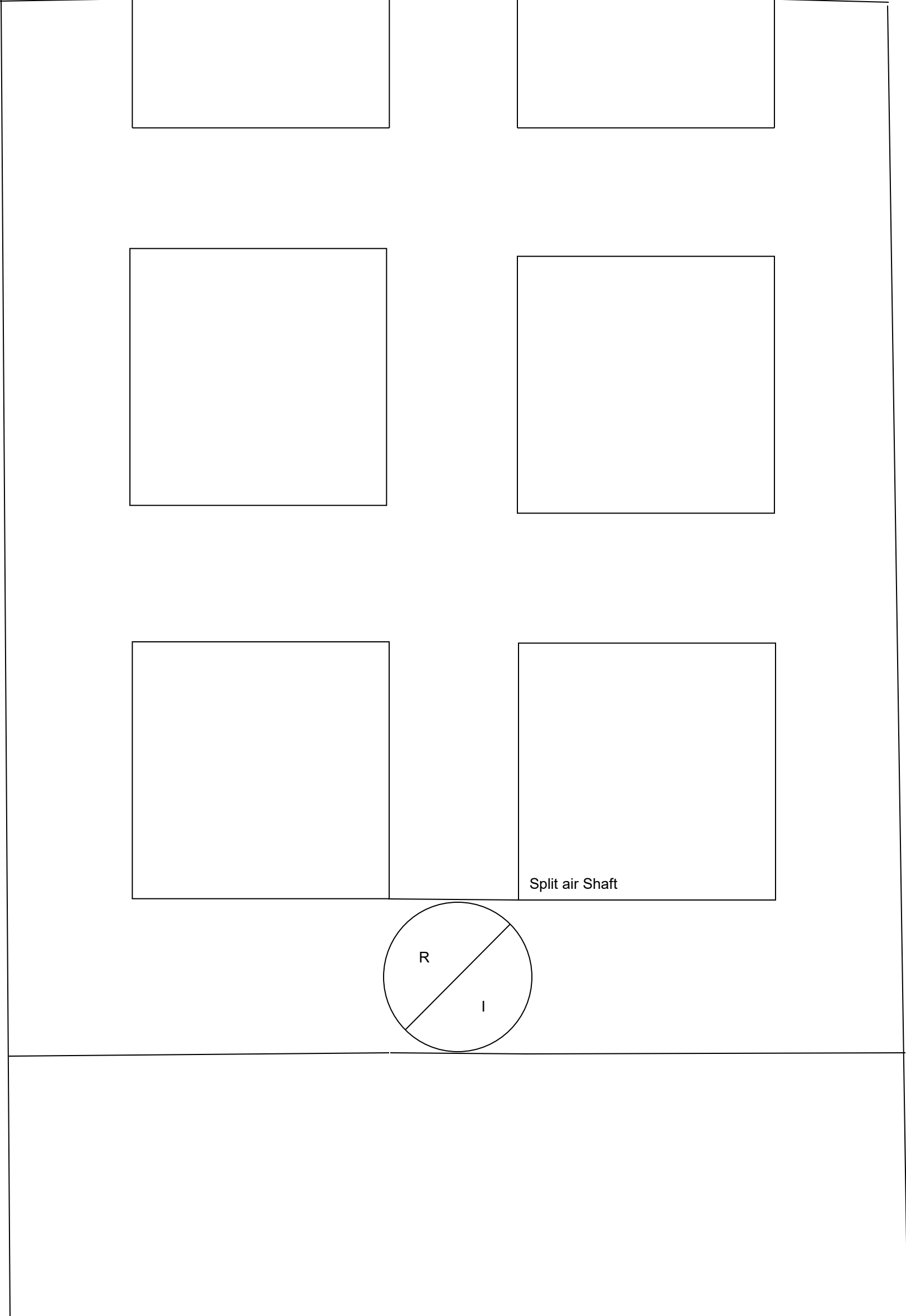

2015 B SIC Skills  
Judges Map

Face

Face

Face

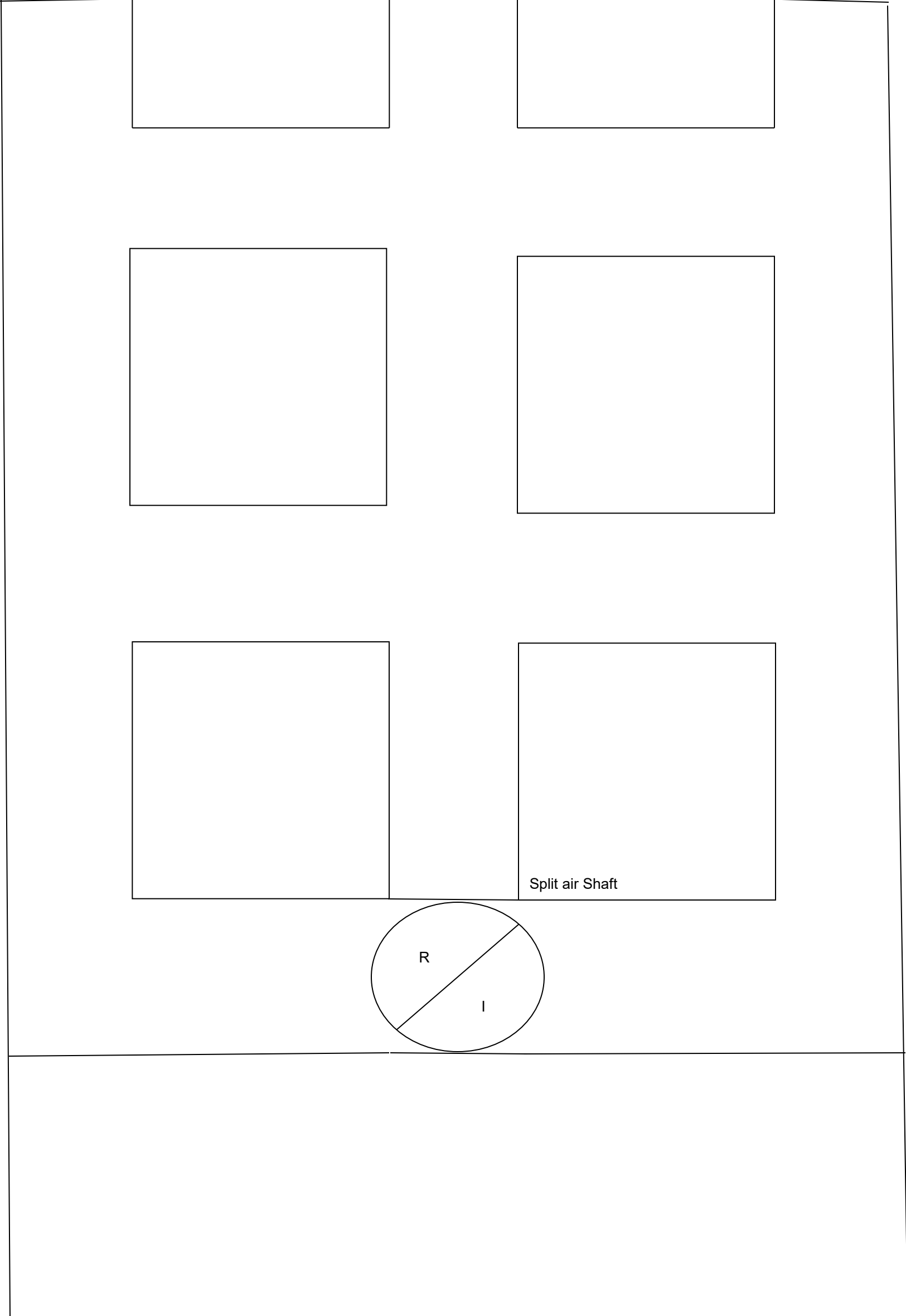

Split air Shaft

R

I