

2015 Post No.5 & West Virginia State Mine Rescue Contest Day 1



Problem Briefing

2015 Post 5 & West Virginia State Mine Rescue Contest Day 1 Statement

You are located on the surface of Blue Ridge # 7 mine. This is a new drift mine that just started production a few months ago. Thanks for answering our call for help.

About 2 hours ago, a foreman and a 3 man crew entered the mine to clean up a rock fall and do some bolting around the new air shaft in the no.2 entry. We heard a large boom a short time after they entered the mine and have not been able to contact the crew since. The blowing fan stop running and we were afraid to go into the mine with it off. The fan has been repaired and can be started by asking the superintendent. The mine has had numerous problems with water, methane and bad roof. The mine liberates about 750,000 CFM of methane every 24 hours and the mine has had several roof falls in the last week.

The power going underground has been locked out and is being guarded. A trained mine rescue team is here to back you up and the mine maps that you will receive once the clock is started are almost up to date. We have been mining very close to an abandon mine, but was told by engineers that we are staying 1000 feet away from any of that mines old workings.

The mine is equipped with the a new communication and tracking system that we hope can be useful to you as you explore. We will let you know if we can give you further information about the last known location of miners as soon as we can.

Please be careful and explore safely !

2015 POST 5 DAY 1

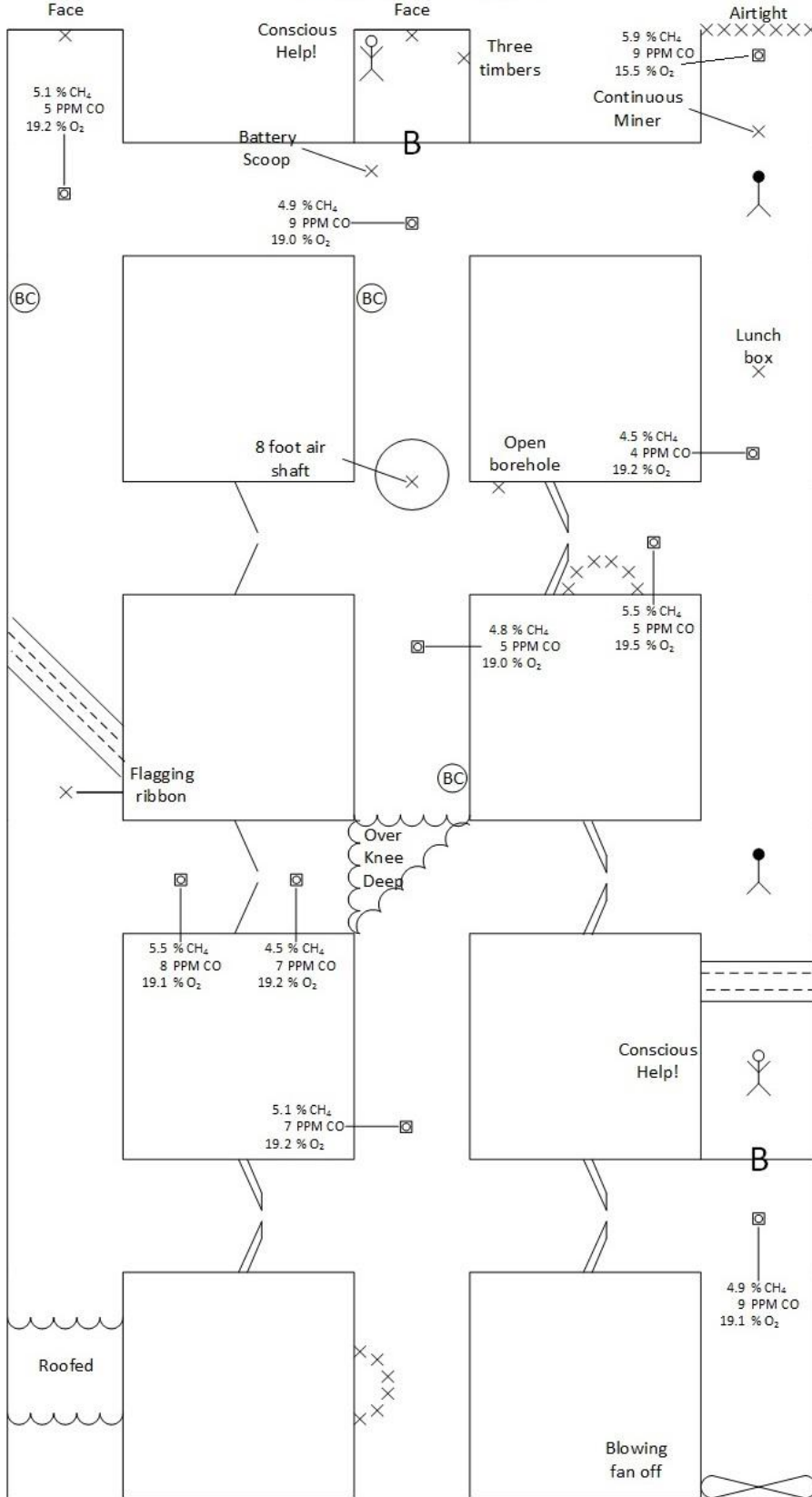

2015
Day 1
Face

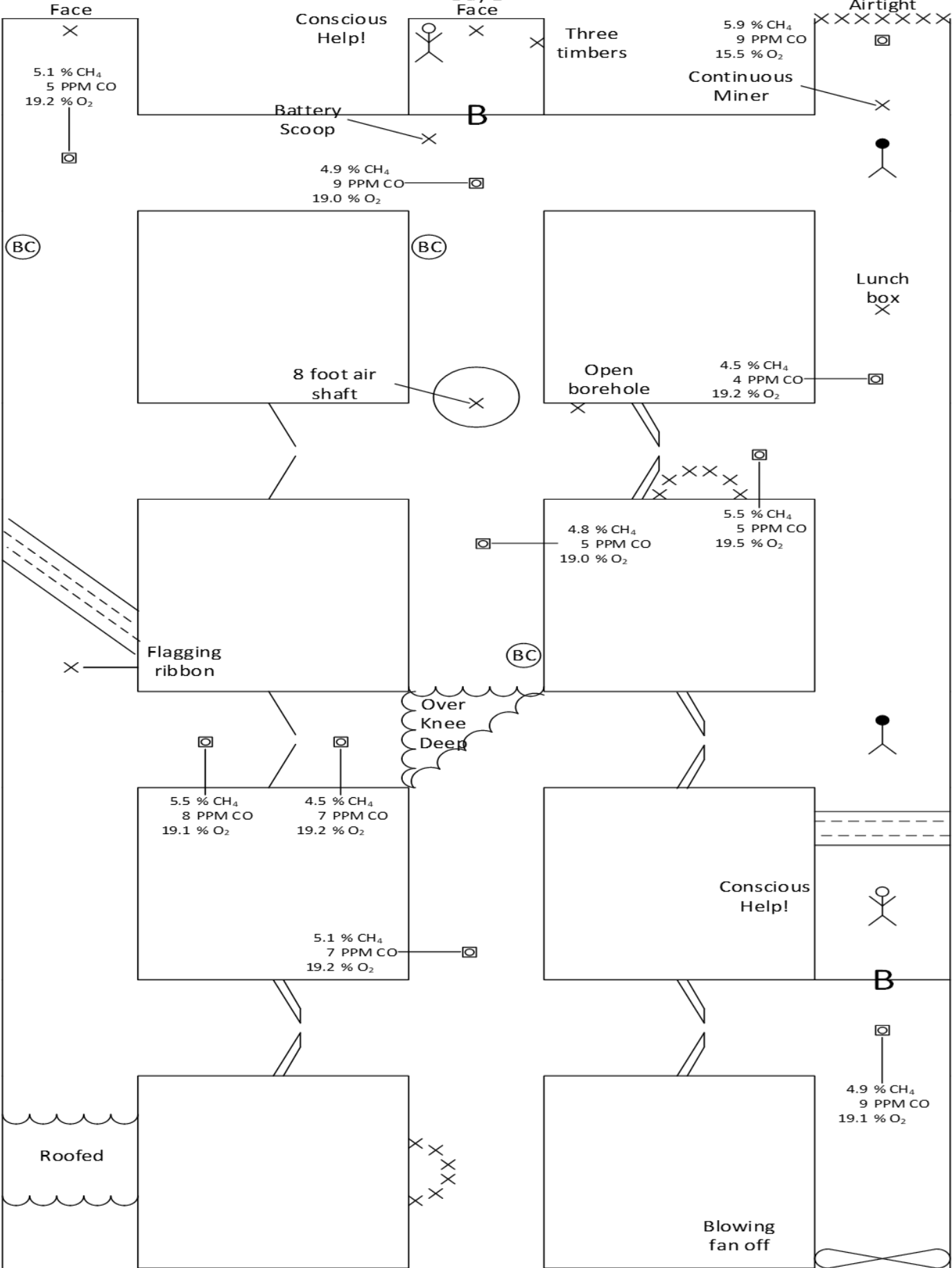

2015 Post 5 Day 1

Problem

(Written Instructions)

- **ACCOUNT FOR THE MISSING MINERS**
- **THE BLOWING FAN CANNOT BE REVERSED**
- **THE BLOWING FAN CANNOT BE STOPPED OR STALLED AFTER STARTING**
- **YOU CANNOT CARRY MORE THAN 3 BRATTICE CLOTH WHILE ADVANCING OR RETREATING**
- **BO/CCA IS OUTSIDE AND ISOLATED**

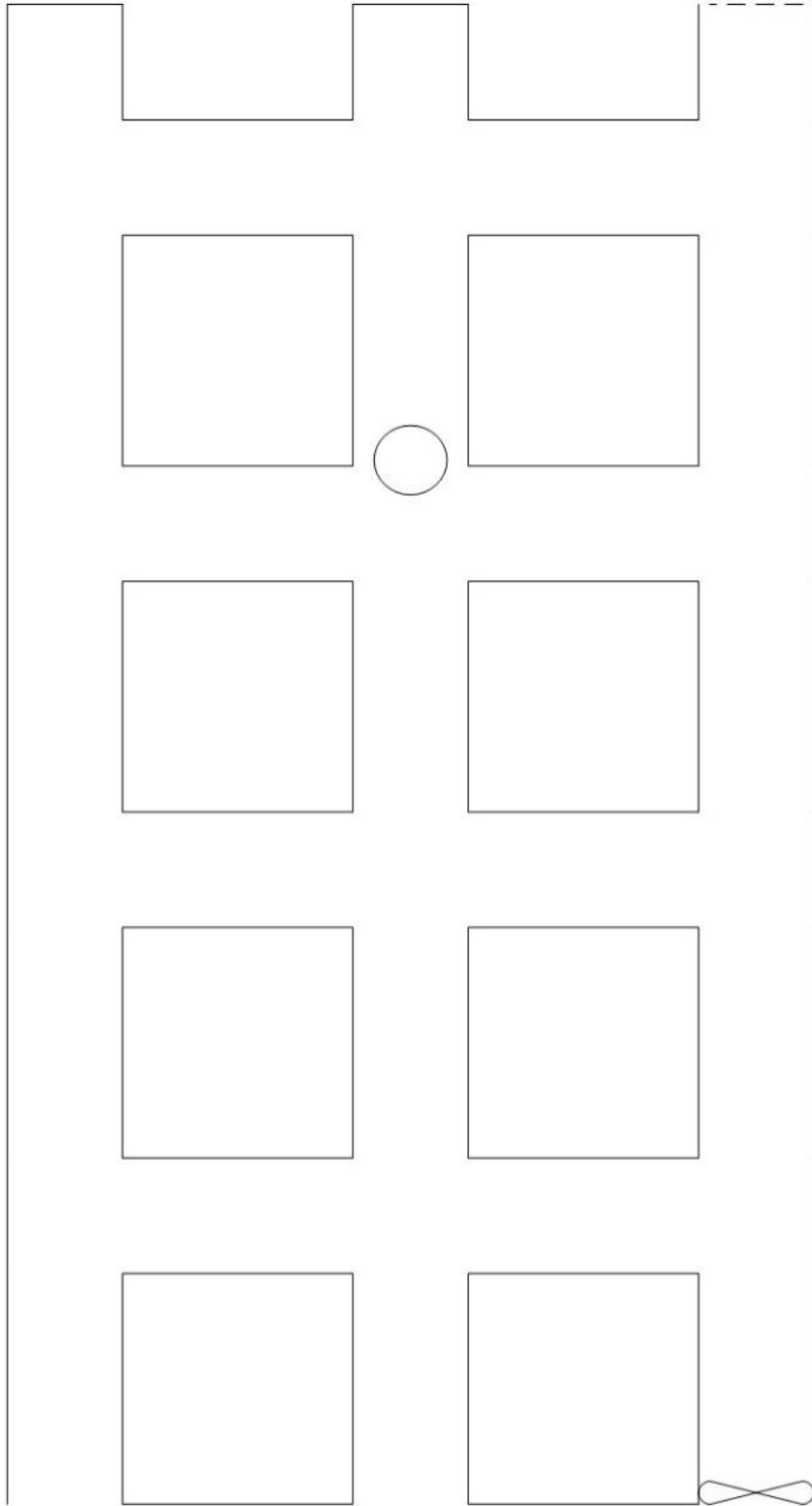

PATIENT STATEMENT IN
BARRICADE IN NO.3 ENTRY
INBY 1ST CROSSCUT

**Help! Get me out of
here!**

PATIENT STATEMENT
IN BARRICADE IN NO. 2
ENTRY LOC

**Help! Get me out of
here!**

2015 POST 5 DAY 1

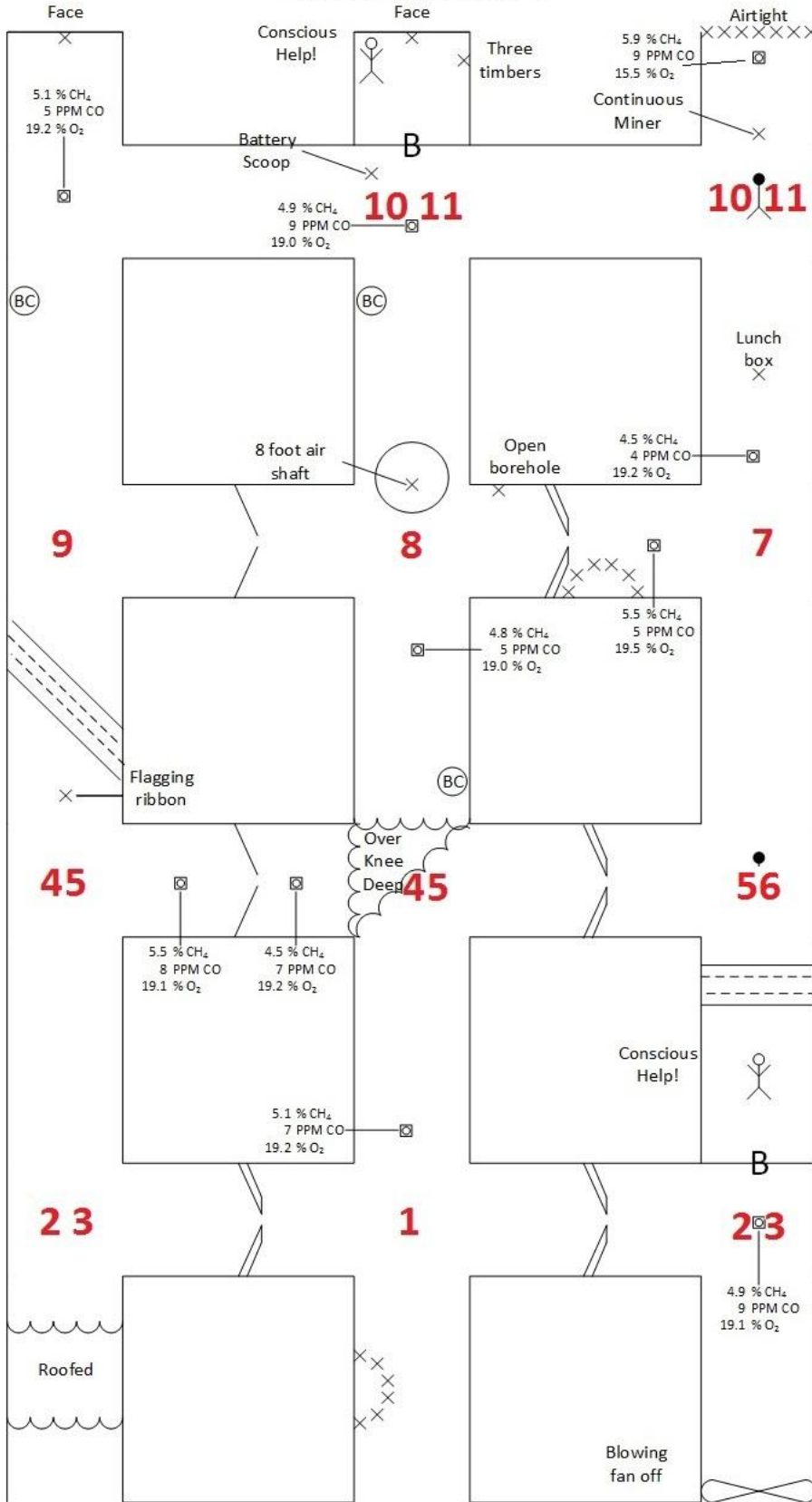

GAS TEST, DATE, INT. ROOF/RIB

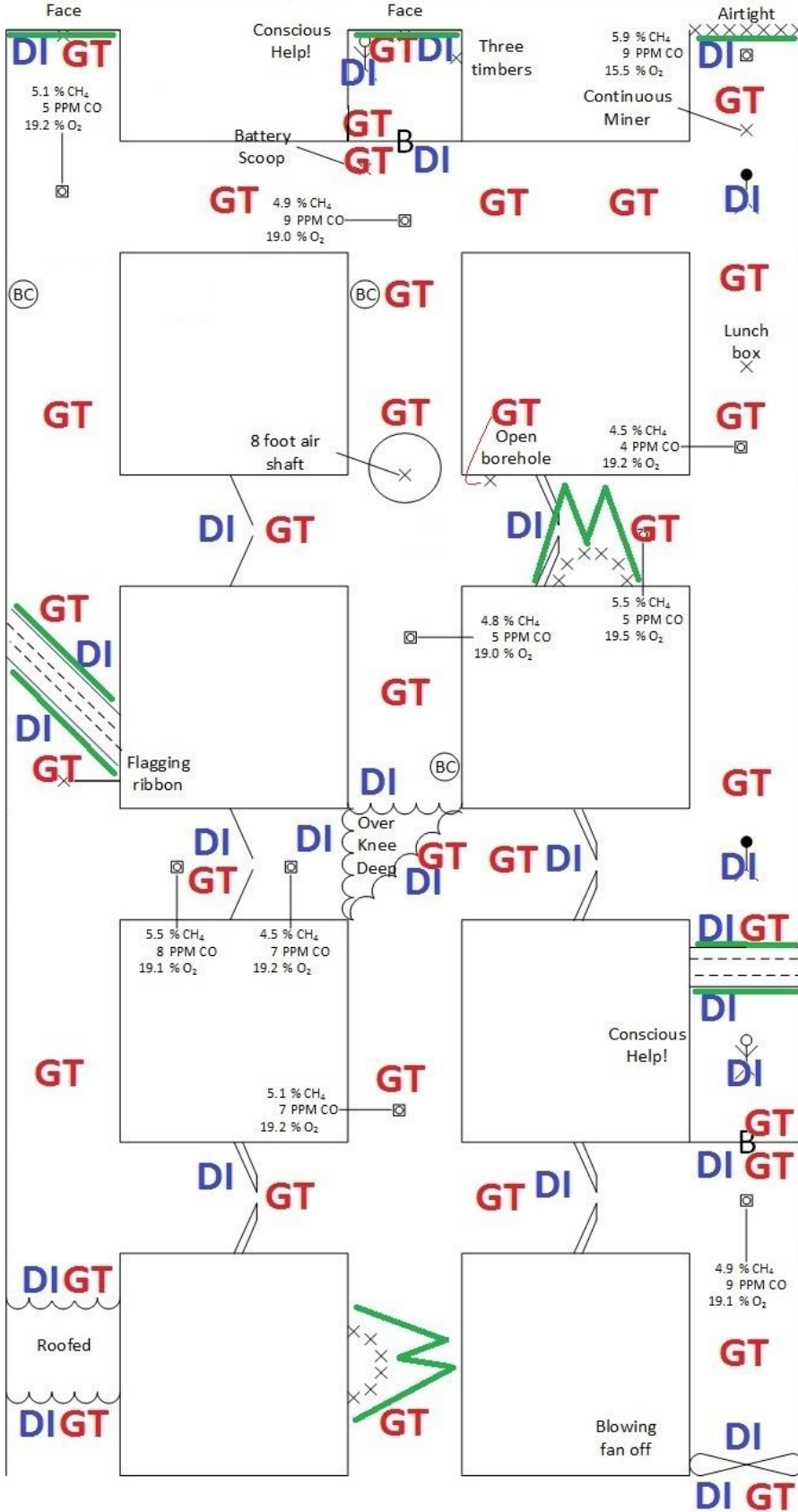

Explosive / Irrespirable

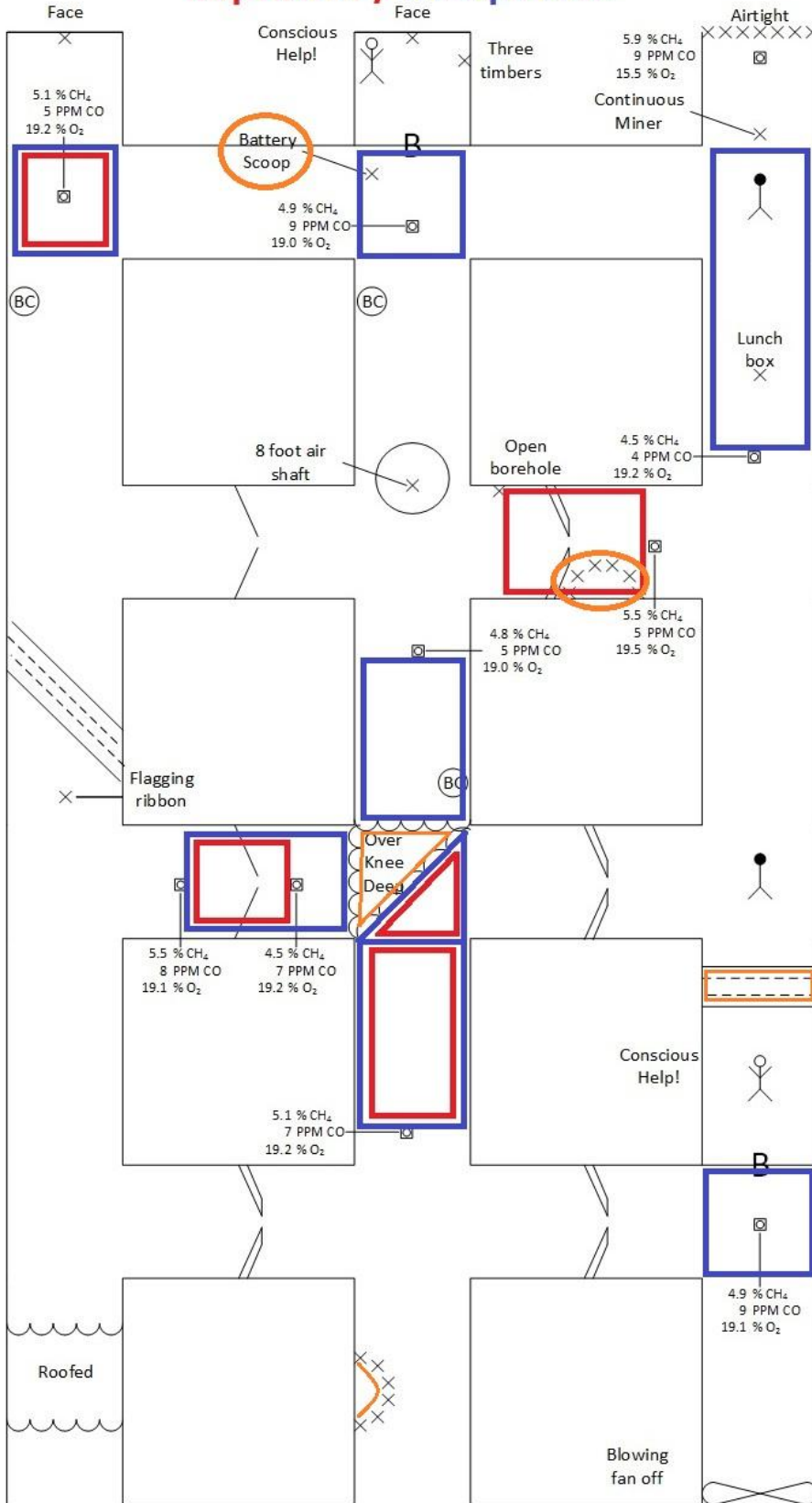

FIRST VENT

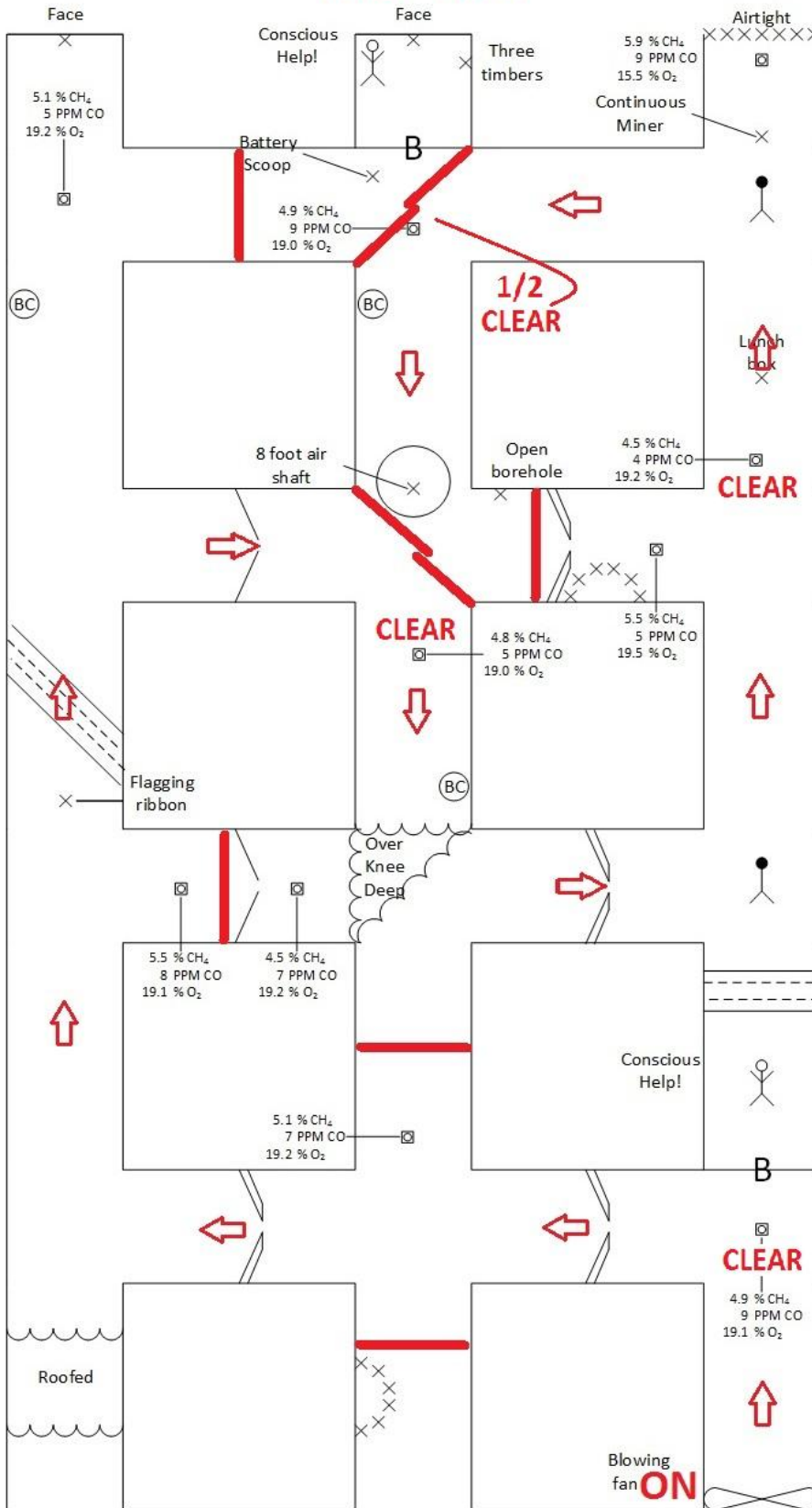

2ND VENT

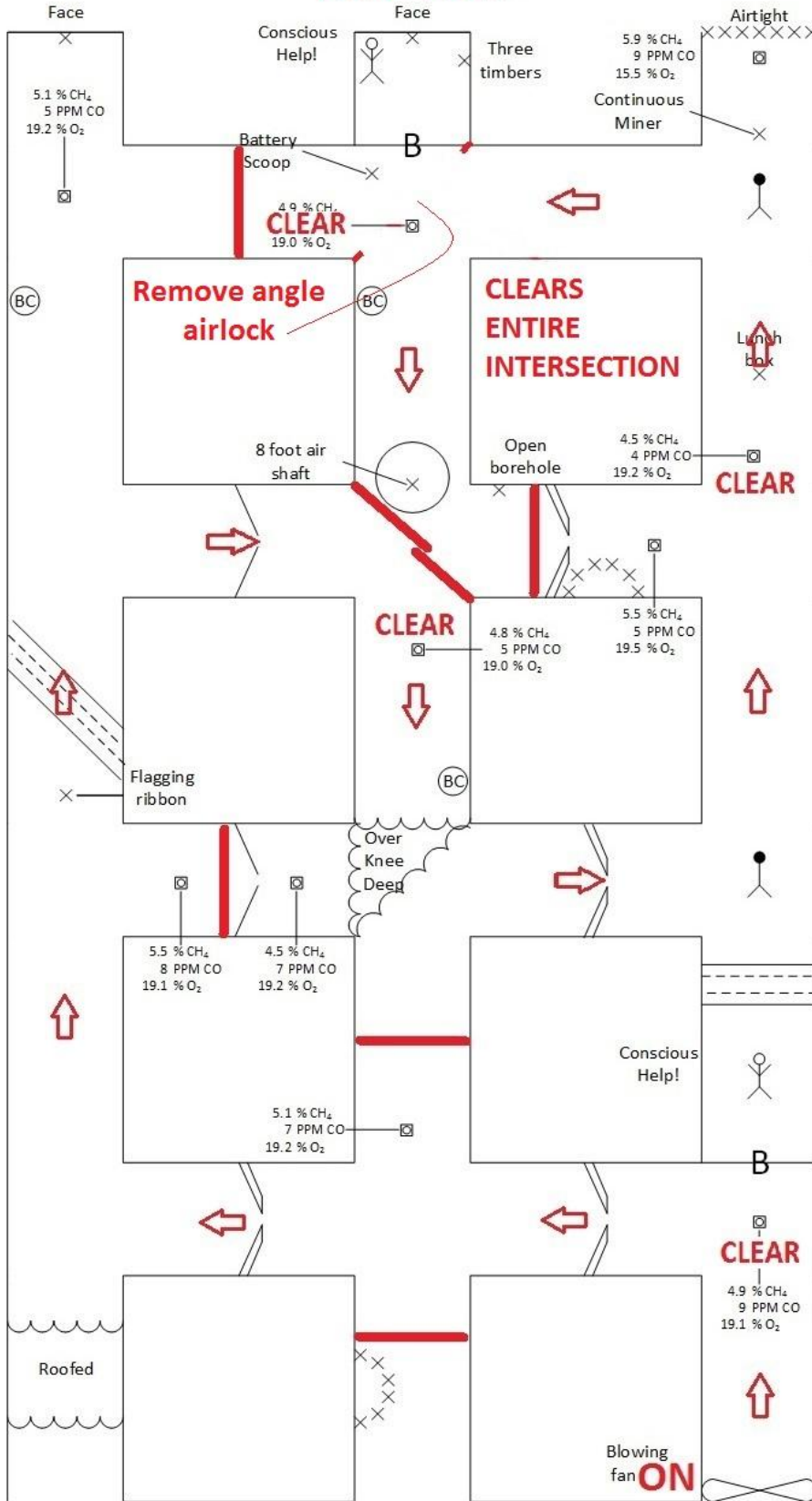

AIRLOCKING OPTION B

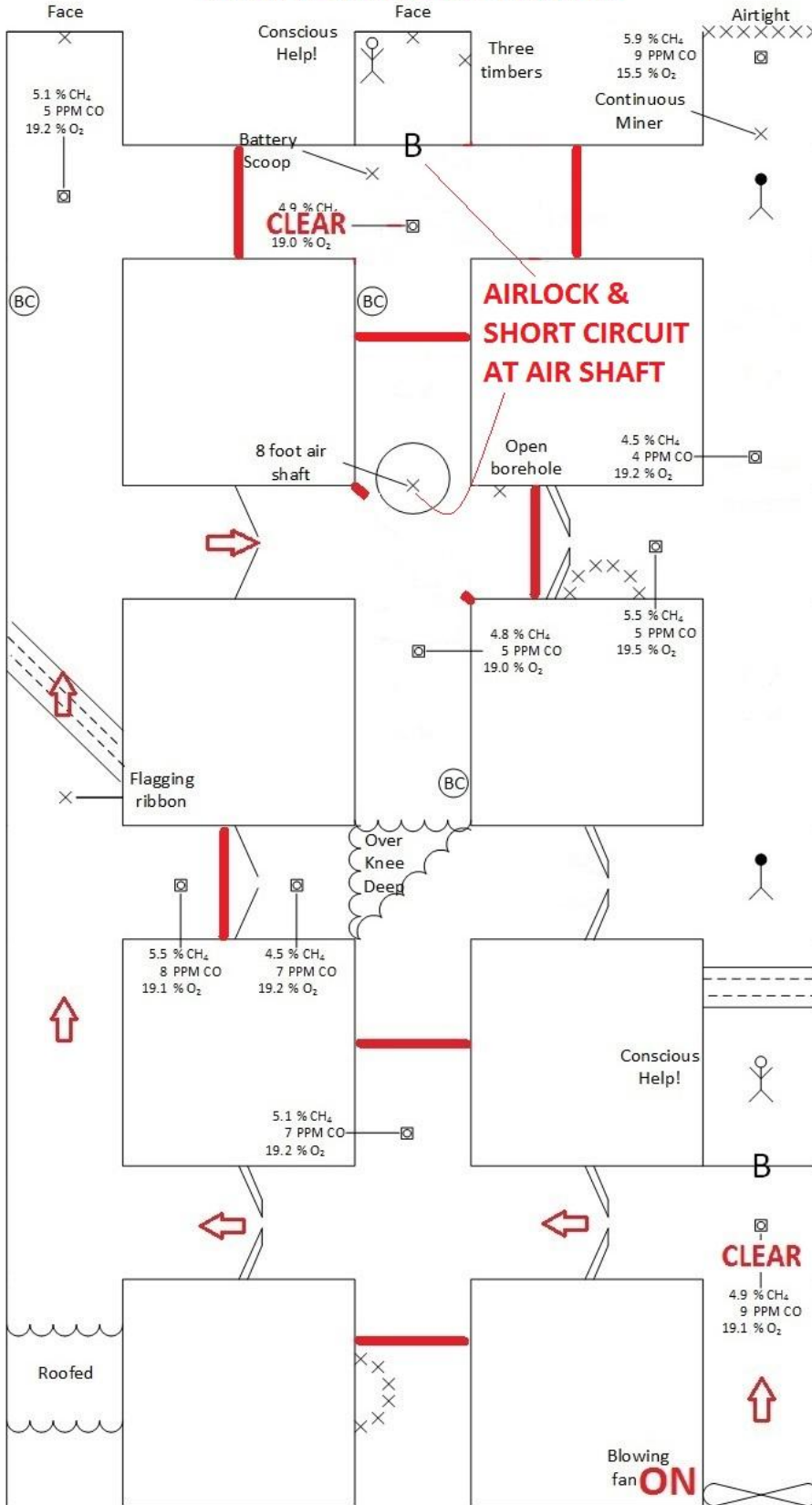

Timber to Conscious Person

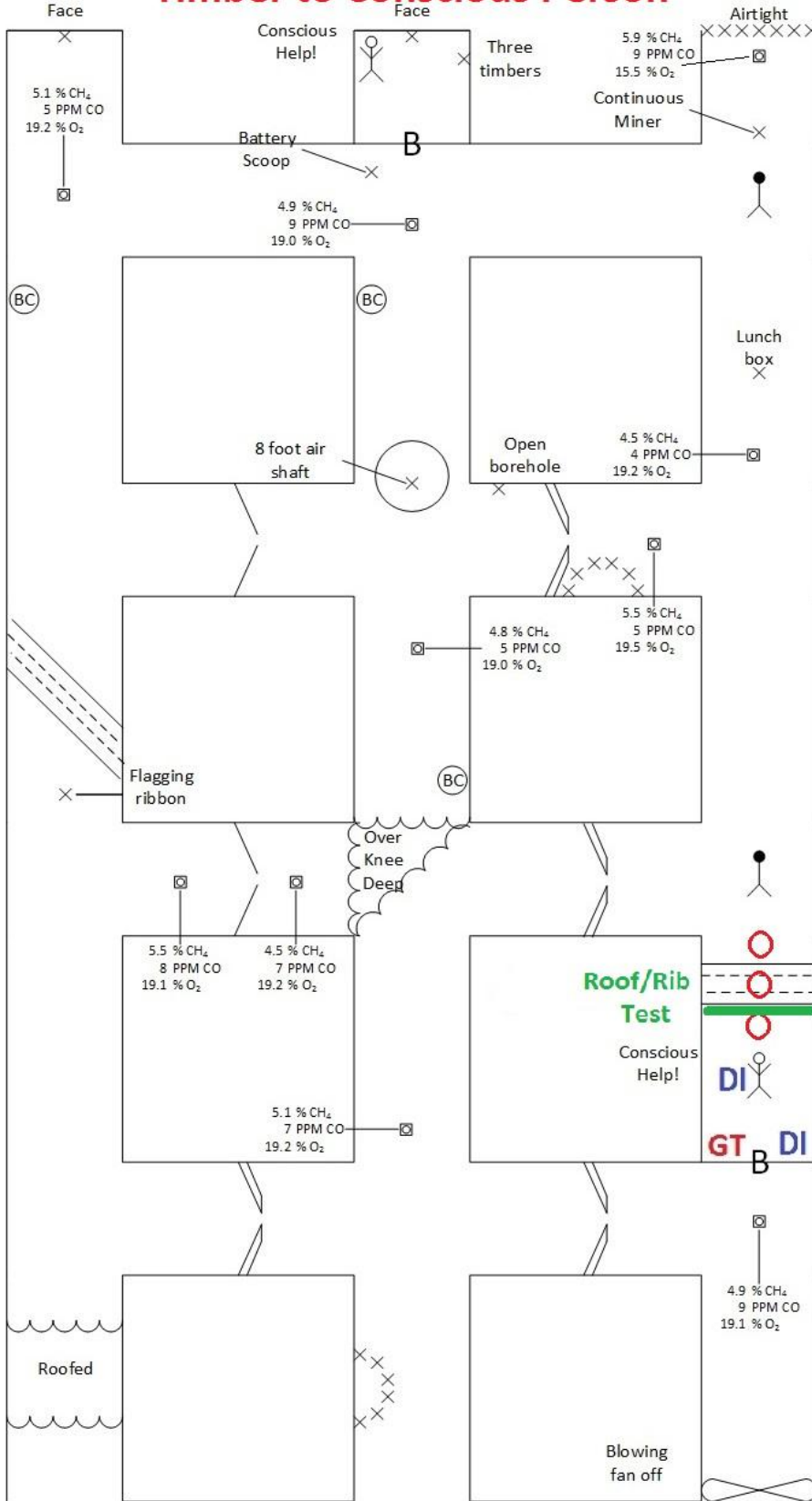

Keys to Problem

- Team cannot breach barricade in no.3 entry without stalling the fan
- Team must stay airlocked after starting the fan (open airshaft) and fan is inby FAB
- If team tries to vent barricade in no.3 entry before they vent barricade in no.2 entry, they must airlock into unexplored areas and not stall the fan
- Team must not let explosive mixture in 2nd intersection in no.2 entry go over any unexplored area or ignition source (explosive mixture does not go into water over knee deep)
- According to team travel, team can delay patient if they explore no.1 entry LOC before rescuing conscious person in no.2 entry barricade
- Team must airlock into barricade in no.2 entry LOC without stalling the fan (see airlock maps)
- Team must timber to patient in no. 3 entry from unsafe roof side after rescuing patient in barricade inby LOC
- Team can either FPA on maps or explore no.1 entry LOC at end of problem