

STATEMENT

Welcome to the TG Mine and thank you for your help.

We have a 5 person crew that was tagged in on the mine tag board. They were working an idle shift doing some roof bolting and clean-up work. One of the 5 listed on the tag board came outside and said that they had hit some roof joints that was emitting methane and low oxygen. He was able to get out of the mine but not sure about the status of the others. The mine officials have not been able to locate the missing miners.

Stoppings have been damaged by equipment working on the Unit. The air to this unit is currently short circuited through a fresh air base set up in an outby crosscut. The fan is running and cannot be turned off, reversed or stalled.

The Map Is Up To Date and copies will be supplied to you once you start your exploration process.

All support staff and supplies are on the property waiting the outcome of your exploration.

God speed and be careful.

WRITTEN INSTRUCTIONS

- Explore the entire mine if it can be done safely.
- Account for all missing miners.
- Report to Briefing Officer any dangerous roof joints so he or she can place them on the B.O. Map. Also the location of these joints shall be reported to the Fresh Air Base Superintendent.
- Team is limited to transporting only 2 build material from one team stop to another.
- Up-To-Date team maps are provided.

2014 TG-PX Practice Problem

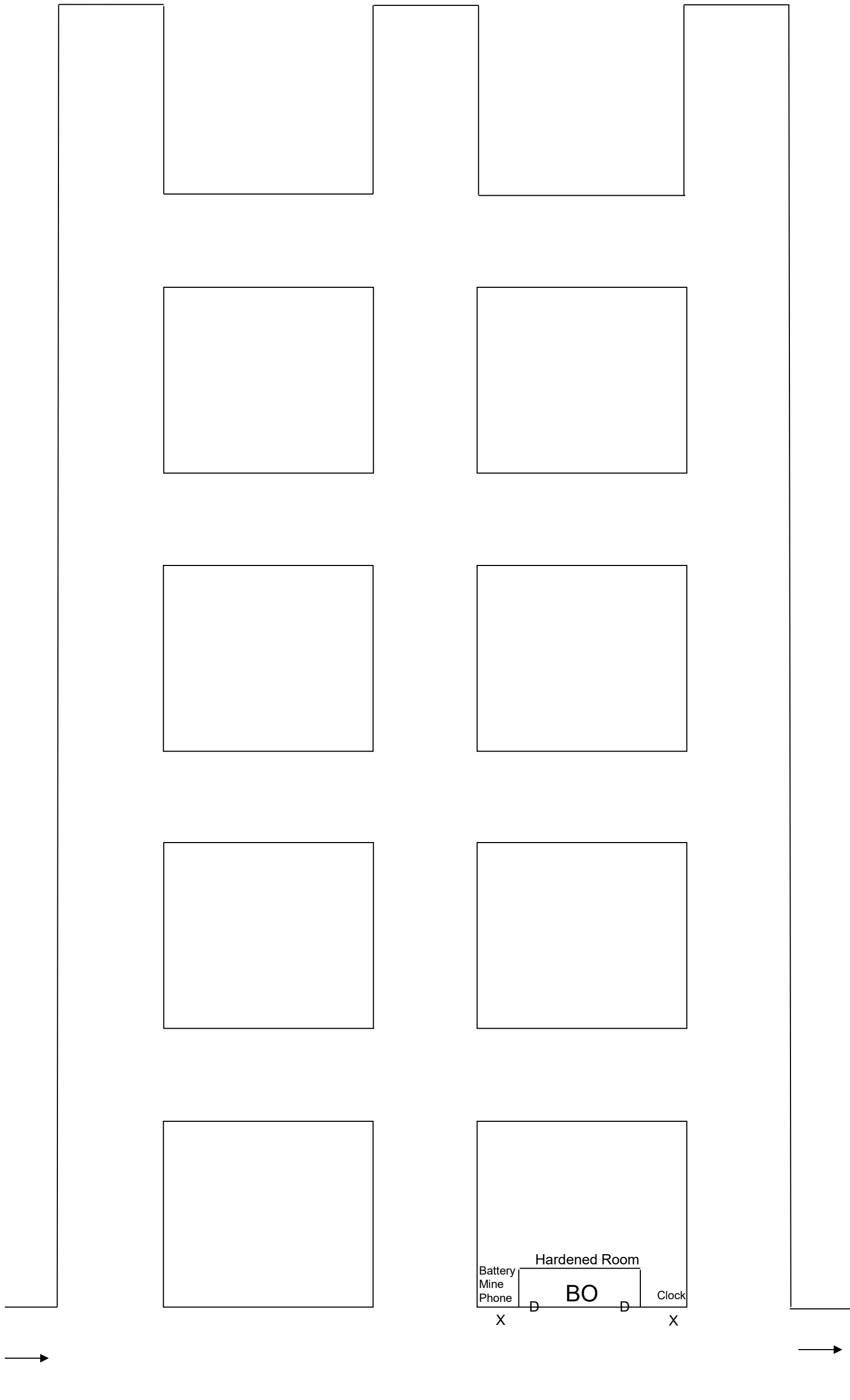

Field & Briefing Officer Map

TEAM NO. _____
FIELD NO. _____
SCALE 1" = 10'

2014 TG-PX Practice Problem

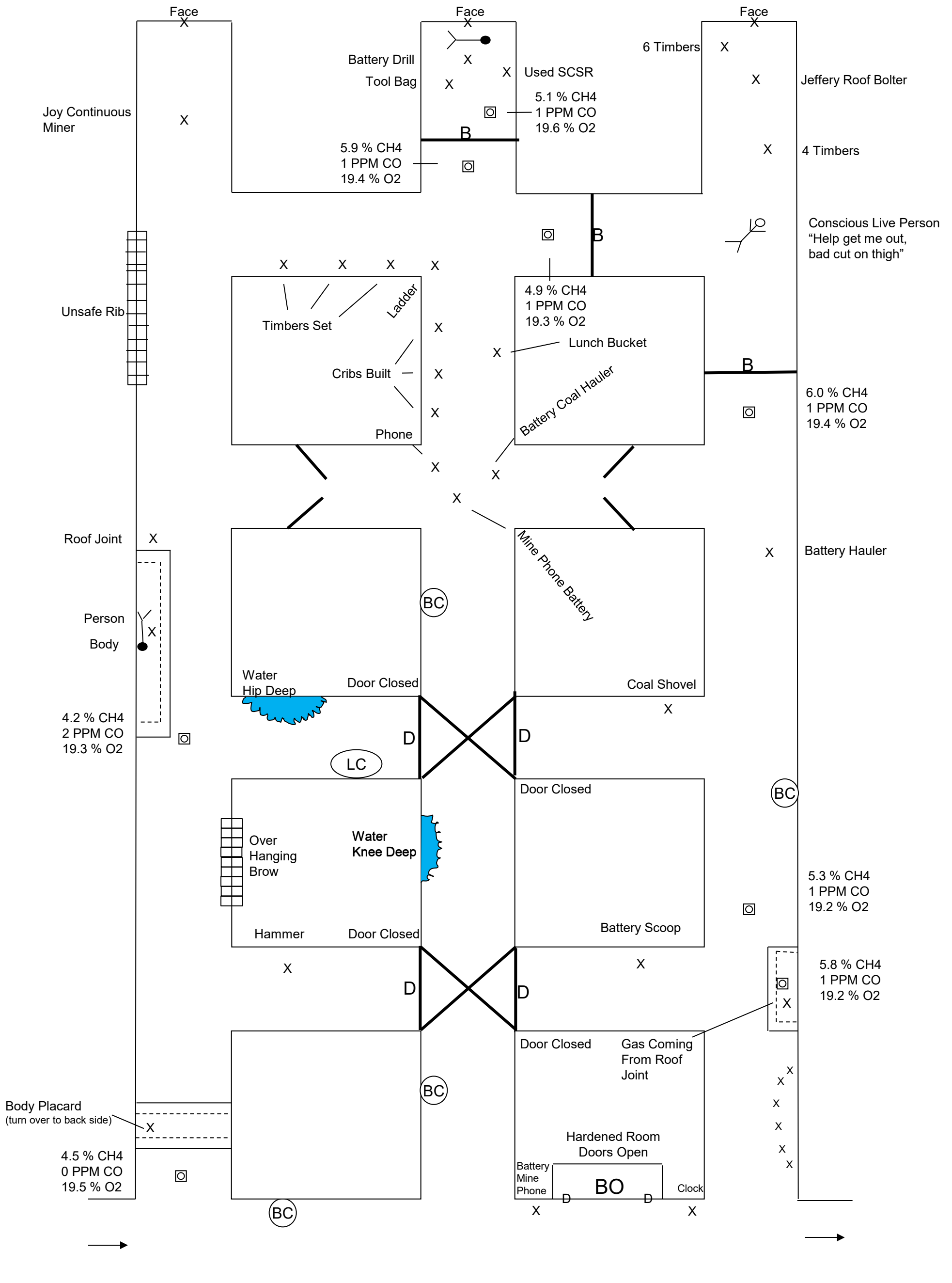

TEAM NO. _____
 FIELD NO. _____
 SCALE 1" = 10'

2014 TG-PX Practice Problem

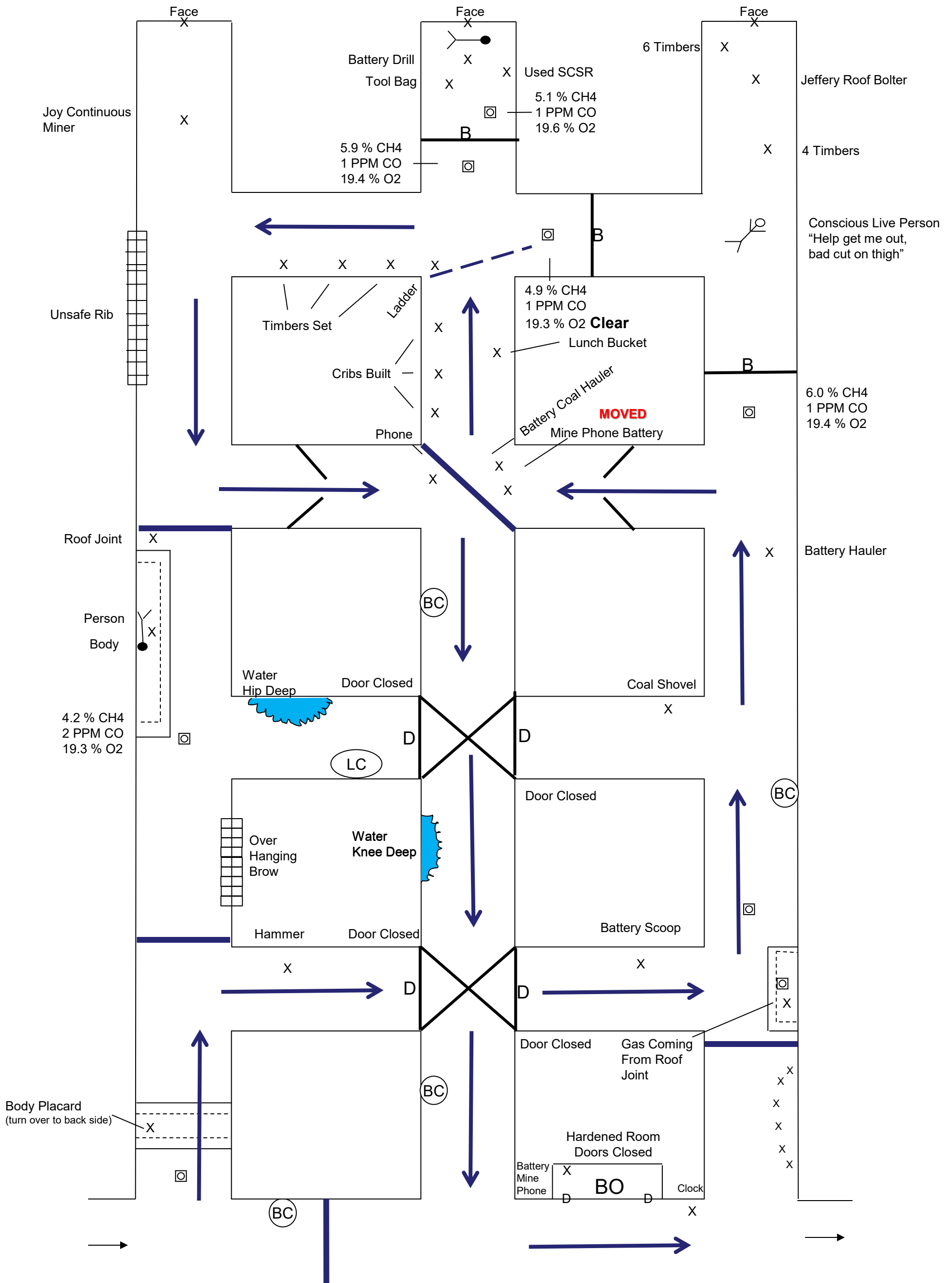

BO can only build this temporary stopping before line curtain is installed & back in hardened room before curtain is used

Second Ventilation

