

2013 Nevada Mine Rescue Contest SPECTATORS PACKET



Welcome & Thank You for being here!

This packet has been put together to help you, the spectator, to understand what you're seeing the mine rescue teams do during the contest. All we ask is that you not share this with the teams currently in lock-up.

We all pray that when our husbands, wives, sons, daughters and friends go to work in an underground mine that there is someone there that can help them if something goes wrong. The fine folks out there on the field volunteer their time and energy to be that person.

The men and women that you will see here today have spent many hours practicing their craft. If you are a family member of someone out on the field or a team member that isn't competing today, you're fully aware of the sacrifices made in relation to the time spent. What you are seeing is a small test of part of what they have learned. *Whether the team comes in as first place or last, we all consider them winners and we're all glad that they are around.*

Thank you for being here to root your team on, all of us appreciate it.

Thank you team members for doing what you do.

Thank you Winnemucca Conventions & Visitors Authority for making this possible.

Thank you Nevada Mine Rescue Association for making this possible.

Competing Team Rosters

Great Basin Gold Hollister Mine Rescue	
FIELD	
Captain:	Brianne Bealer
#2	Jermiah Ricketts
#3	John Lizer
#4	Kirt Kirkbride
#5	Sam Greinstein
#6	Jason Sauer
#7	Clemente Gomez
Trainer:	
Technician Team #1	Brianne Bealer
Technician Team #2	Clemente Gomez
FIRST AID	
Captain	Sam Greinstein
Medic #1	Jason Sauer
Medic #2	John Lizer

WIPP WIPP Red Team	
FIELD	
Captain:	Mathew Ridgway
#2	Mark Long
#3	Fabian Carrasco
#4	Justin Bailey
#5	Tony Mihelic
#6	Curtis Sanders
#7	Jim Pearce
Trainer:	Richard West
Technician Team #1	Mathew Ridgway
Technician Team #2	Curtis Sanders
FIRST AID	
Captain	Fabian Carrasco
Medic #1	Mark Long
Medic #2	Jim Pearce

Colorado School of Mines Blue (Men's)	
FIELD	
Captain:	Clancy Harman
#2	Nate Keller
#3	Alex Carlson
#4	Kyle Rovick
#5	Robert Williams
#6	Devin Weekley
#7	Leo Welman
Trainer:	Alex Robles
Technician Team #1	Devin Weekley
Technician Team #2	Nate Keller
FIRST AID	
Captain	Kyle Rovick
Medic #1	Alex Carlson
Medic #2	Trey Williams

Newmont USA, Ltd Midas	
FIELD	
Captain:	Mike Castillo
#2	Val Full
#3	Wayne Tucker
#4	Mat Macias
#5	Ron Snellings
#6	Dave Ricker
#7	Armando Sandoval
Trainer:	Dorsey Munson
Technician Team #1	Dave Ricker
Technician Team #2	Wayne Tucker
FIRST AID	
Captain	Mike Castillo
Medic #1	Ron Snellings
Medic #2	Mat Macias

Newmont USA, Ltd Carlin	
FIELD	
Captain:	Cody Allen
#2	Jeremy Armstrong
#3	Rob Carter
#4	Jeromy Holland
#5	Wayne Courtney
#6	Quentin Carroll
#7	Brad Nelson
Trainer:	Dorsey Munson
Technician Team #1	Wayne Courtney
Technician Team #2	Jeremy Armstrong
FIRST AID	
Captain	Rob Carter
Medic #1	Cody Allen
Medic #2	Quentin Carroll

Colorado School of Mines Silver (women's)	
FIELD	
Captain:	Nicole Henderson
#2	Melissa Anderson
#3	Christine Geier
#4	Erin Keogh
#5	Katherine Jennings
#6	Chelsea Pomeroy
#7	Sara Hartman
Trainer:	Alex Robles
Technician Team #1	Nicole Henderson
Technician Team #2	Melissa Anderson
FIRST AID	
Captain	Erin Keogh
Medic #1	Christine Geier
Medic #2	Sara Hartman

Competing Team Rosters

Barrick Cortez Cortez				Hecla Lucky Friday				Barrick Goldstrike BGMI			
FIELD				FIELD				FIELD			
Captain:	Chris Stodtmeister			Captain:	Bob Burden			Captain:	Steven Adams		
#2	Derek Dawson			#2	Nick Furlin			#2	Tim Carroll		
#3	Jason Sabey			#3	Dale Stepro			#3	Jay Roloson		
#4	Carlos Salas			#4	Ryan McCorkle			#4	Gabe Chavez		
#5	Jeff Freeman			#5	Jeff Hunter			#5	Jack Simonsen		
#6	Justin Coats			#6	Darrin Miller			#6	Justin Conin		
#7	Karl Nelson			#7	Zac Thomas			#7	Joe Ferguson		
Trainer:	Tom Senecal			Trainer:	Scott Hogamier			Trainer:	Wade Fruge		
Technician Team #1	Kelly Gonzales			Technician Team #1	Jeff Hunter			Technician Team #1	Joe Ferguson		
Technician Team #2	Jeff Freeman			Technician Team #2	Ryan McCorkle			Technician Team #2	Justin Conin		
FIRST AID				FIRST AID				FIRST AID			
Captain	Carlos Salas			Captain	Bob Burden			Captain	Jack Simonsen		
Medic #1	Karl Nelson			Medic #1	Nick Furlin			Medic #1	Steven Adams		
Medic #2	Derek Dawson			Medic #2	Dale Stepro			Medic #2	Jay Roloson		
Climax Molybdenum Molybdenum				US Silver & Gold Galena Mine Rescue				Barrick Turquoise Ridge Barrick Turquoise Ridge			
FIELD				FIELD				FIELD			
Captain:	Jeff Karlin			Captain:	Claude Dempsey			Captain:	Tim Lambert		
#2	Ben Richie			#2	Aaron Penny			#2	Warren havens		
#3	Matt Aptt			#3	Marlon Allmer			#3	John Mullen		
#4	Jake Durant			#4	Jayson Williams			#4	Sam Kampf		
#5	Tim McCoy			#5	Kevin Johnson			#5	Duane Troike		
#6	Mark Rotchstein			#6	Aaron Gross			#6	Dustin Filippe		
#7	Cory Calvert			#7	Larry Jones			#7	Robert A. Rodriguez		
Trainer:	Albert Archuleta			Trainer:	Mike Weaver			Trainer:	Ernest Fortman		
Technician Team #1	Jeff Karlin			Technician Team #1	Kevin Johnson			Technician Team #1	Warren Havens		
Technician Team #2	Ben Richie			Technician Team #2	Larry Jones			Technician Team #2	John Mullen		
FIRST AID				FIRST AID				FIRST AID			
Captain	Matt Aptt			Captain	Jason Williams			Captain	Duane Troike		
Medic #1	Mark Rotchstein			Medic #1	Aaron Penny			Medic #1	Sam Kampf		
Medic #2	Tim McCoy			Medic #2	Claude Dempsey			Medic #2	Robert A. Rodriguez		

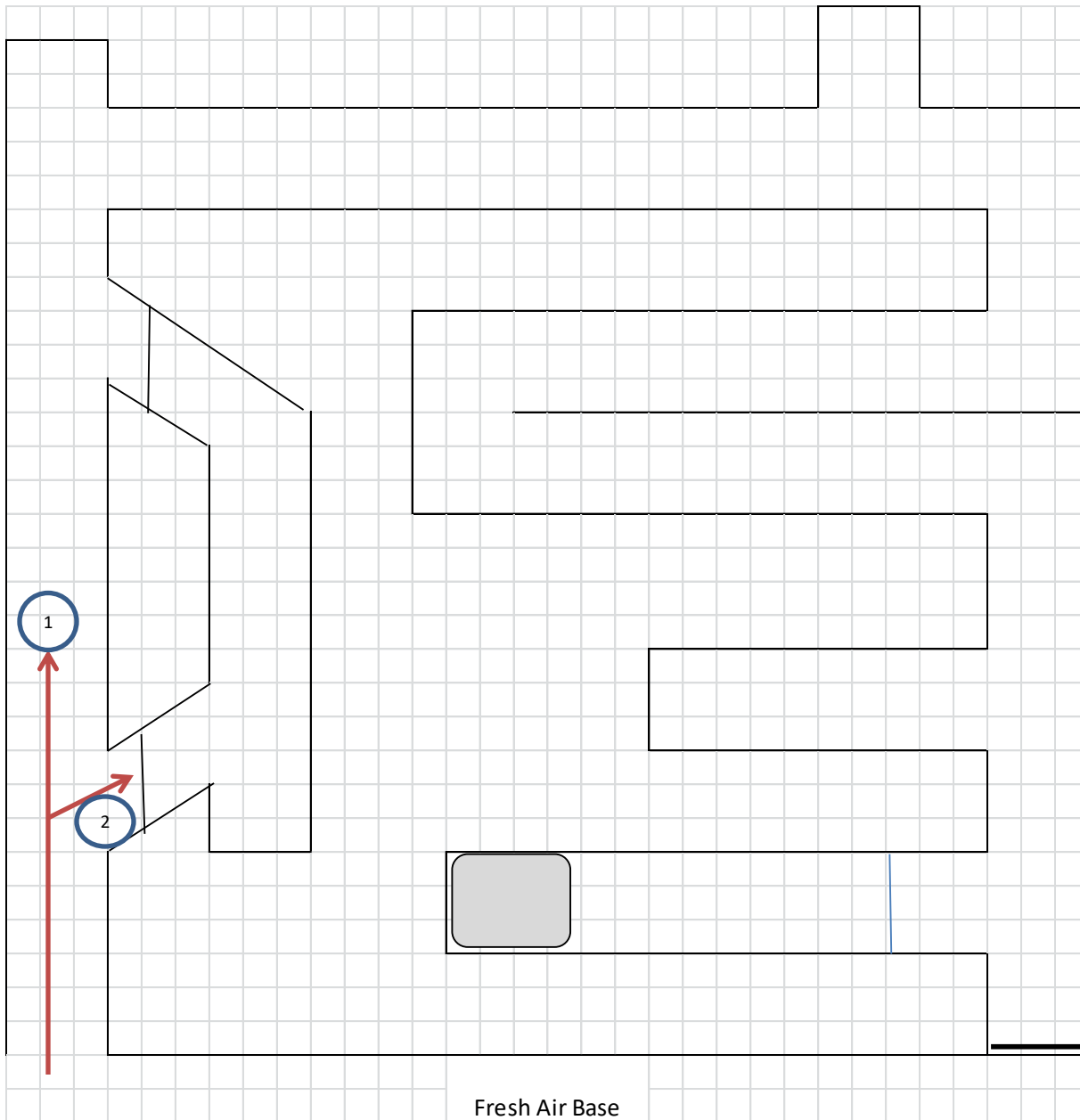

This map is not to scale

The team will arrive at the Fresh Air Base (FAB) to begin the problem. The #1 judge will introduce himself and the #2 judge. The team captain will start the clock on the table and the scenario begins. The team will check gas readings at the portal and enter the mine. They **must count off going into smoke**. Shortly after entering the mine the team will make their 50' team check (the circled 1 is as far as the team can travel before they complete this check. Most will do it before.). The team will check the first drift to the right (2) and find a closed fire door. They need to do a gas test here. The gas concentration **is the same as the second gas placard they encountered**

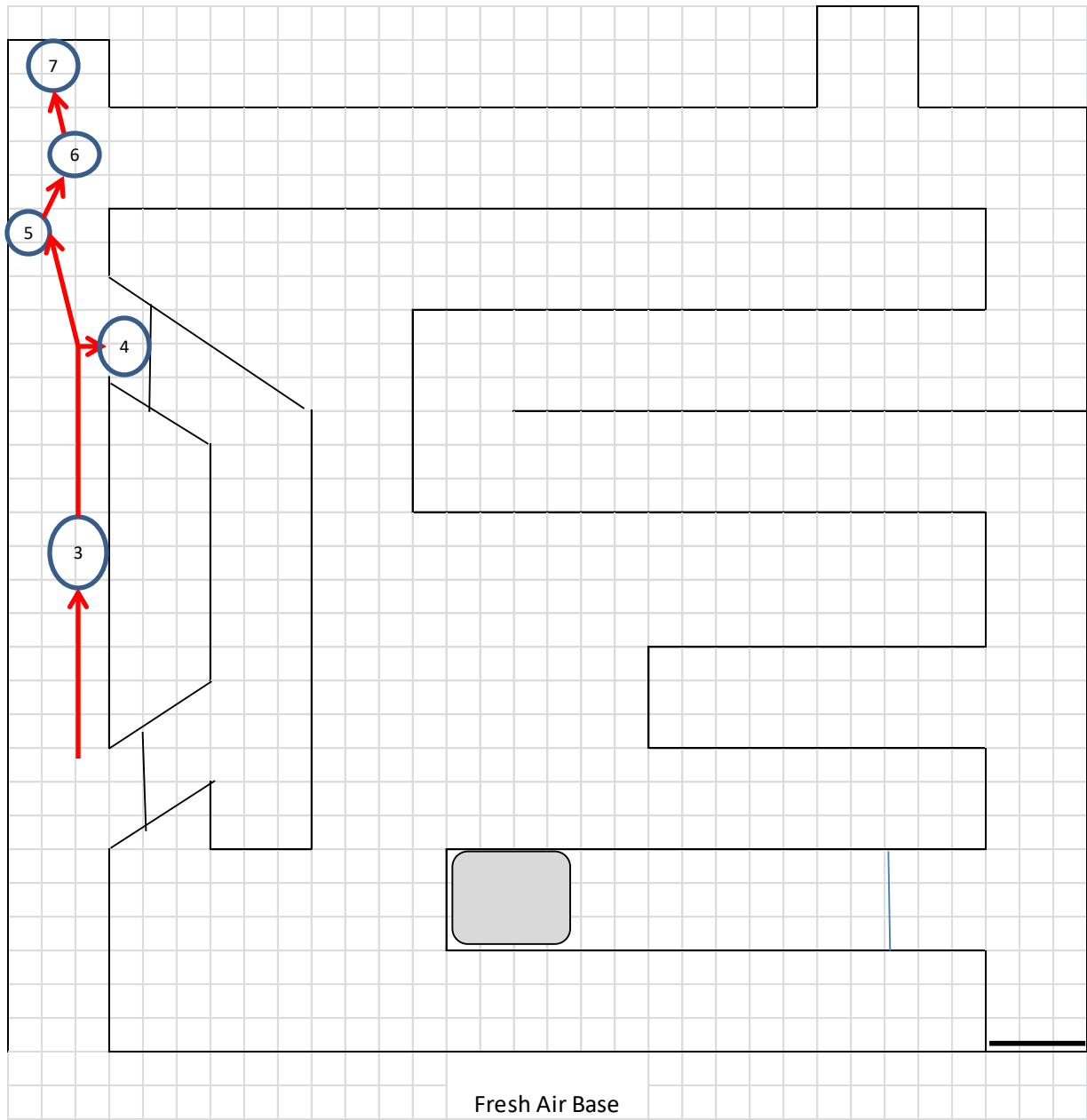

This map is not to scale

The team will leave the first entry and continue to move into the mine. At mid-pillar (3) they will find 6 wooden posts. The team will map these and may take them. They will travel up to the second entry (4), find a closed fire door and make a gas test. The concentration will be the same as the previous one. Continuing on, the team will find one set of stopping materials (5). This should be mapped and may be taken. At (6) the team will have entered the intersection. They will do a gas test and the #1 Judge will get the ISC rep to test the team's gas detector. The #2 Judge will need to pay close attention to the readings (note it). The captain may stretch out into the heading, there he/she will find water ankle deep and easily scaled loose at the face. A gas test will need to be made at the face (7).

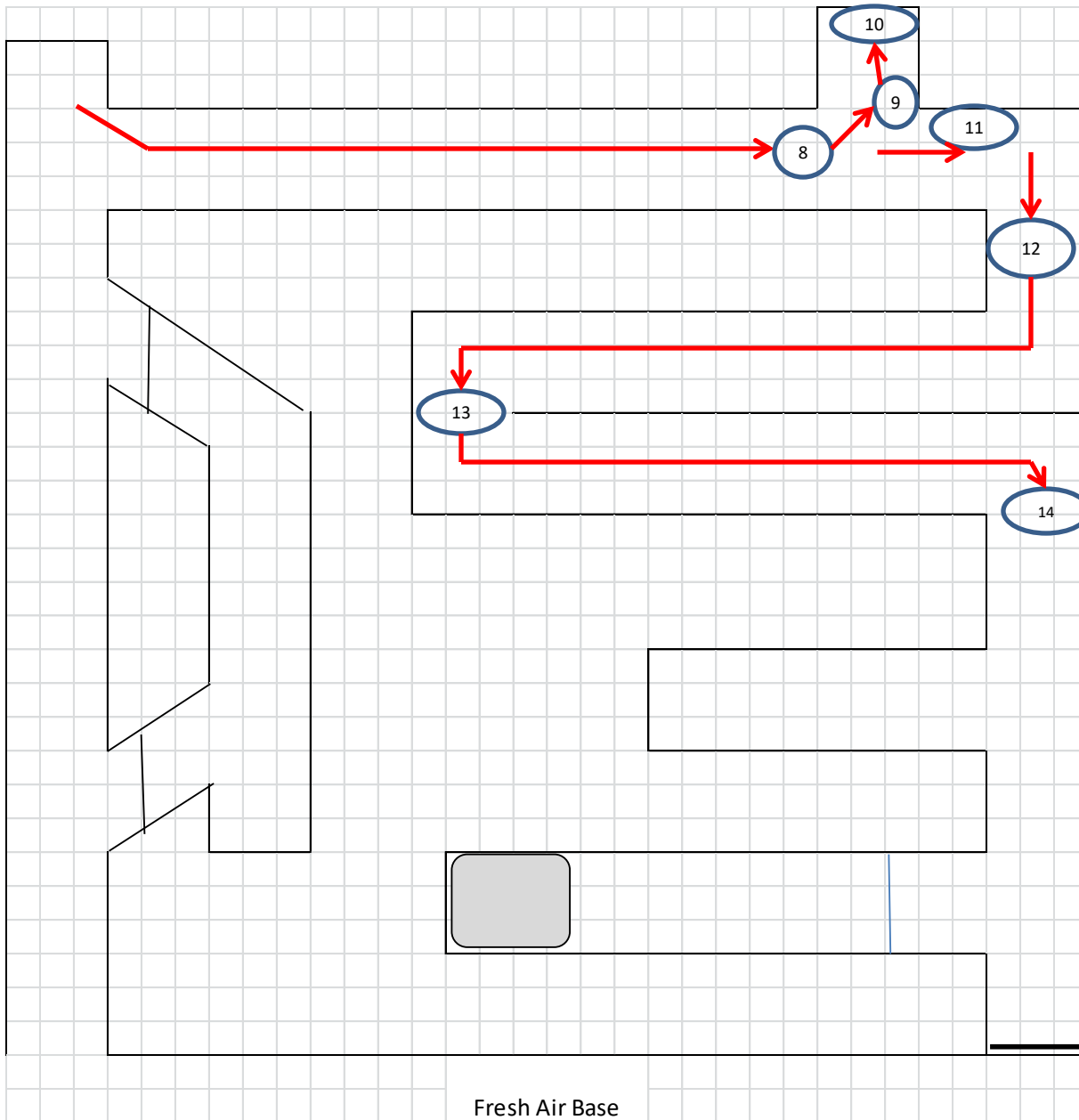

This map is not to scale

The teams will proceed from the last stop and come across an unscaleable roof fall (8). There will be 5 boxes (small boulders) that will have to be moved as the timber is stood into place (timber must be used to support the back).

Once the boxes are moved the team will continue exploring. At (9) they will find a burned out Kabota Boss buggy (still hot) and (10) loose roof at the face which must be scaled before testing for gas.

The team must at least announce loose roof at (11). If the team chooses to bar it down, their effort is successful.

There is a placard at (12) that shows that gas concentrations are improving. The team will continue to (13) finding more improvement. At (14) the team will find one set of stopping material and an extra brattice (needed for later).

This map is not to scale

From (14) at the next intersection there's a placard indicating that gas is improving (15). Gas test must take place. In the stope they will find a jumbo and at the face (16) clear air (must test).

At the next intersection (17) the team will need to do a gas test, they will find clear air at the stopping and end of the drift where it is caved air tight.

The team will bang on the stopping and the #1 judge will read handout #1.

At this point the team has explored the majority of the mine. They will have to enter the stopping at (17).

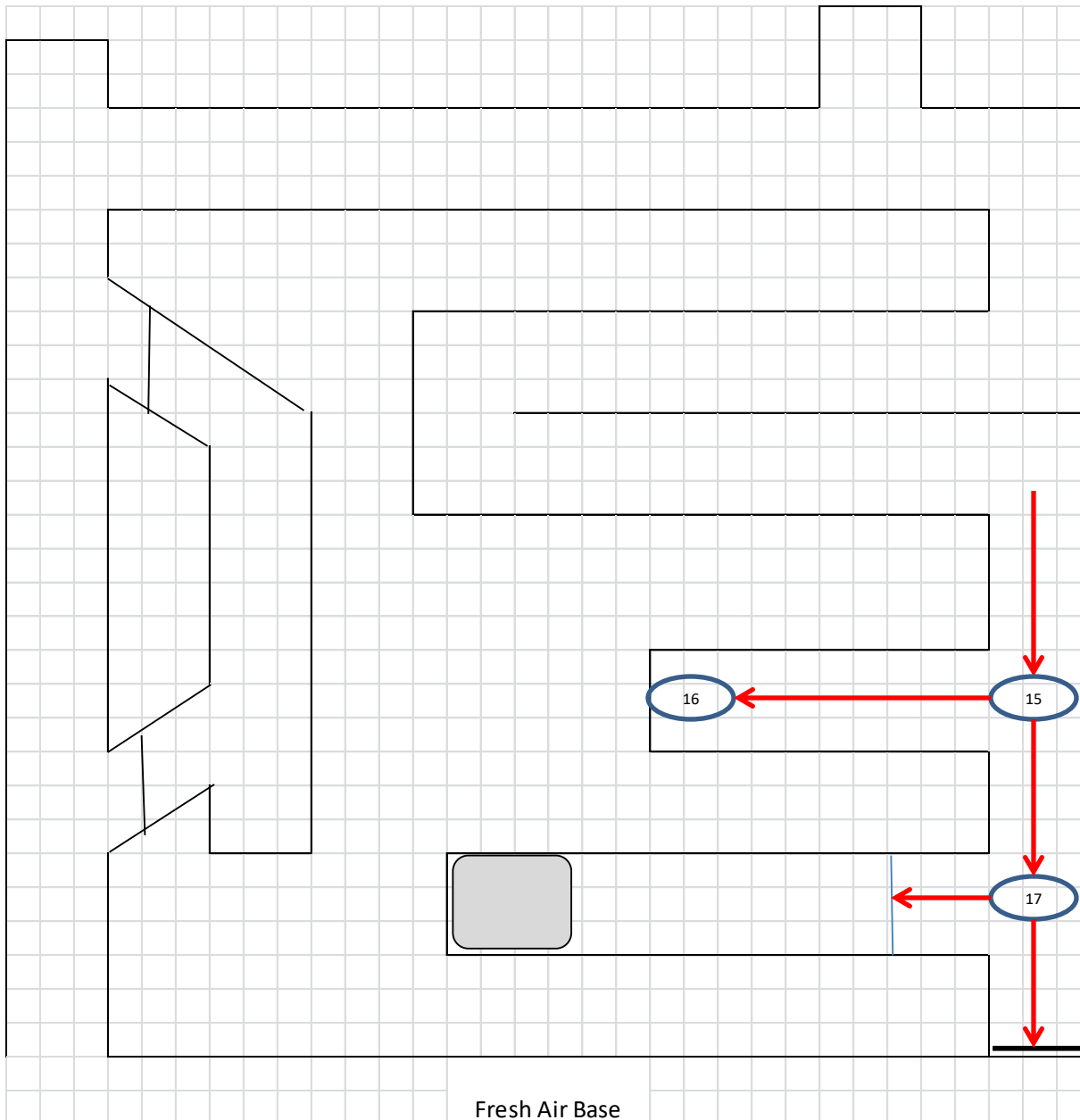

Fresh Air Base

Not to scale

To enter through the stopping, the team **must** airlock, and then breach the stopping (18).

Once inside they will find Driller Bob. He has a minor injury to one of his hands and is ambulatory. The team must explore the rest of the stope. When they move toward (19) they will see a placard indicating the edge of an open stope to a lower level. Gas tests must be taken, but the team must stay back from the edge.

The team may do one of two things before taking the miner out. They may put the miner under oxygen and bring him out or ventilate the mine.

If they decide to put the miner under oxygen, they must rebuild the stopping, or call in for a ventilation change (if they don't rebuild).

They must **simulate** putting the mask on the miner.

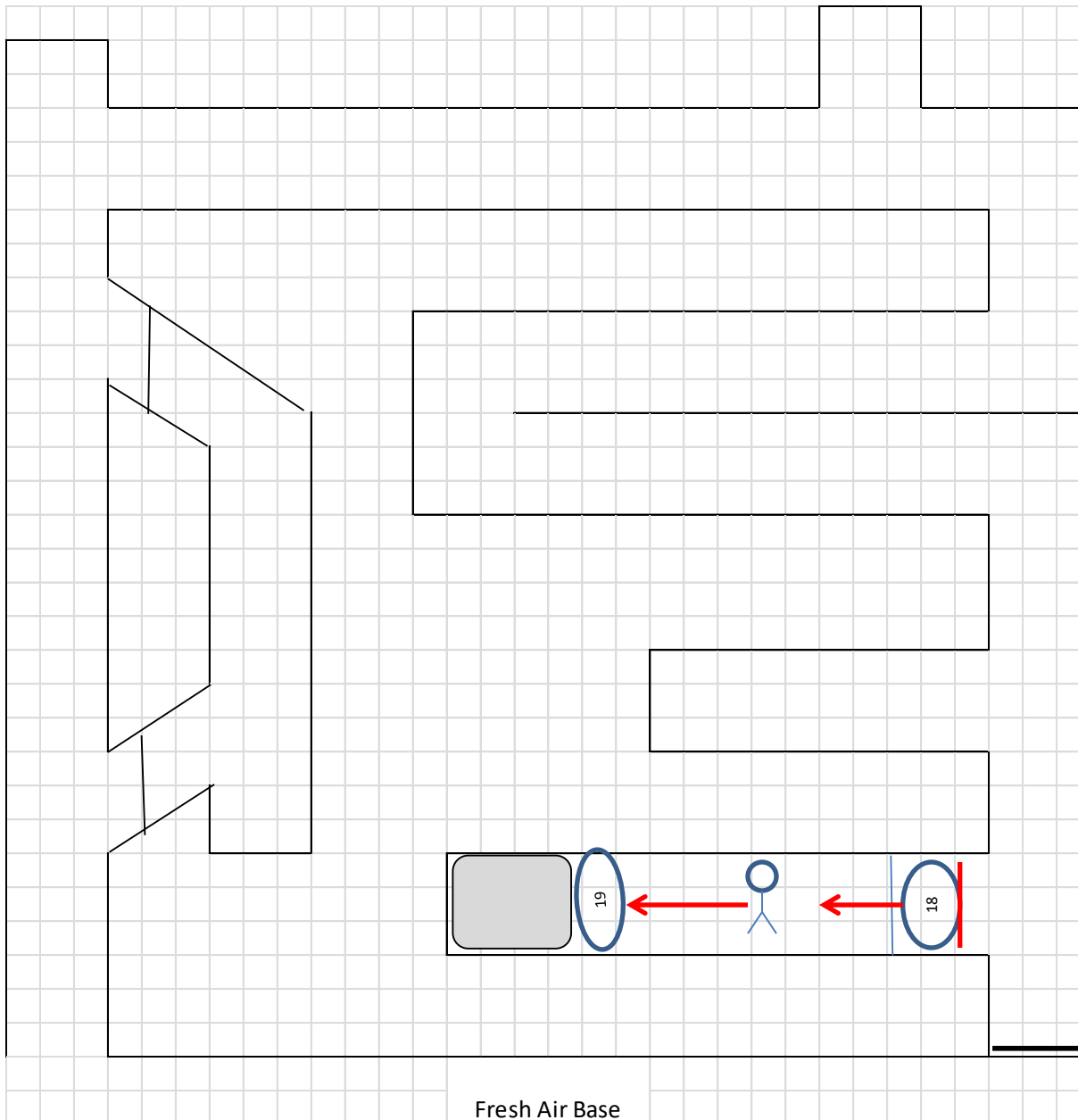

Not to scale

The mine must be ventilated before entry into the shop.

To enter the shop and rescue the miners within, the team will need to airlock in (the team does not know if there is an opening on the inside of the shop). They may enter through either door.

The team will find two miners, they must perform primary assessments. They will find both not showing signs of life. The team must explore and test inside the shop.

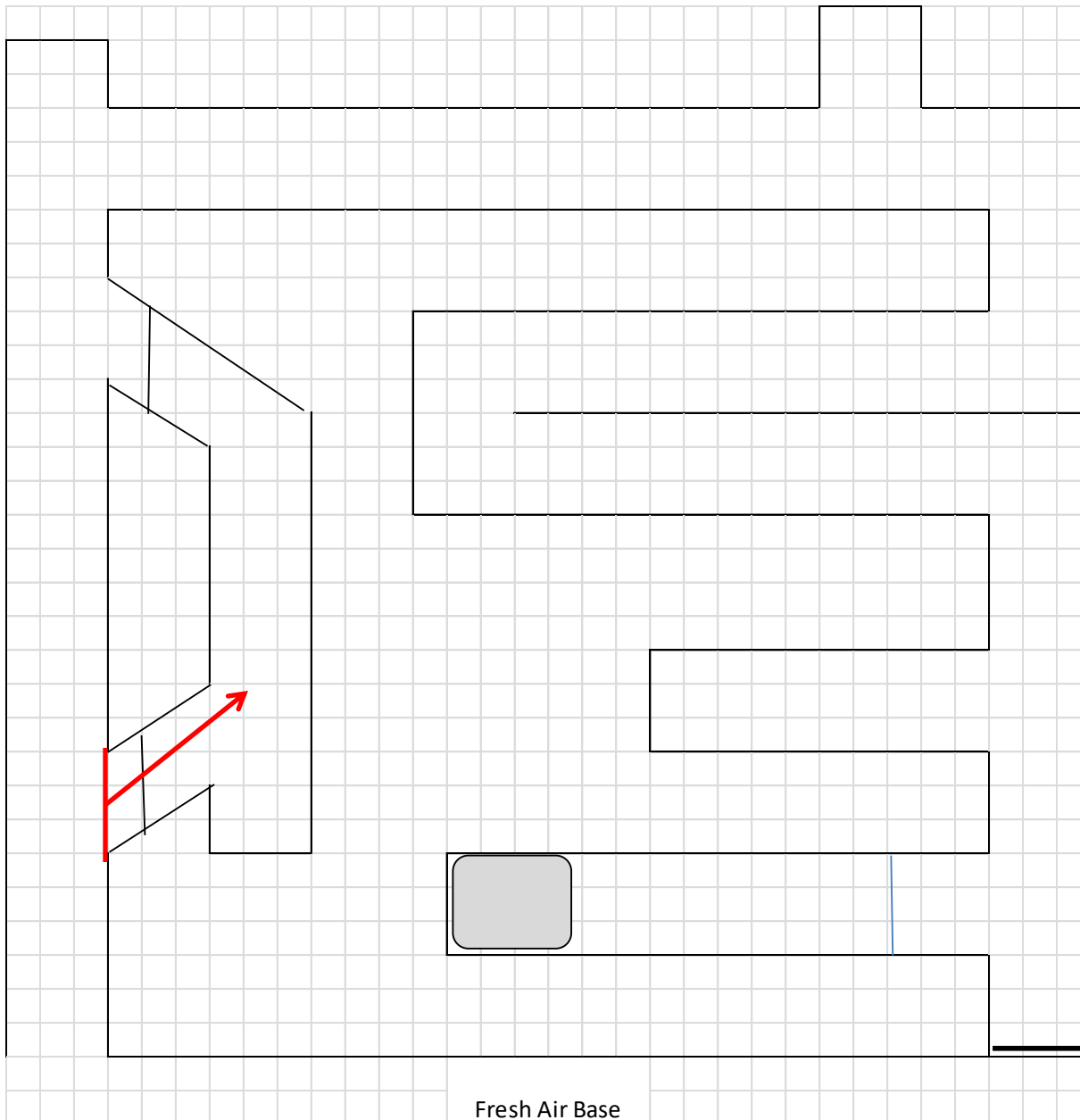

Mine Information

- MSHA ID #00-00000
- Company Name: Black Hole Mining
- Mine Name: Dark Matter Mine
- 6 Man crews, 2-10 hour shifts, 5 days per week
- Commodity: Rare Earth
- The Dark Matter Mine is a new rare earth underground mine. Development of the upper and lower haulage has been completed. The haulages are connected by a decline ramp. The first production long hole stope round has been taken on the upper level.
- Fresh air enters into the mine through the lower portal, travels up the ramp and out the upper portal through a 450 hp axial vane fan. The blades on the fan are mechanically reversible.
- A new borehole has been installed, but the fan is not in place. The borehole (which will eventually be equipped with escape ladders) extends from the bottom of the ramp to the top of the hill.
- Due to it's size and distance from any other mine, the operation is classified by MSHA to come under "small and remote."

Team Briefing Statement

It's not the best day at the Dark Matter Mine. About ½ way through the shift, the haul truck driver was descending down the ramp to the lower haulage and encountered a small pile of rock in the roadway. As he was passing over the pile, a "whole bunch of rock fell" onto the cab. Scared, he gunned the truck through the roof fall, yelled at the LHD operator to get out as he was passing by and exited the mine.

The truck driver informed his supervisor (Bossman Bob) of the roof fall. Bossman grabbed the engineer (Billy Bob) and went speeding into the mine on a Kubota tractor. About 5 minutes later the toplander noticed some smoke coming out of the upper portal. A few minutes later Billy Wrench (mechanic) came out of the portal with his self rescuer on. He told us he saw the Kubota drive past the shop and came out when he smelled the smoke. A little while ago, the fan started making funny noises and we shut it off.

Smoke has stopped coming out of the mine. We haven't heard a thing from the three miners still in the mine. We're worried. Please find our miners, put out any fires and map the mine.

- The mine is non-gassy
- The map is about a month old
- There are no other mines or wells nearby
- The fan is operable, vanes are reversible, but will take awhile.
- Power and compressors are off and guarded.

Team Briefing Statement (continued)

- Guards have been posted at the fan controls, generator and both portals.
- There are no explosives stored underground.
- There may be some combustibles and flammables in the shop in containers.
- The fresh air base has been set up at the upper portal.
- There are two teams on site. One is resting, the other is trying to bench their equipment.
- The resting team has explored the lower level and didn't find anything. They did not travel up the ramp because of the reported roof fall. The captain reported that the air was good, but was not moving.
- All regulatory agencies have been contacted and are either on site or nearby.
- Supplies to work the rescue are on site and available.

When you are ready we will head out to the field. You will have 90 minutes to complete the problem. You will receive a 5 minute warning.

Good Luck!

Ventilation

