

2013 Skills

Mine Rescue Problem

Mine Rescue Statement 2013

- Welcome to the not so happy mine. We have a problem. Last night on midnight shift, a four man crew went into the 3rd right section to move belt. About 3:00am this morning there was a jump in the water gage. And the fan kicked power. All people have been evacuated except for the people in the 3rd right. We have tried to contact them, but we have not had any luck. Power has been restored to the exhaust fan, but the fan has not been turned on. Gas readings have indicated high methane, low oxygen, but no sign of a fire. All authorities have been notified, and there is a backup mine rescue team ready to assist you.

Mine Rescue Problem

- Explore the entire mine where it can be done safely. Bring all live people to the fresh air base.

Packet Map

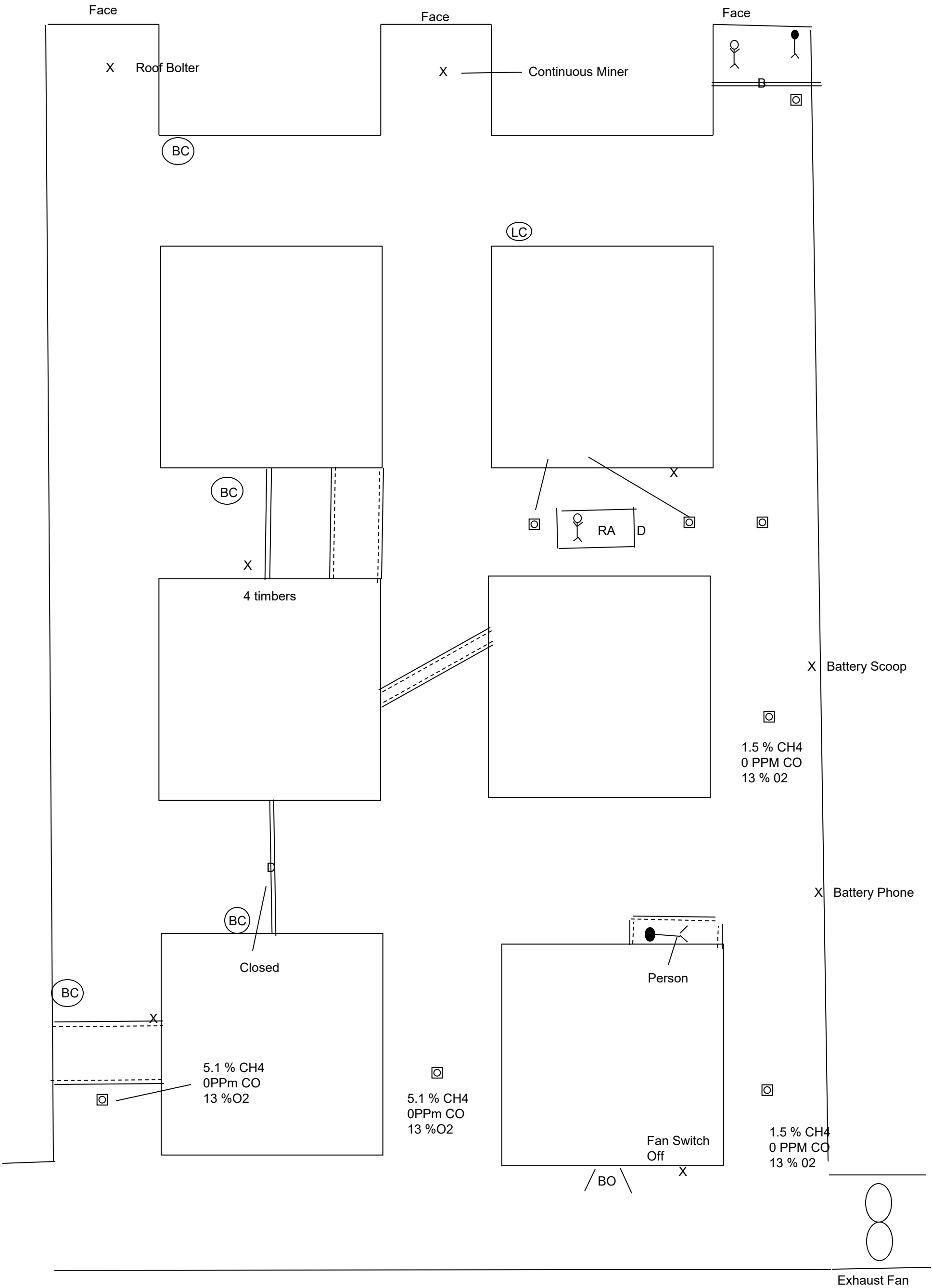

Field Map

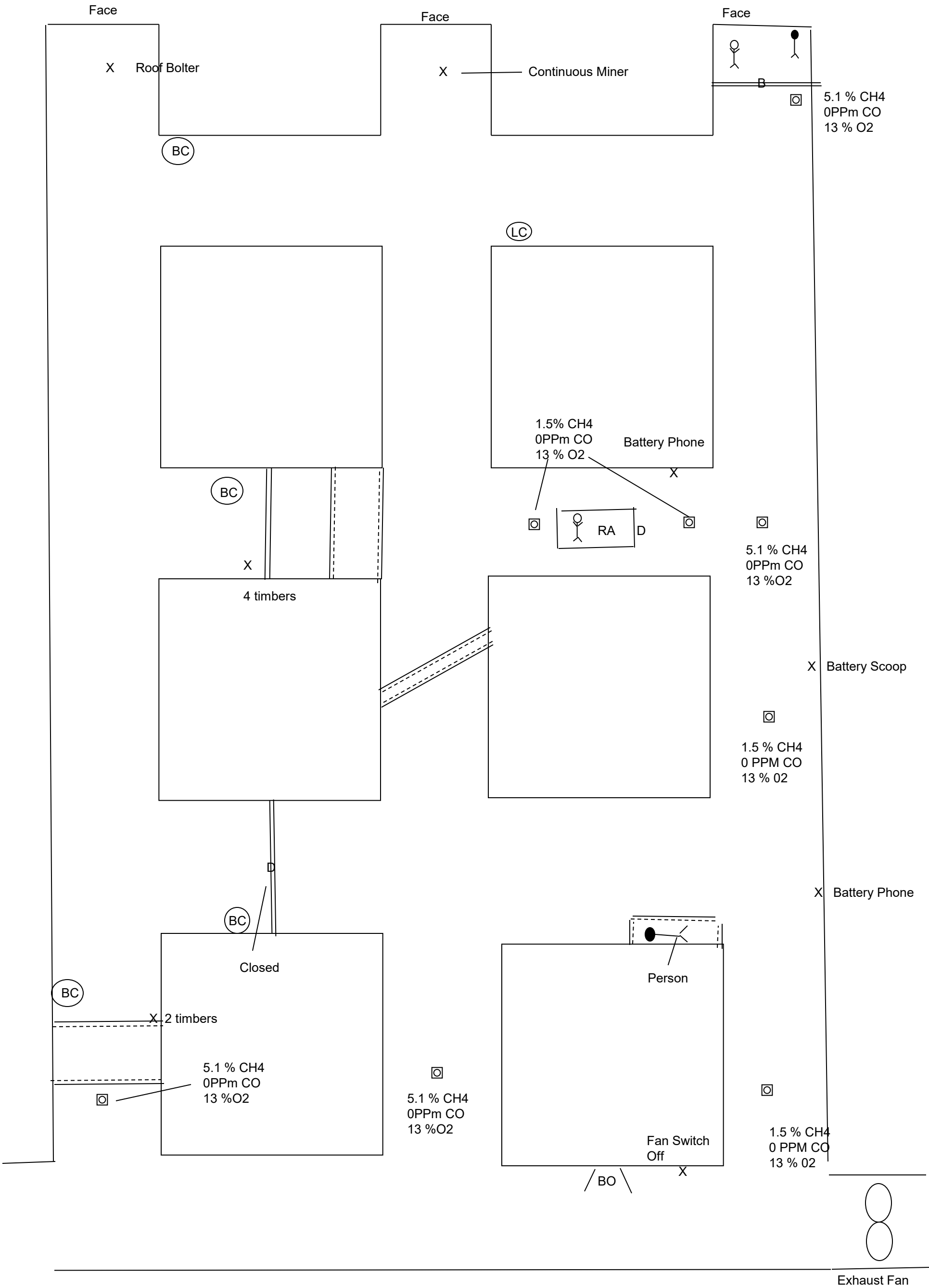

Team Stops

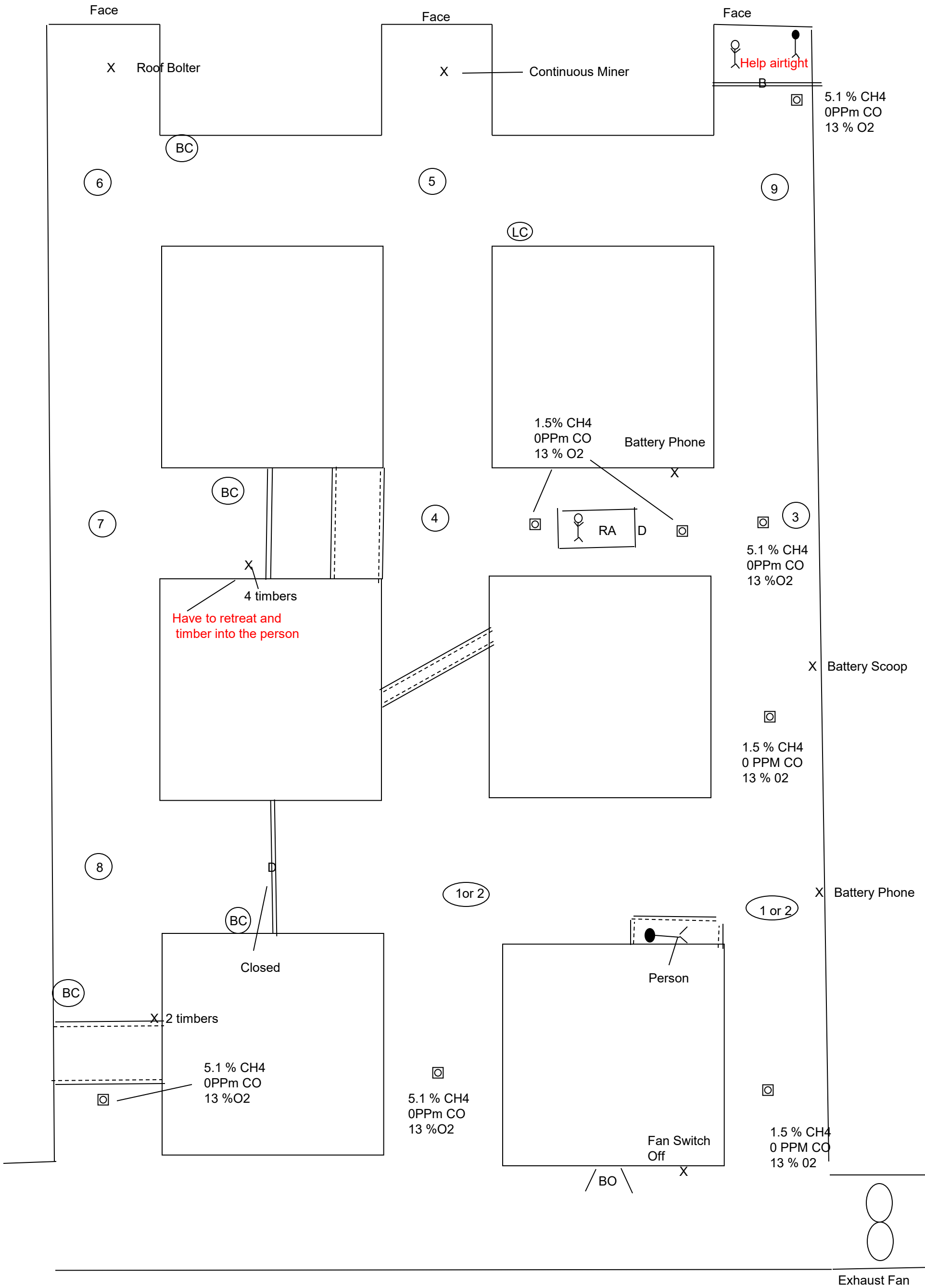

1st Vent

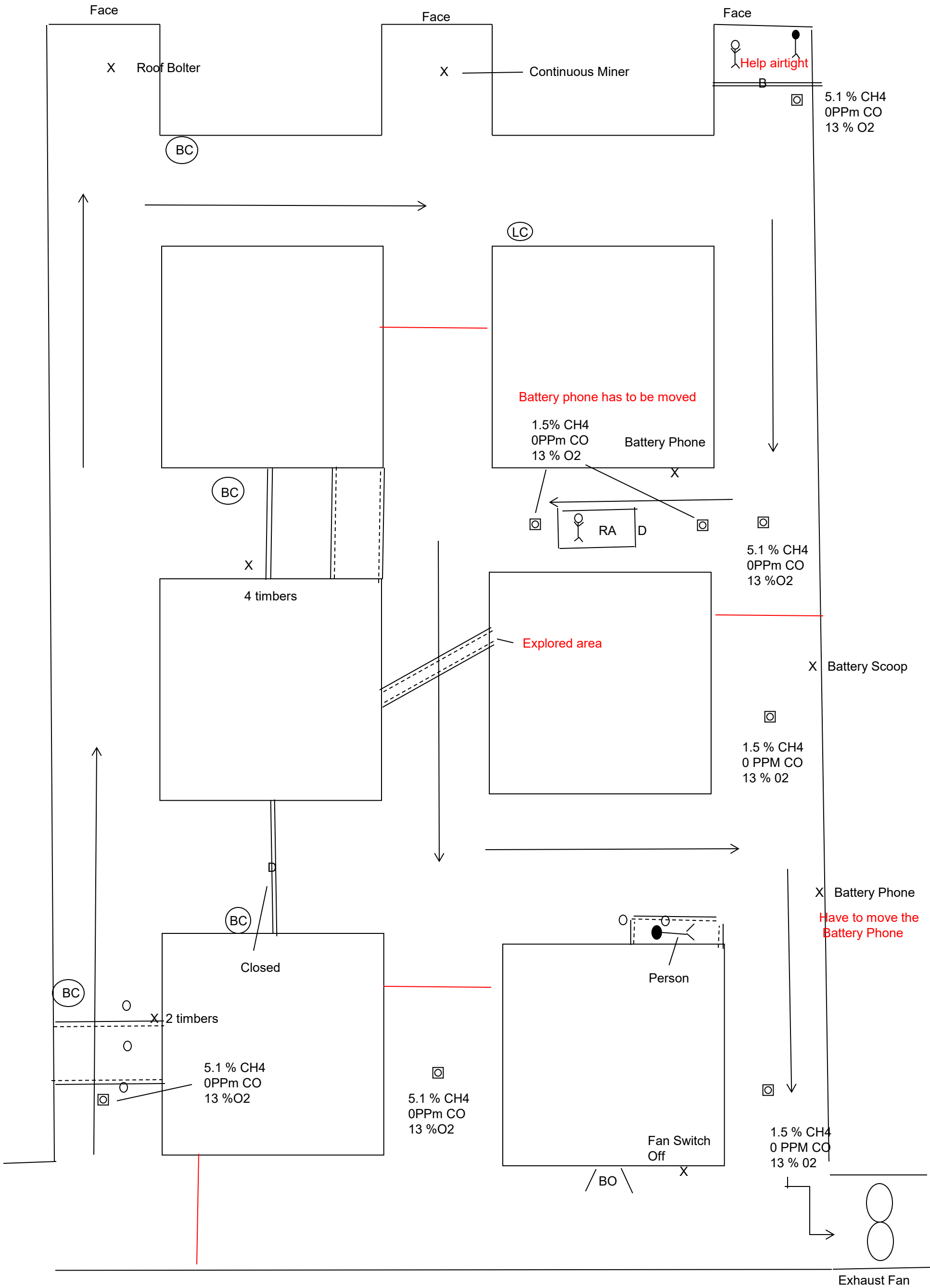

Face

X Roof Bolter

BC

Face

X Continuous Miner

Face

Help airtight

5.1 % CH4
0PPm CO
13 % O2

LC

Battery phone has to be moved

1.5% CH4
0PPm CO
13 % O2

Battery Phone

BC

RA D

5.1 % CH4
0PPm CO
13 % O2

X

4 timbers

Explored area

X Battery Scoop

1.5 % CH4
0 PPM CO
13 % O2

↑

↓

→

↓

BC

Closed

BC

X 2 timbers

5.1 % CH4
0PPm CO
13 % O2

5.1 % CH4
0PPm CO
13 % O2

Person

X Battery Phone
Have to move the
Battery Phone

Fan Switch
Off

1.5 % CH4
0 PPM CO
13 % O2

/BO\

X

Exhaust Fan

Optional 1st Vent

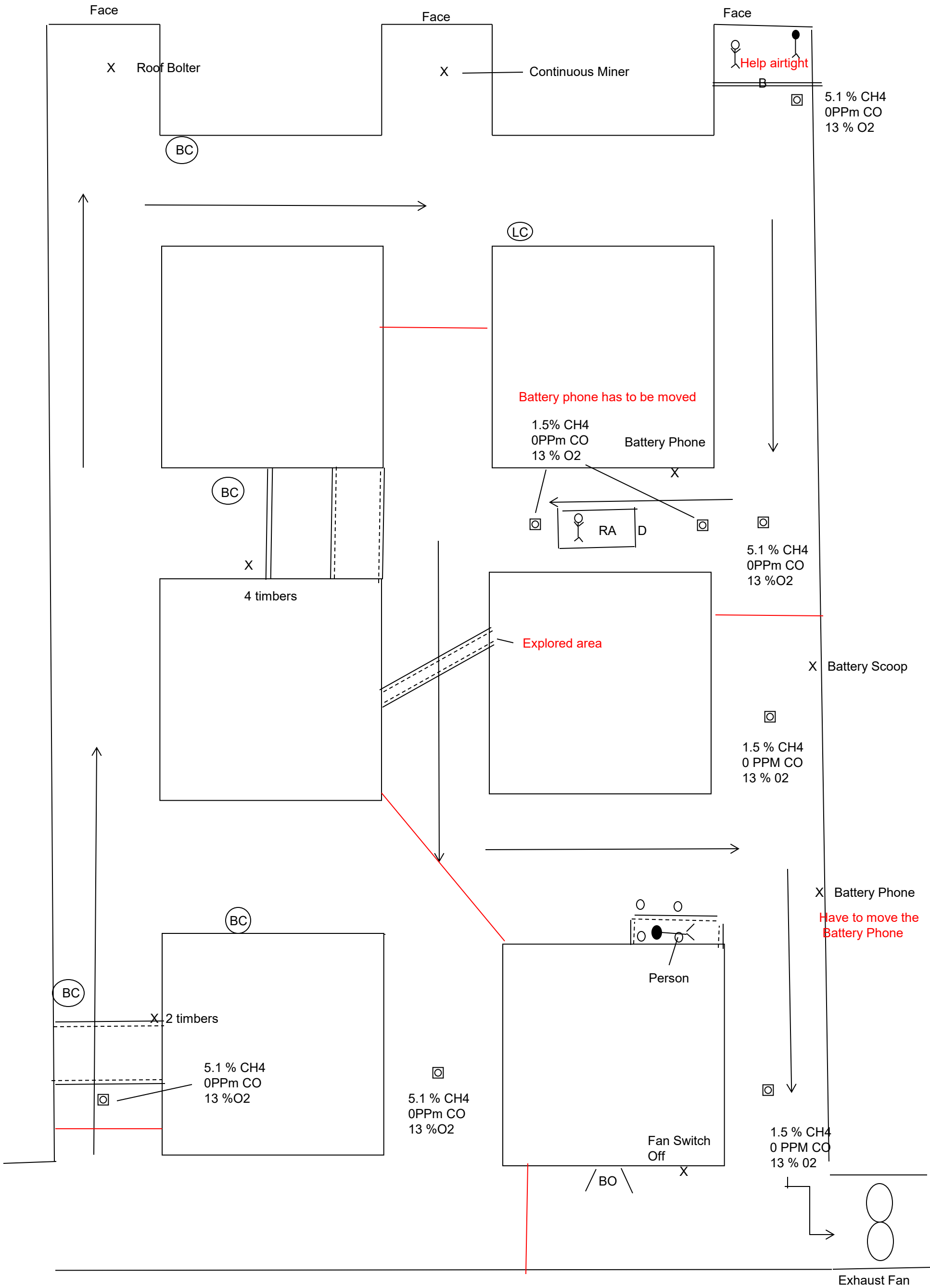

Second Vent

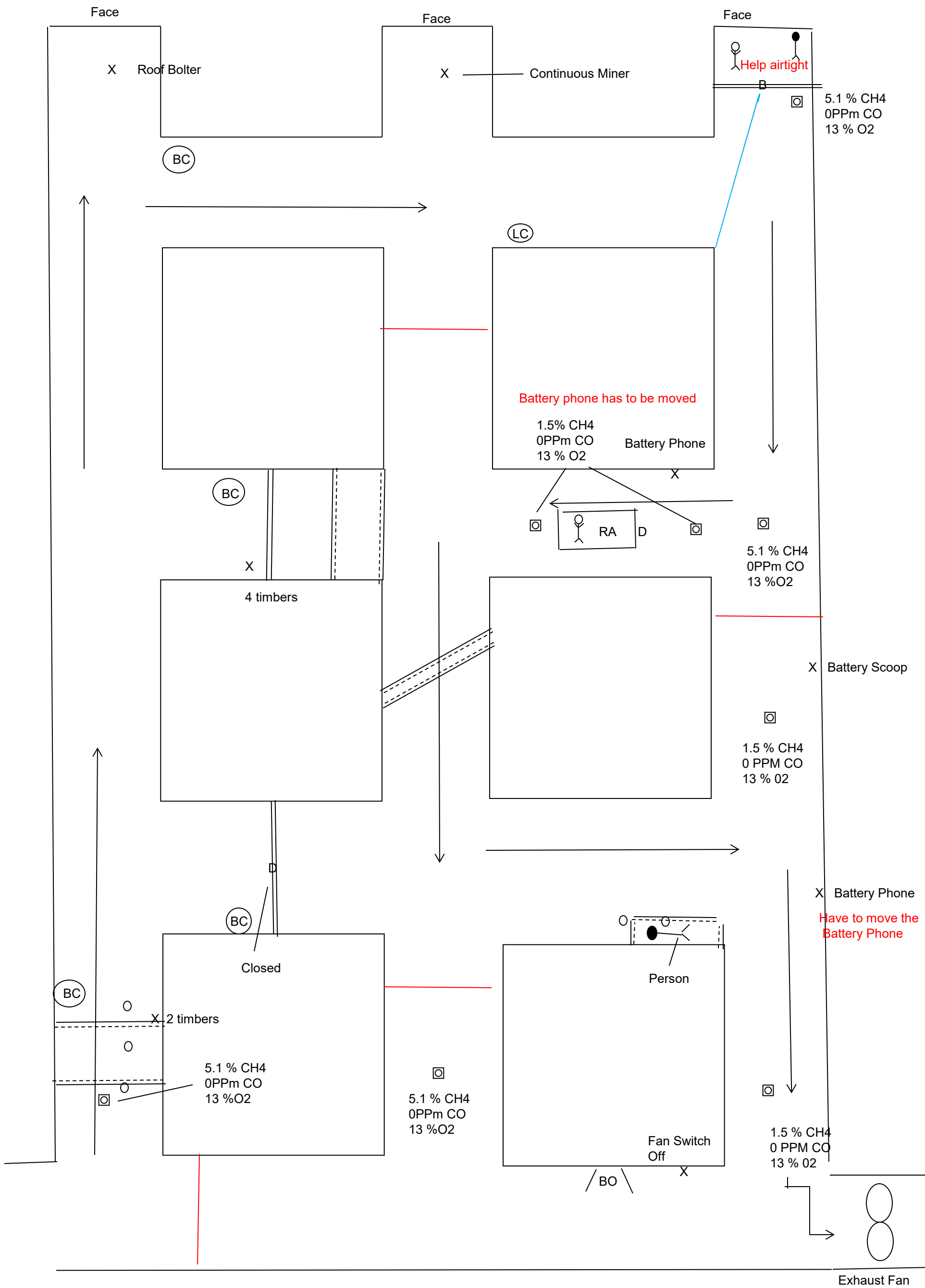

5.1 % CH4
0PPm CO
13 % O2

Battery phone has to be moved

1.5% CH4
0PPm CO
13 % O2

RA

5.1 % CH4
0PPm CO
13 % O2

X Battery Scoop

1.5 % CH4
0 PPM CO
13 % O2

X Battery Phone

Have to move the Battery Phone

Person

Fan Switch
Off

1.5 % CH4
0 PPM CO
13 % O2

Exhaust Fan

Optional 2nd Vent

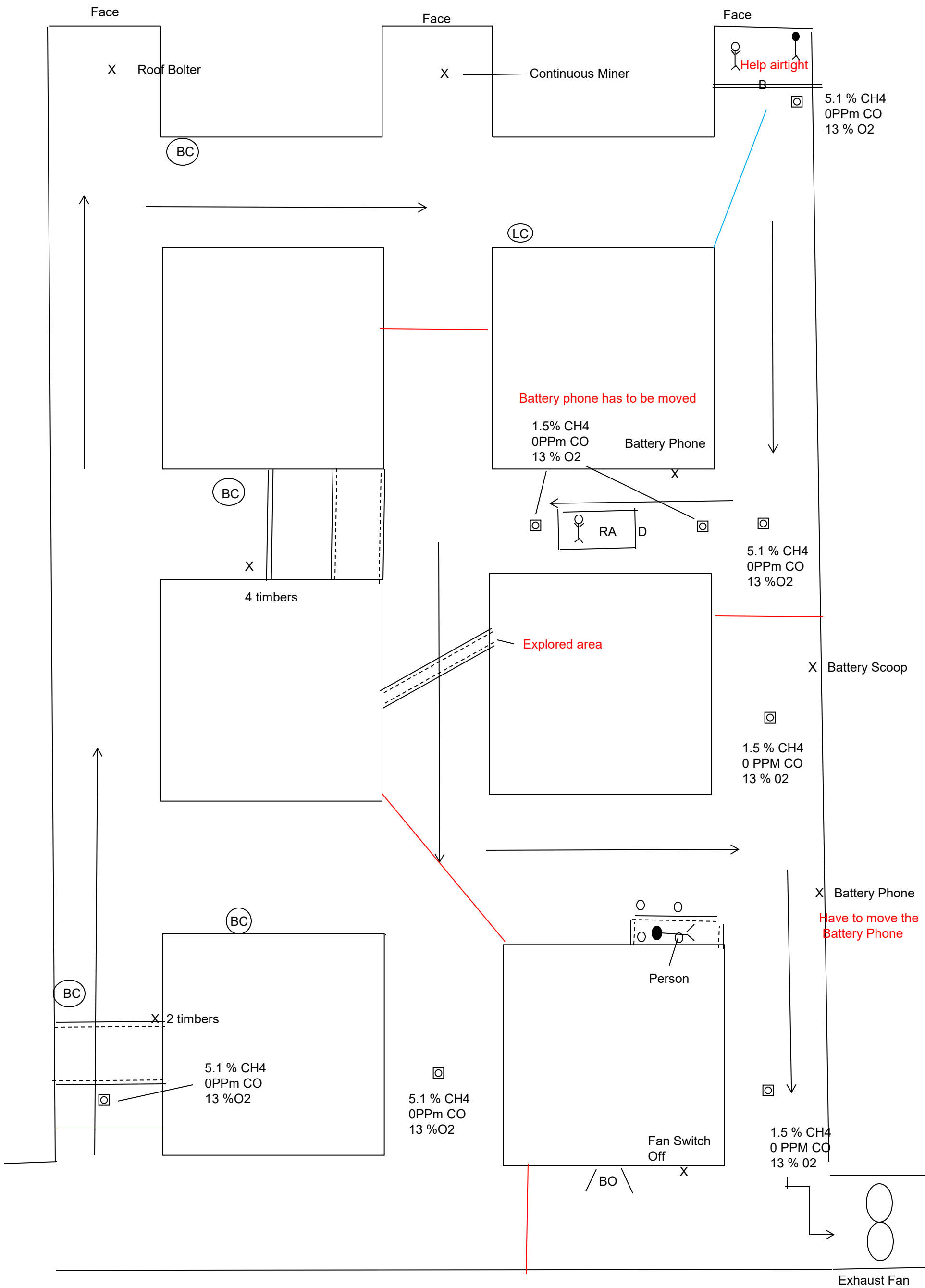

Face

Face

Face

X Roof Bolter

X Continuous Miner

Help airtight

BC

5.1 % CH4
0PPm CO
13 % O2

LC

Battery phone has to be moved

1.5% CH4
0PPm CO
13 % O2

Battery Phone

BC

RA

5.1 % CH4
0PPm CO
13 % O2

X

4 timbers

Explored area

X Battery Scoop

1.5 % CH4
0 PPM CO
13 % O2

BC

BC

X 2 timbers

5.1 % CH4
0PPm CO
13 % O2

5.1 % CH4
0PPm CO
13 % O2

Person

Fan Switch
Off

X Battery Phone
Have to move the
Battery Phone

1.5 % CH4
0 PPM CO
13 % O2

/BO\

Exhaust Fan

Face

Face

Briefing Officer

Face

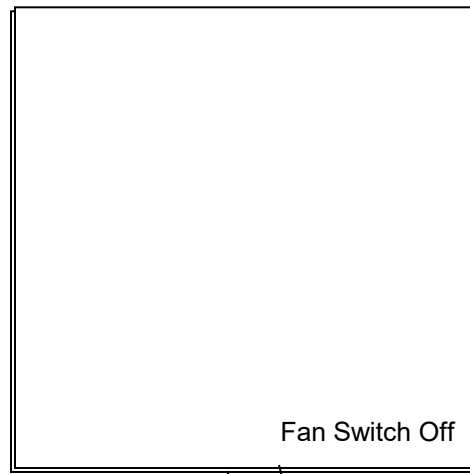
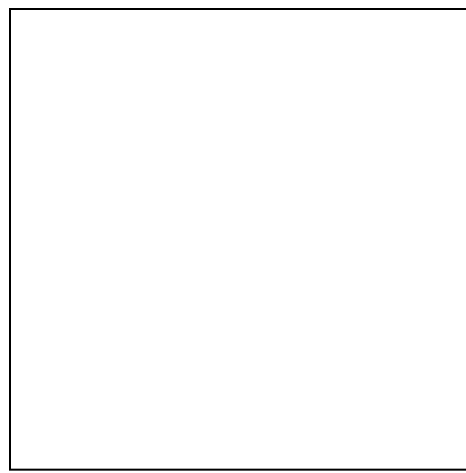
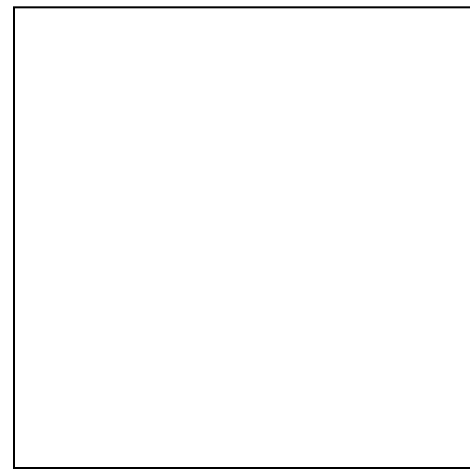
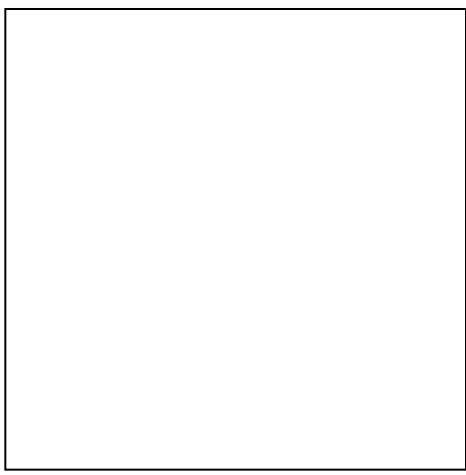
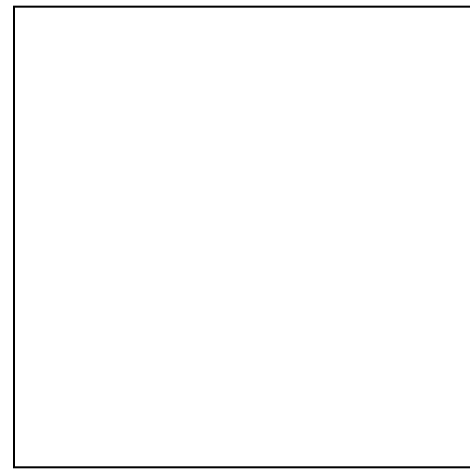
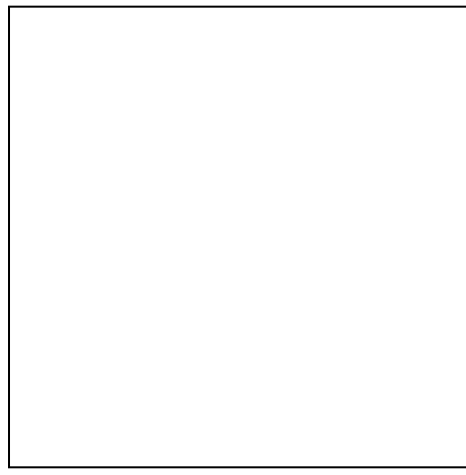

Fan Switch Off

/BO\"

X

Exhaust Fan



Face

Face

Team Map

Face

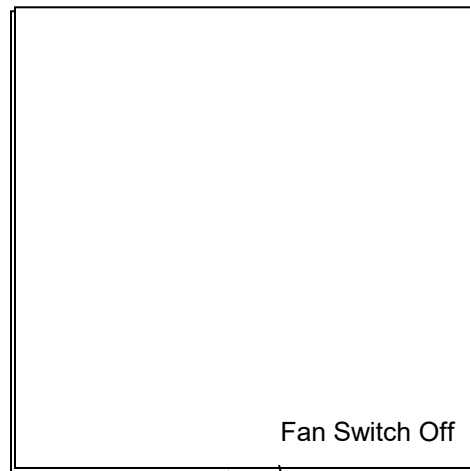
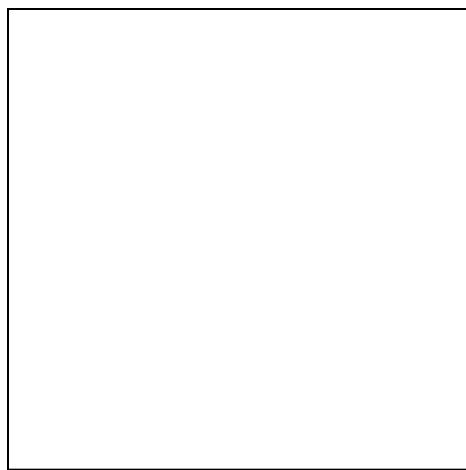
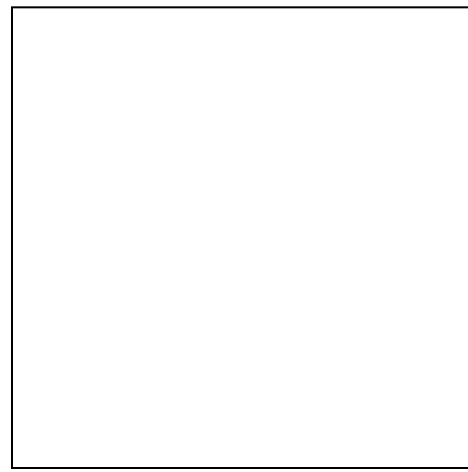
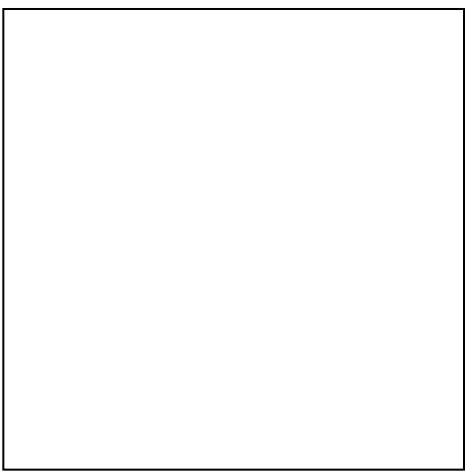
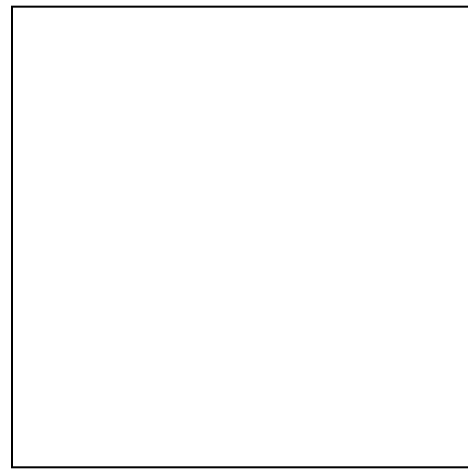
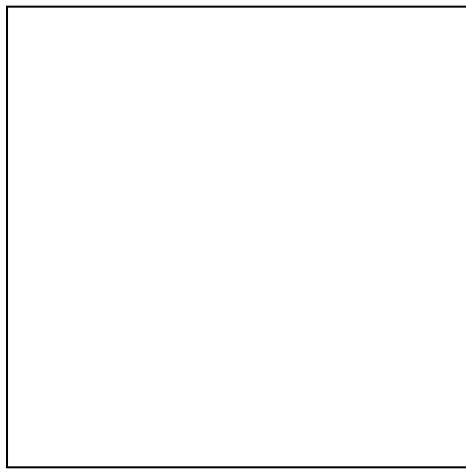

Fan Switch Off

/BO X

Exhaust Fan



Face

Face

Judges Map

Face

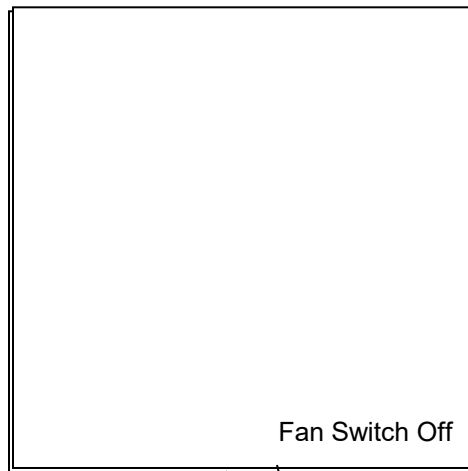
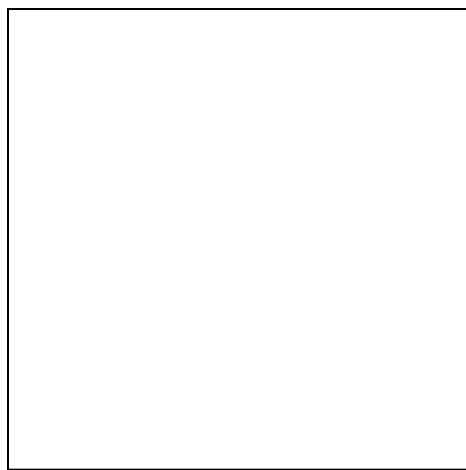
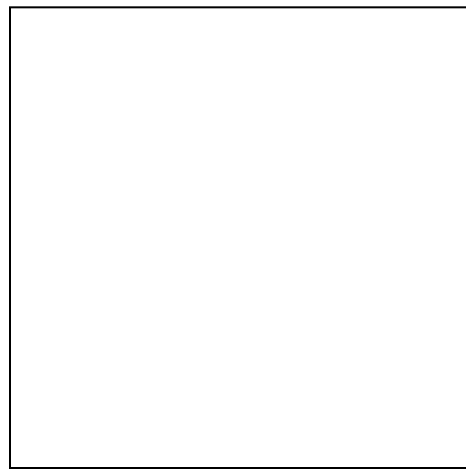
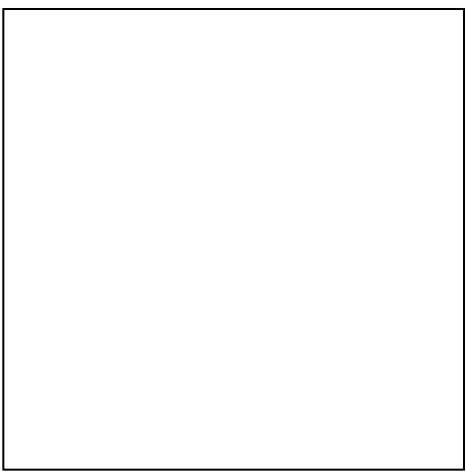
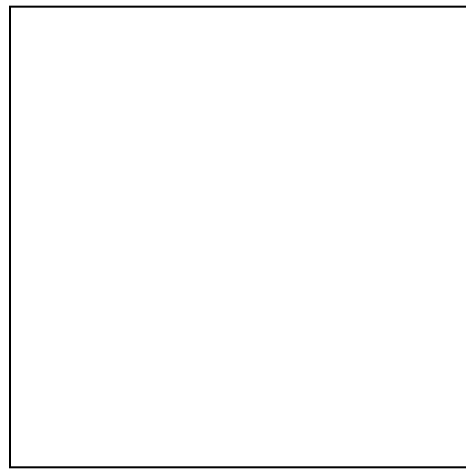
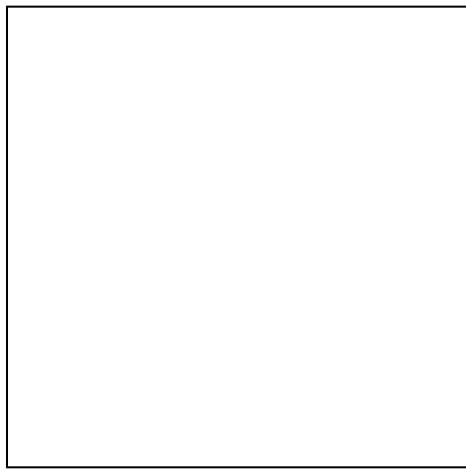

Fan Switch Off

/BO X

Exhaust Fan



Face

Face

Judges Map

Face

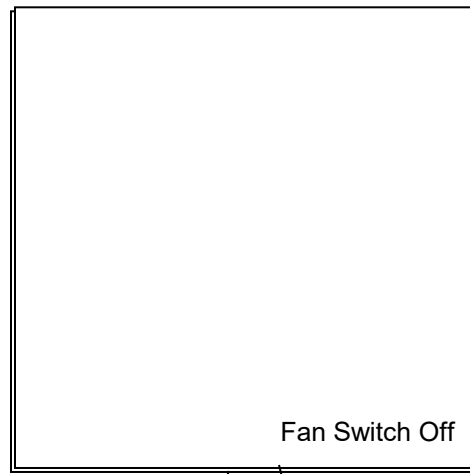
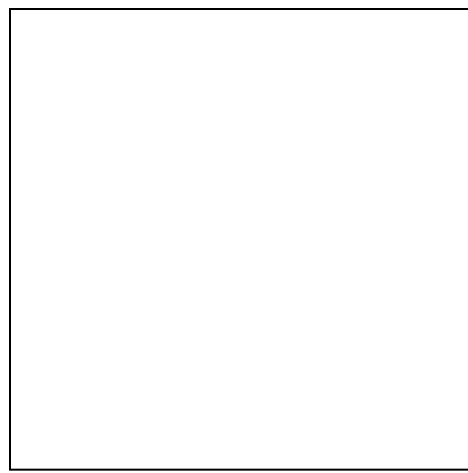
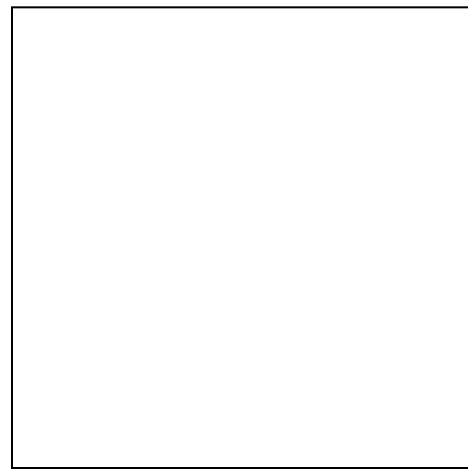
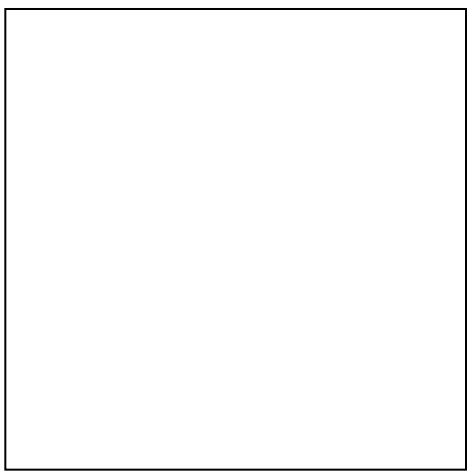
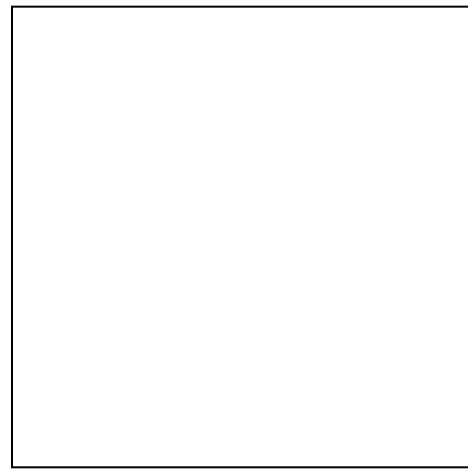
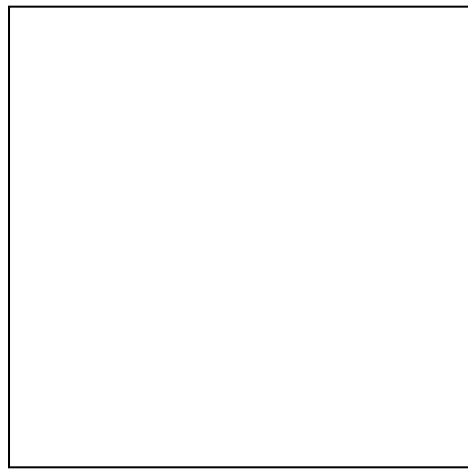

Fan Switch Off

/BO X

Exhaust Fan

