

DAY ONE

Statement

You are located on the surface of the Want-A-Be #1 mine. We've been in operation only ten days and we already have a problem. We produce coal on day shift, do maintenance on the evening shift, and are idle on the third shift. We normally knock the power and turn the fan off on the third shift.

At 6:00 am our five man crew went in to run coal. Around 7:30 am the ram car operator called outside and said the scoop brakes overheated and caught on fire. We then knocked all power on the mine. We have not heard from anyone since then, that's why we called you.

The mine has a history of bad top and some water. The blowing fan is off, but can be started at the fresh air base; it cannot be stopped or reversed. Normally, air goes up #3 and returns down #1 thru a stopping half built to regulate. The mine map is up to date.

All agencies have been notified and on site. You have a back-up team and first aid materials are available.

Good Luck!

PROBLEM

Explore the Entire Mine

Account for ALL Missing Miners and Bring Survivors to the Fresh Air Base

Entry Doors Located in #2 Can Not Be Relocated But Can Be Open and Closed as Needed.

Judges Information

Team must airlock in #2 at entry doors to enter the section to be explored.

During exploration team must follow contaminated entry or adjacent entry, especially in third crosscut in #1 when the smoke ends before reaching the next crosscut. Team must travel contaminated in #3.

Team must ventilate barricade in #3 prior to exploring the last open crosscut in #1 or it will be delay.

After removing patient in #3 barricade to the fresh air base, team must timber partial unsafe roof to reach person.

Team will have to explore last open crosscut in #1 to ventilate barricade in #2.

Southern West Virginia
 Mine Rescue Contest
 August 28, 2012
 Day 1

Team No. _____ Mine No. _____

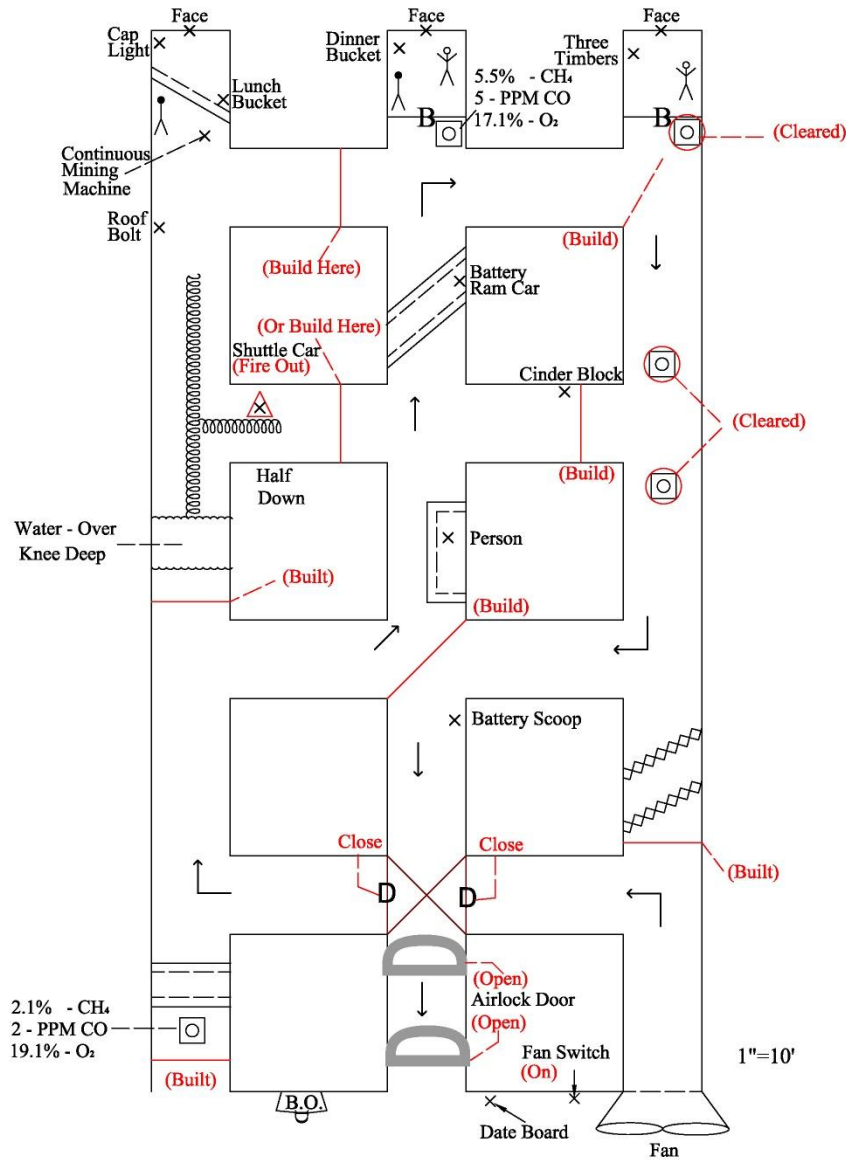

2nd Ventilation

Southern West Virginia
 Mine Rescue Contest
 August 28, 2012
 Day 1

Team No. _____ Mine No. _____

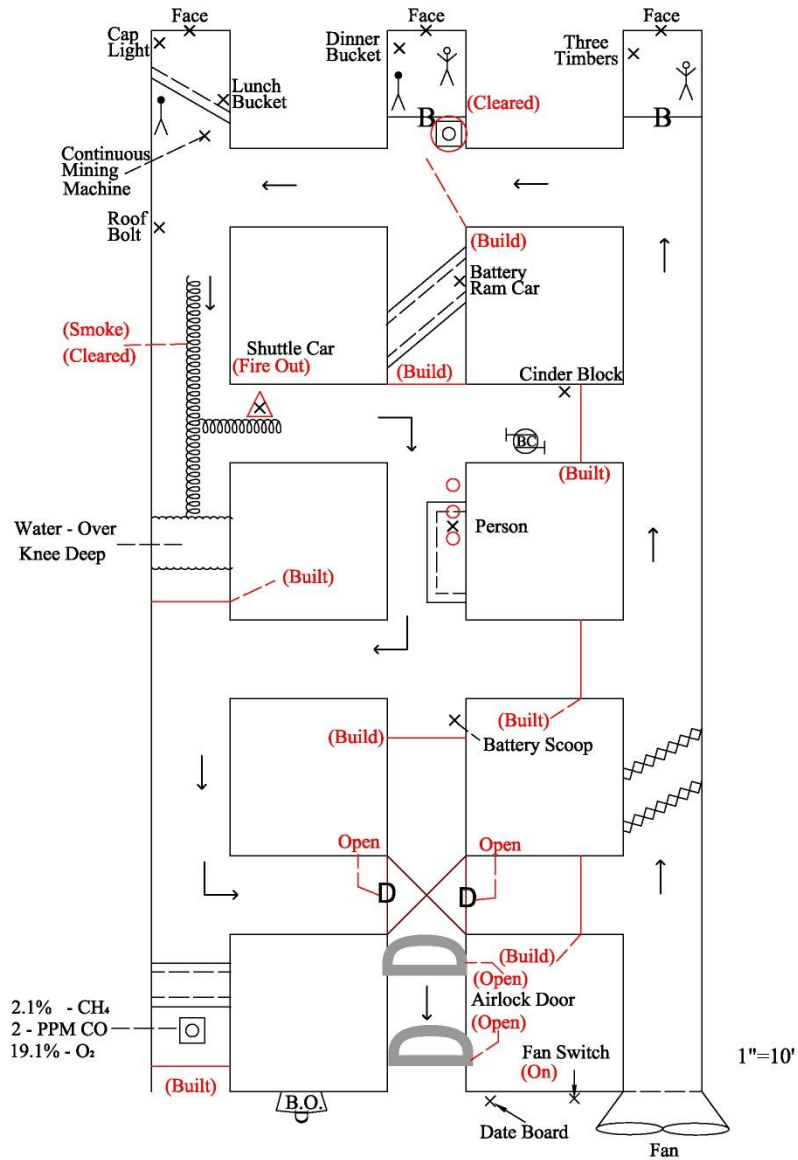

3rd Ventilation

2.1% - CH₄
 2 - PPM CO
 19.1% - O₂

Southern West Virginia
 Mine Rescue Contest
 August 28, 2012
 Day 1

Team No. _____ Mine No. _____

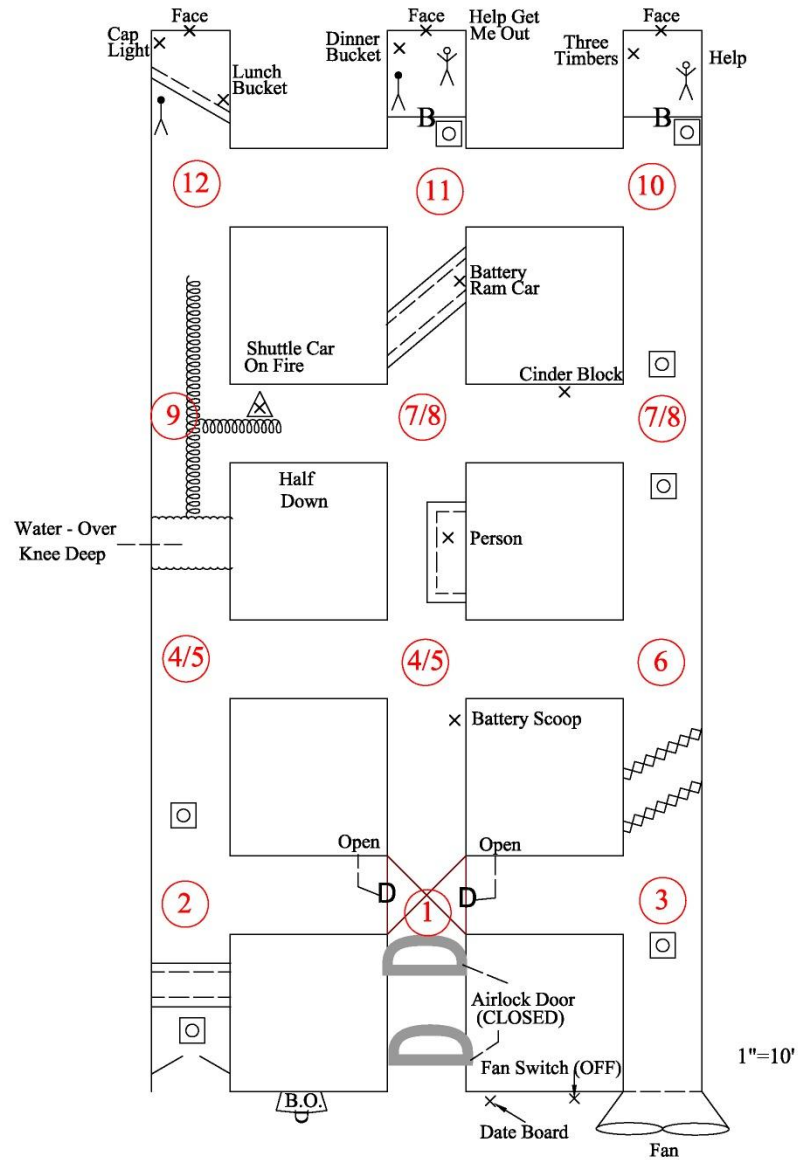

Team Stops

Southern West Virginia
 Mine Rescue Contest
 August 28, 2012
 Day 1

Team No. _____ Mine No. _____

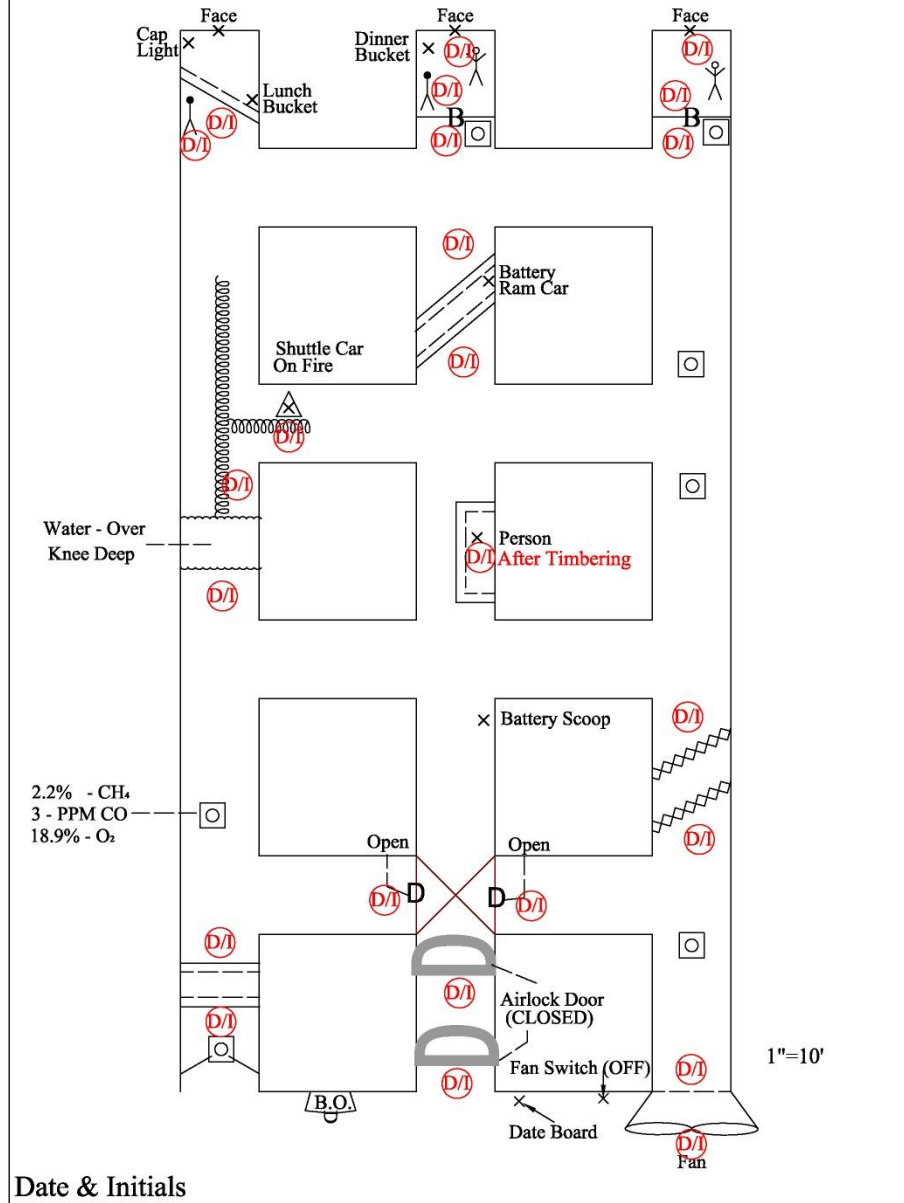

Southern West Virginia
Mine Rescue Contest
August 28, 2012
Day 1

Team No. _____ Mine No. _____

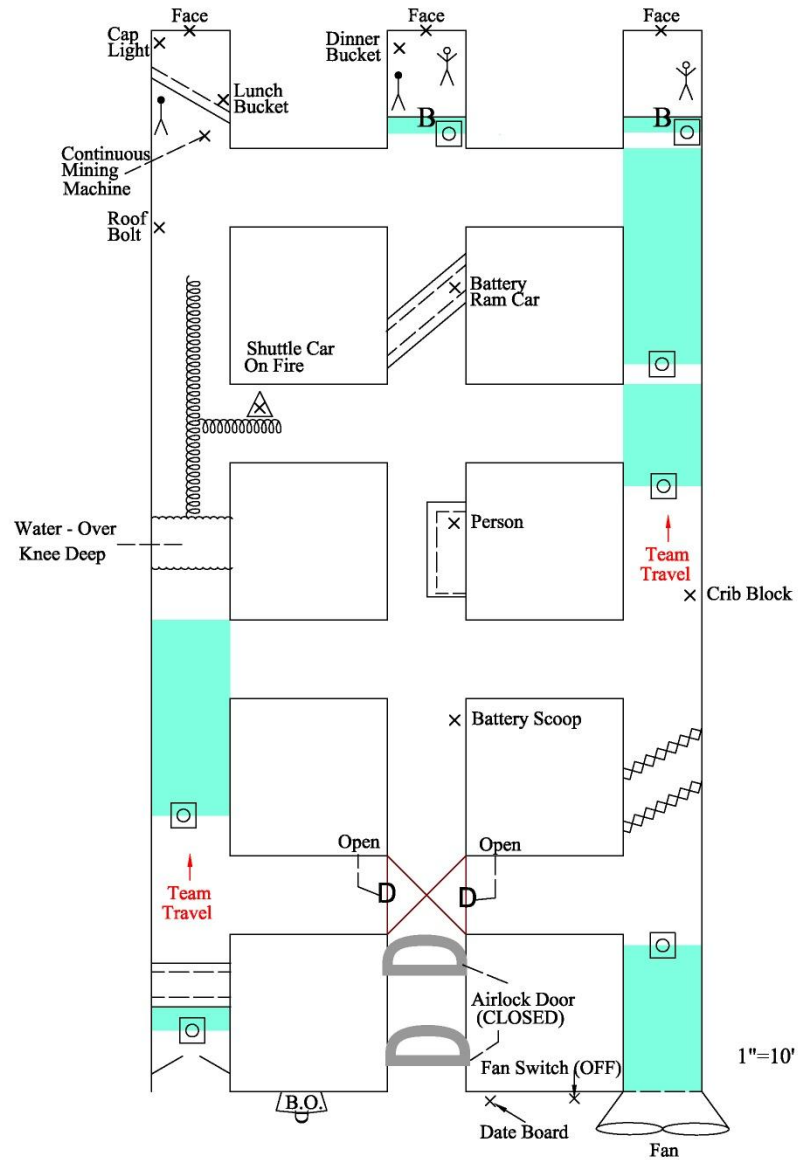

Extent Of Gases

Southern West Virginia
 Mine Rescue Contest
 August 28, 2012
 Day 1

Team No. _____ Mine No. _____

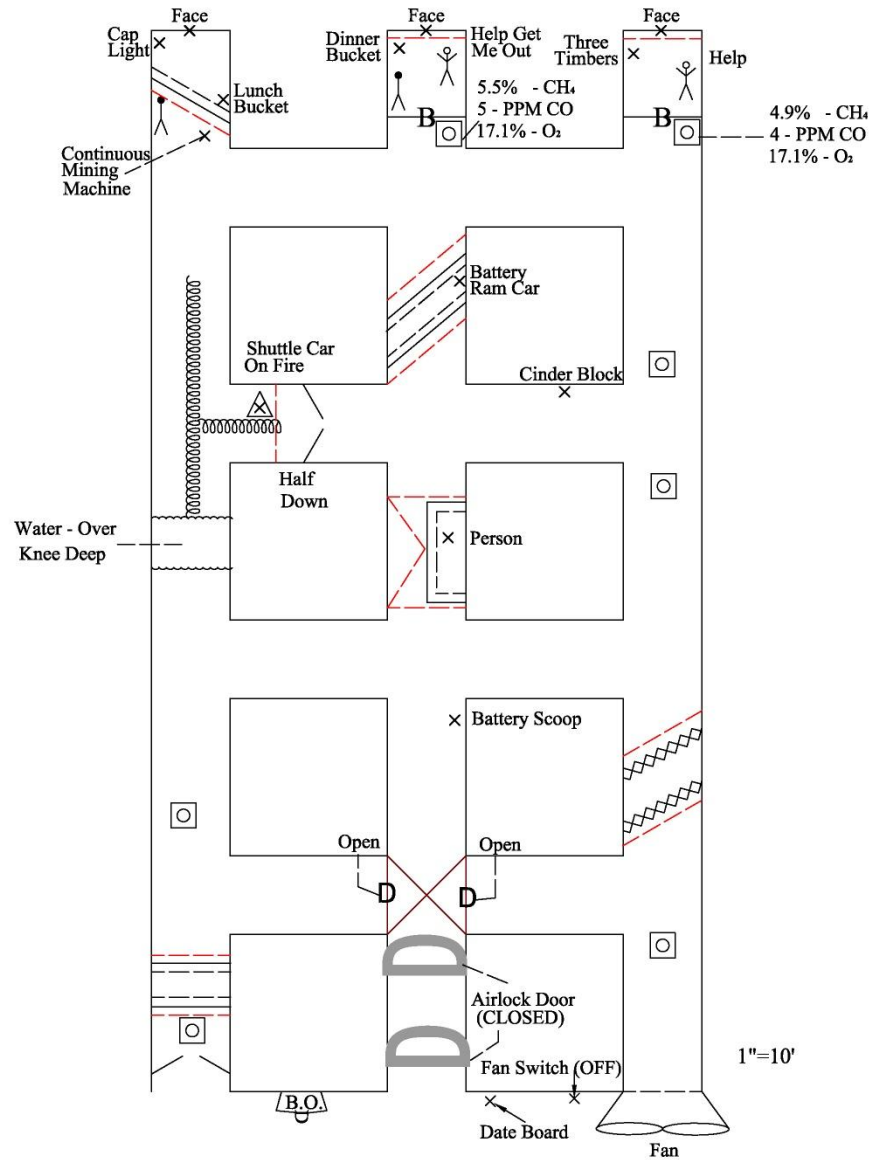

Roof & Rib Tests

Patient Statement
In Barricade #3 Entry

**HELP GET
ME OUT!!!!!!!!!!!!**

Patient Statement
In Barricade #2 Entry

**HELP GET
ME OUT!!!!!!!!!!!!**

It Is Airtight Behind Me

Southern West Virginia
Mine Rescue Contest
August 28, 2012
Day 1

Team No. _____ Mine No. _____

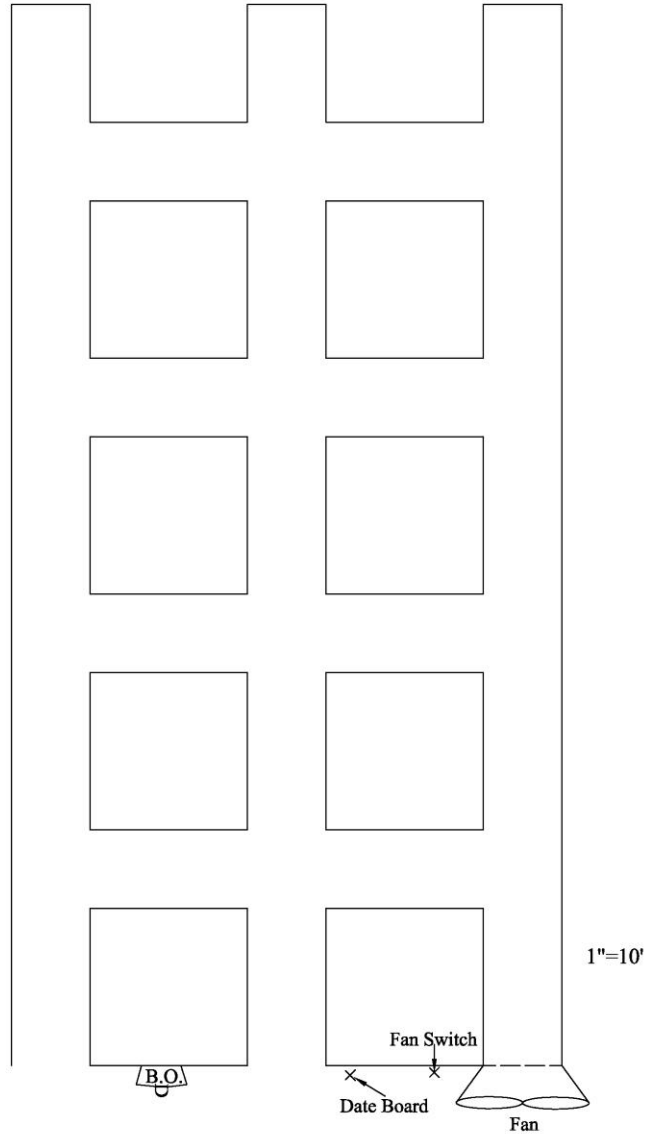

B.O. Map

Southern West Virginia
Mine Rescue Contest
August 28, 2012
Day 1

Team No. _____ Mine No. _____

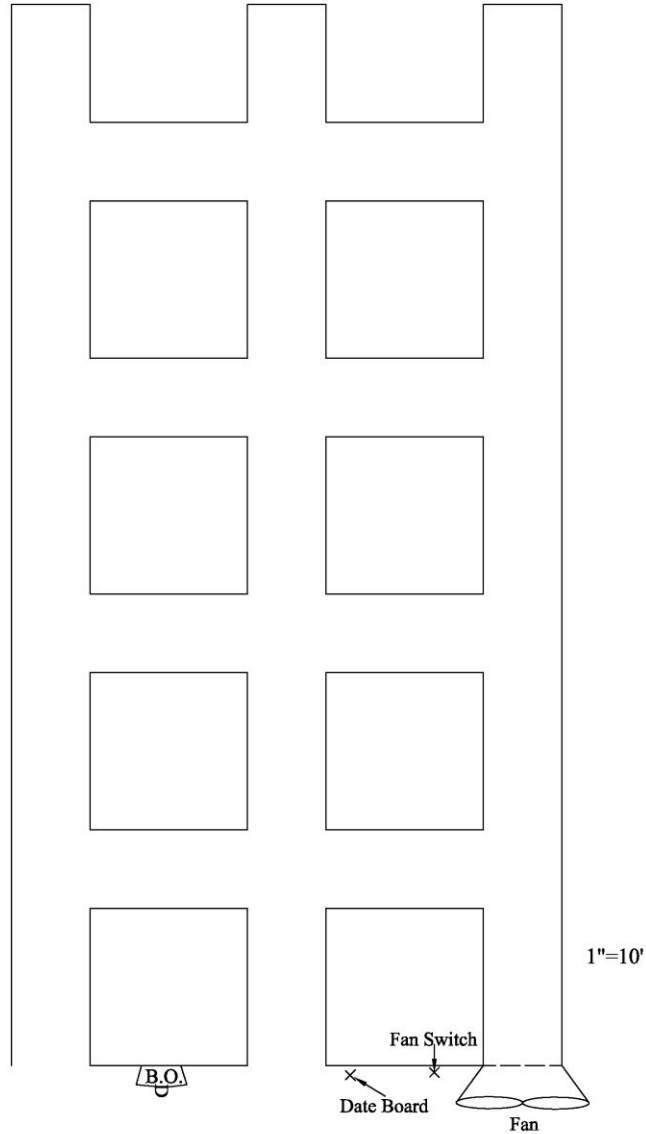

Team Map

Southern West Virginia
Mine Rescue Contest
August 28, 2012
Day 1

Team No. _____ Mine No. _____

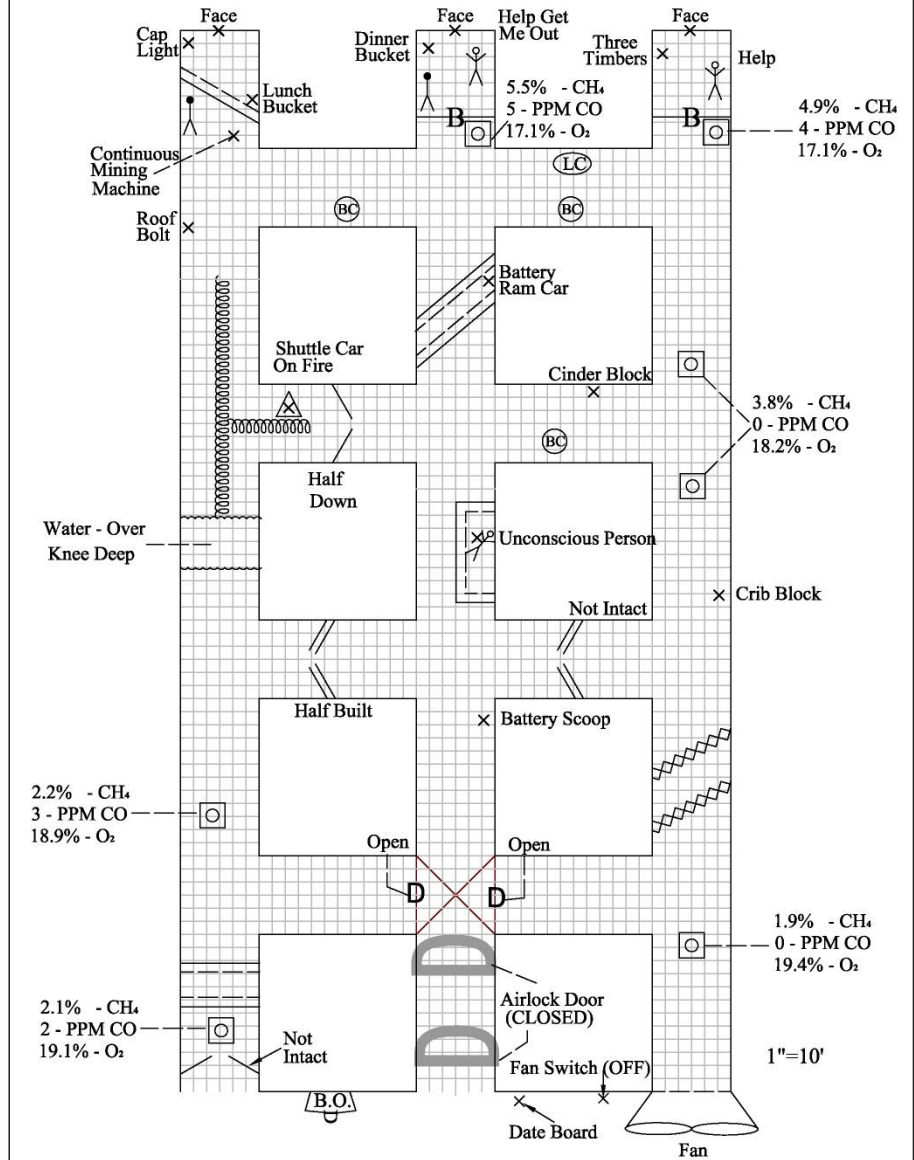

Layout Map